

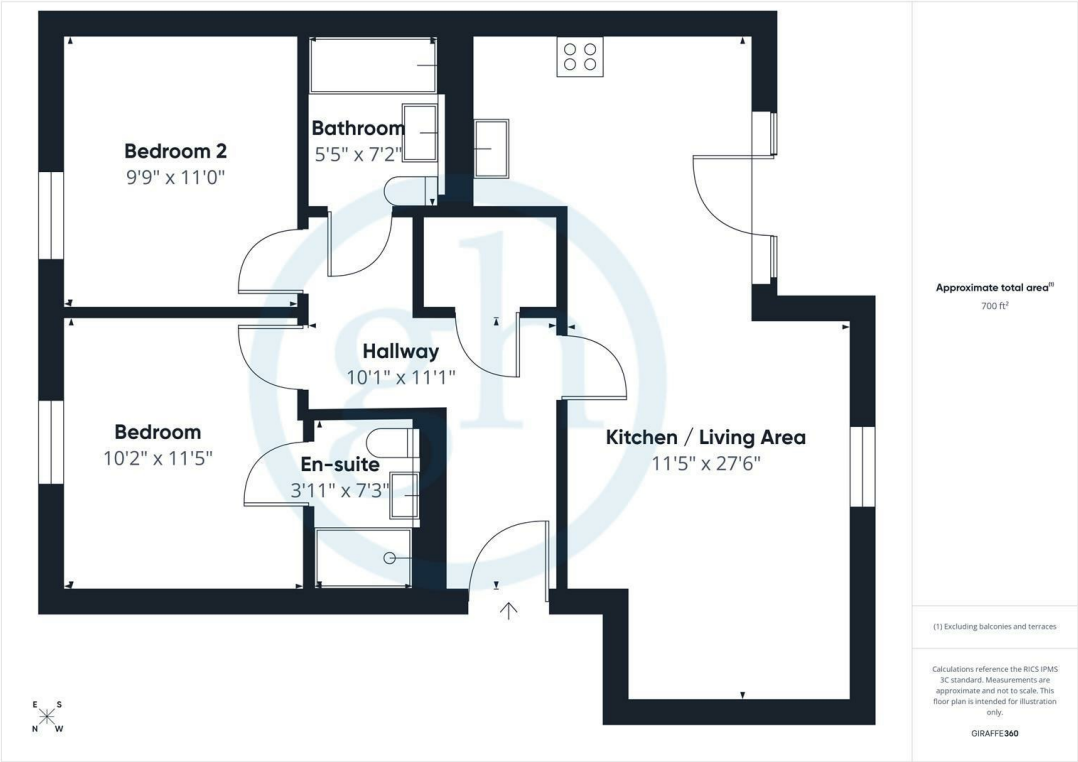

Arla Place, Ruislip, HA4 0GD  
£1,900



This beautifully presented two-bedroom, two-bathroom apartment offers generous, light-filled living space and is finished to an excellent standard throughout. Set within a modern development in the heart of South Ruislip, the property enjoys a prime location just moments from South Ruislip Station and a fantastic selection of nearby amenities including Asda, Cineworld, Starbucks, and The Gym Group. Positioned on the third floor, the apartment features contemporary interiors, a well-designed layout, and the added benefit of one allocated parking space. Ideal for professionals and commuters, the property provides excellent transport links via the Central Line and Chiltern Railways, offering swift and convenient access into Central London and surrounding areas.



Energy Efficiency Rating		
	Current	Potential
Very energy efficient - lower running costs		
(92 plus) <b>A</b>		
(81-91) <b>B</b>		
(69-80) <b>C</b>		
(55-68) <b>D</b>		
(39-54) <b>E</b>		
(21-38) <b>F</b>		
(1-20) <b>G</b>		
Not energy efficient - higher running costs		
<b>England &amp; Wales</b>	EU Directive 2002/91/EC	

You may download, store and use the material for your own personal use and research. You may not republish, retransmit, redistribute or otherwise make the material available to any party or make the same available on any website. These particulars, whilst believed to be accurate are set out as a general outline only for guidance and do not constitute any part of an offer or contract. Intending purchasers should not rely on them as statements or representation of fact, but must satisfy themselves by inspection or otherwise as to their accuracy. No person in this firms employment has the authority to make or give any representation or warranty in respect of the property.