

SNELLERS

ESTATE AGENTS



Portsmouth Road, KT6

£375,000

Offered with no onward chain is this well presented two bedroom ground floor apartment. The property offers bright, spacious accommodation, a modern kitchen and bathroom, as well as residents' parking. Further benefits include a share of the freehold and no onward chain, making this a great first time buy or investment.

Chatsworth House is ideally located on Portsmouth Road, within easy reach of Surbiton town centre and mainline station, offering fast links into London Waterloo. The River Thames, local shops, cafes and restaurants are all nearby.

- Two Bedrooms • Ground Floor Apartment • Great Condition •
- Share Of Freehold • Residents Parking • No Onward Chain •

SNELLERS

ESTATE AGENTS

Ground Floor

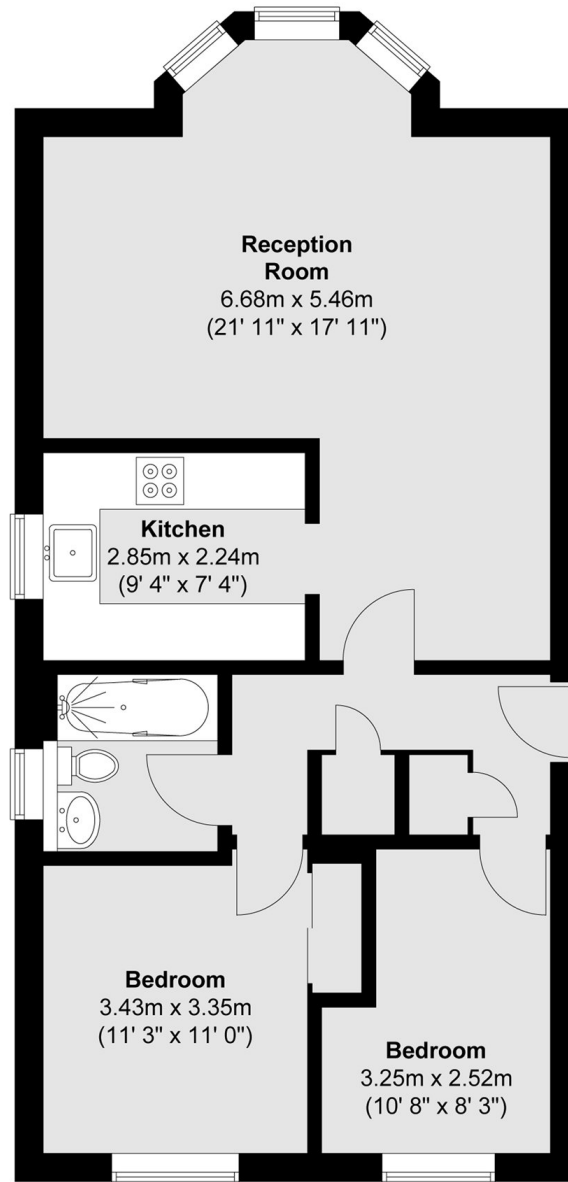

Total area (approx.) : 62.2 sq. m (669 sq. ft)

Snellers Kingston Sales
17-21 Richmond Road
Kingston
KT2 5BW
020 8546 8715
kingstonsales@snellers.co.uk

Energy Rating: E We aim to make our particulars both accurate and reliable. However they are not guaranteed; nor do they form part of an offer or contract. If you require clarification on any points then please contact us, especially if you're traveling some distance to view. Please note that appliances and heating systems have not been tested and therefore no warranties can be given as to their good working order