



## MERRYWEATHER PLACE, SE10

**£400,000**

A one bedroom, one bathroom top floor apartment, Expanding to 549 sq ft ( approx.). The property offers both stylish and spacious living accommodation, to include a bright open-plan living/dining and kitchen area which benefits from granite worktops and quality integrated appliance with fantastic views overlooking Canary Wharf and the City.

- 24 HR Concierge
- Service Charge: £350
- Underground Parking
- Ground Rent: £3,867

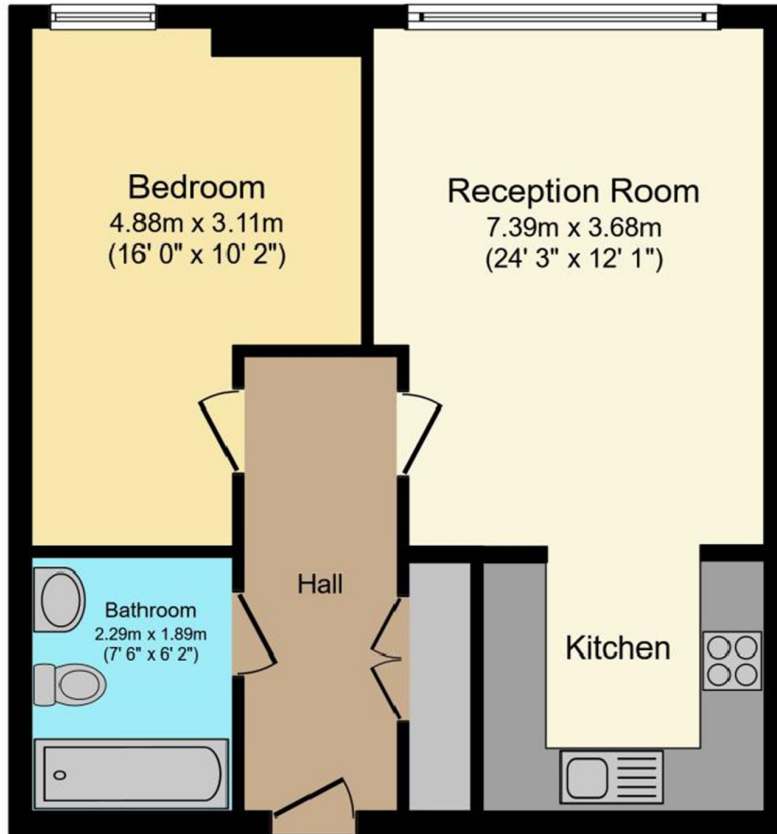

**Floor Plan**

Total floor area 51.0 sq. m. (549 sq. ft.) approx

This floor plan is for illustrative purposes only. It is not drawn to scale. Any measurements, floor areas (including any total floor area), openings and orientation are approximate. No details are guaranteed, they cannot be relied upon for any purpose and they do not form part of any agreement. No liability is taken for any error, omission or misstatement. A party must rely upon its own inspection(s). Plan produced for Purple Bricks. Powered by [www.focalagent.com](http://www.focalagent.com)

**LiFE RESIDENTIAL**

6 Victoria Parade, London,  
SE10 9FR  
Sales: 020 8446 2521  
Lettings: 020 8418 3609

Energy Rating: . We aim to make our particulars both accurate and reliable. However they are not guaranteed; nor do they form part of an offer or contract. If you require clarification on any points then please contact us, especially if you're traveling some distance to view. Please note that appliances and heating systems have not been tested and therefore no warranties can be given as to their good working order.