



36 Alcindor Mansions 16 Paddington Green, London, W2 1ER
£575 Per Week



36 Alcindor Mansions 16 Paddington Green, London, W2 1ER

£575 Per Week

Nestled in the heart of London, 16 Paddington Green presents a unique opportunity for those seeking a flat in a vibrant and bustling area. This property is ideally situated, offering easy access to a wealth of local amenities, including shops, restaurants, and parks, making it perfect for both professionals and families alike.

While the flat's specific dimensions are not provided, the location itself is a significant draw. Paddington Green is known for its excellent transport links, with Paddington Station just a short walk away, providing swift connections to the rest of London and beyond. The area is also rich in cultural attractions, ensuring that residents can enjoy a lively lifestyle filled with entertainment and leisure options.

This flat offers the chance to create a personalised living space in one of London's most sought-after neighbourhoods. Whether you are looking to invest or find a new home, 16 Paddington Green is a property that promises convenience and a vibrant community atmosphere.

Description



Situation



Furnished
Council Tax Band:
Available: 16th June 2026

Floor Plans

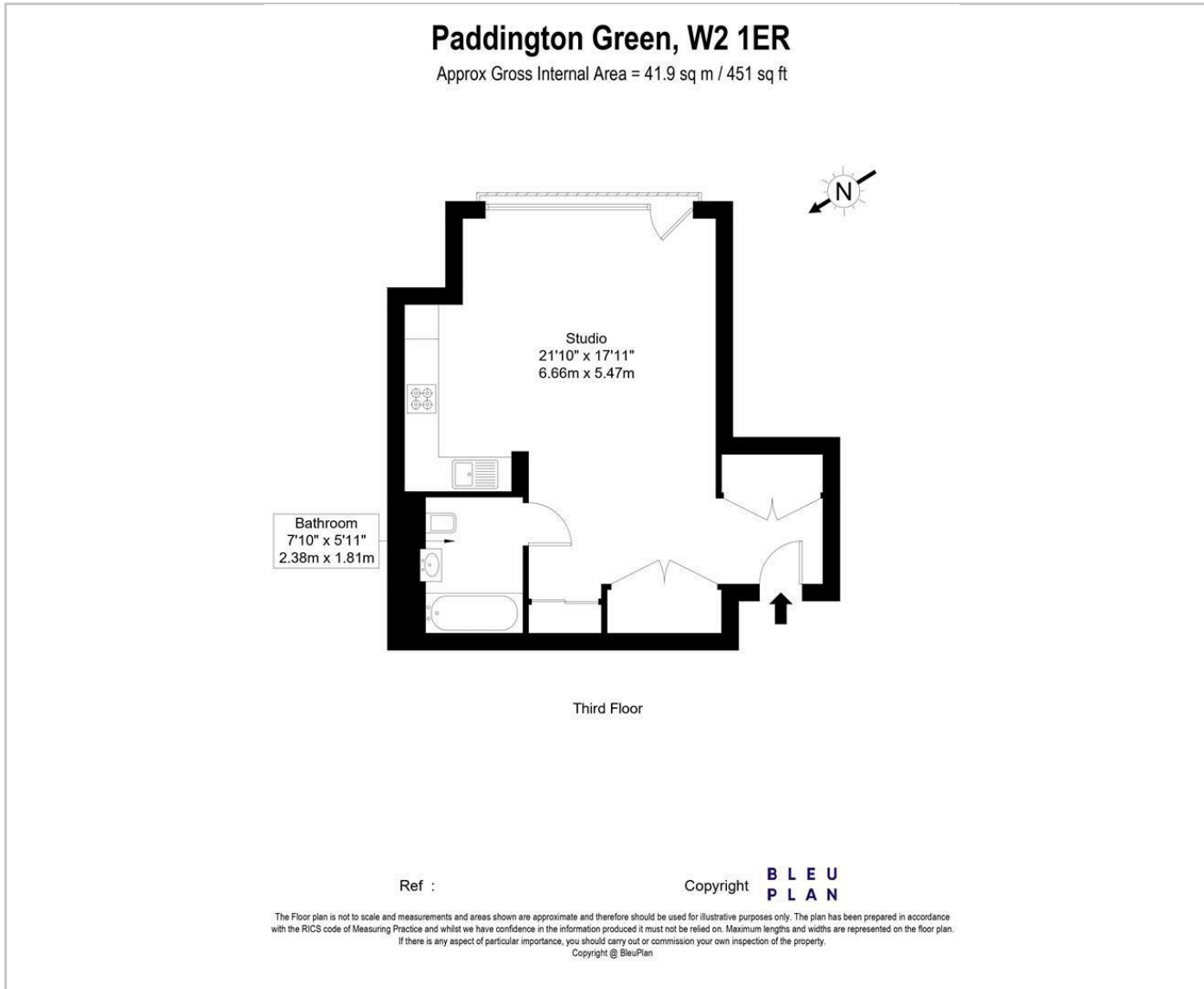

Area Map

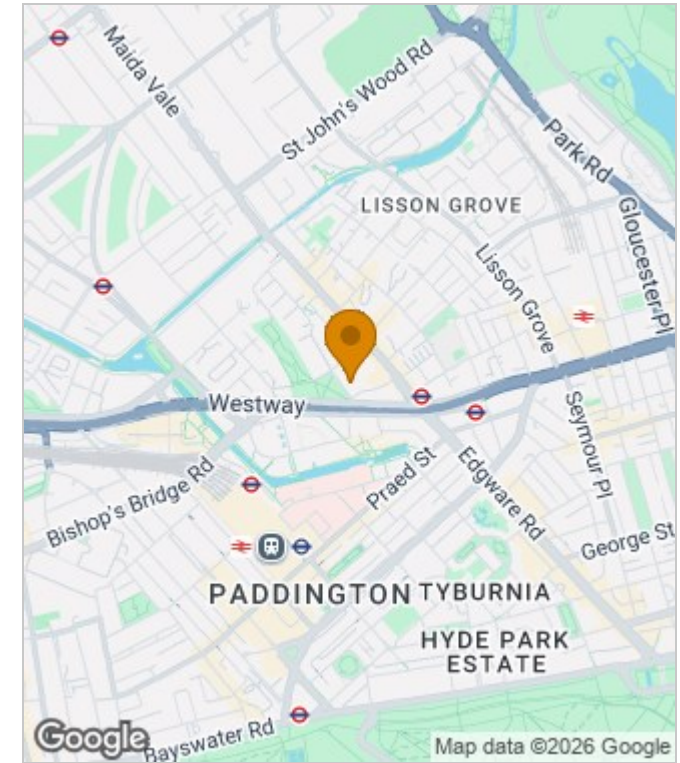

Energy Performance Graph

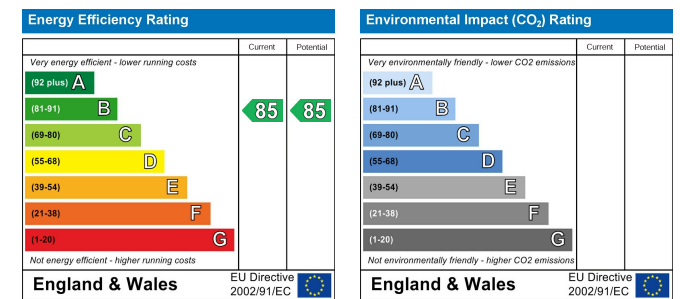

These particulars, whilst believed to be accurate are set out as a general outline only for guidance and do not constitute any part of an offer or contract. Intending purchasers should not rely on them as statements of representation of fact, but must satisfy themselves by inspection or otherwise as to their accuracy. No person in this firm's employment has the authority to make or give any representation or warranty in respect of the property.