



6 Liederbach Drive, Verwood, BH31 6GH

£525,000



6 Liederbach Drive, Verwood, BH31 6GH

£525,000

Located within a quiet and highly regarded residential area, this beautifully presented five bedroom detached family home offers generous, well proportioned accommodation ideal for modern day living.

Set back from the road behind a landscaped front garden, the property benefits from ample off road parking and an integrated garage. A welcoming entrance hall leads through to a range of bright and spacious living areas finished to a high standard throughout.

The heart of the home is the impressive kitchen breakfast room, fitted with classic Manhattan wooden units, rolled edge worktops, a Neff gas hob and integrated double oven, with space for a dishwasher and fridge freezer. The adjoining utility room provides additional storage, sink, and plumbing for a washing machine and tumble dryer, with access to the garage and rear garden.

To the rear, the dining room opens via French doors onto a sunny south facing garden, while the generous lounge offers a comfortable living space. A downstairs WC adds convenience, and an L shaped conservatory provides a bright, versatile additional reception room.

Upstairs, there are five well sized bedrooms. The main bedroom benefits from a modern en suite, bedroom two offers flexible dorm style living, bedrooms three and four include built in wardrobes, and bedroom five is ideal as a nursery, study or guest room. A family bathroom completes the first floor.

Description



Situation



null
Council Tax Band: F
Available:

Floor Plans

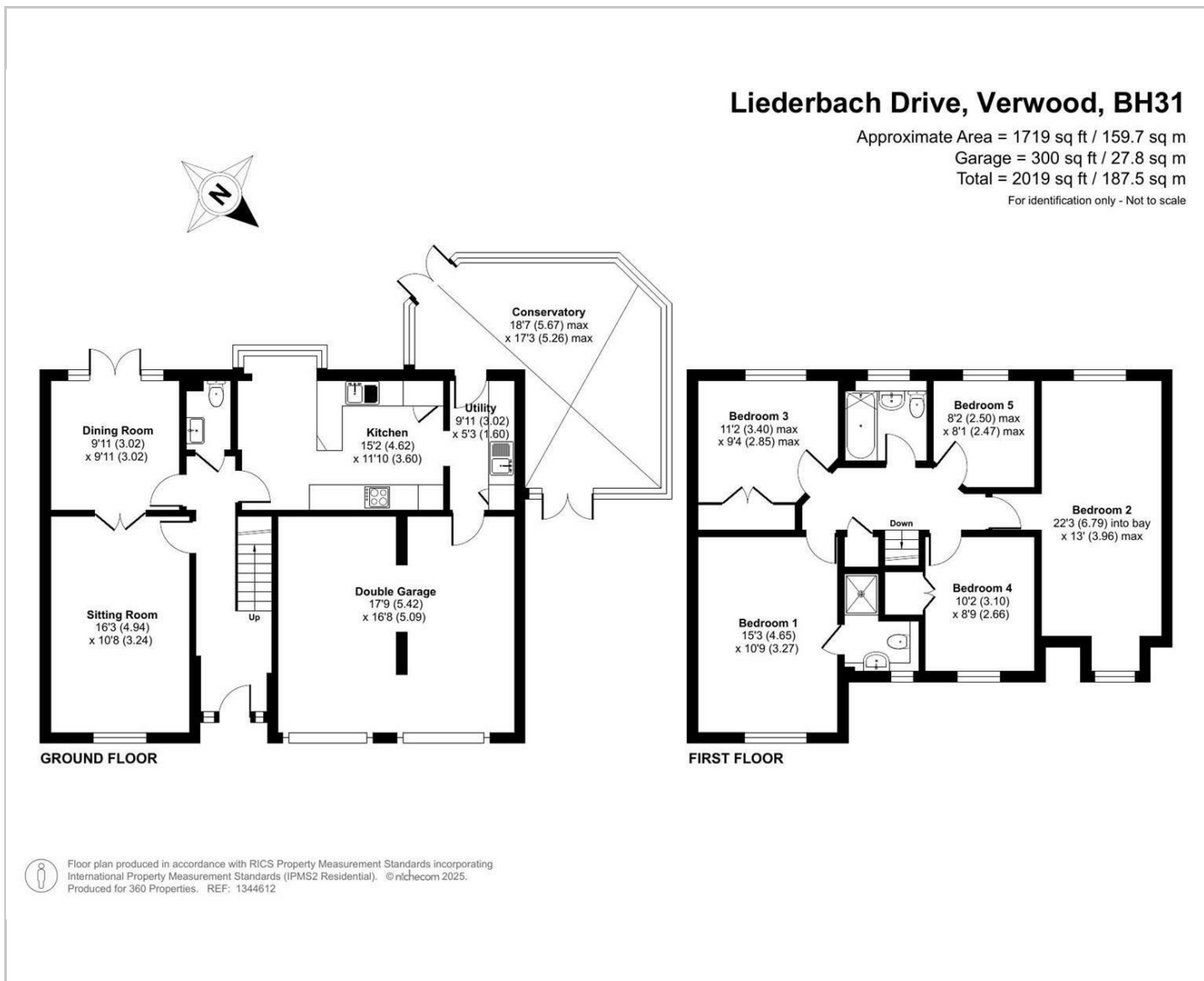

Area Map

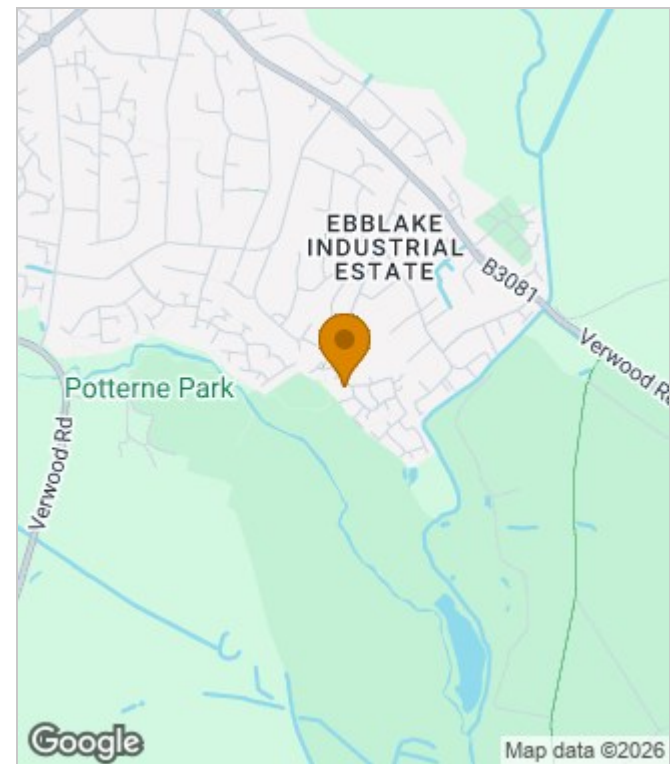

Energy Performance Graph

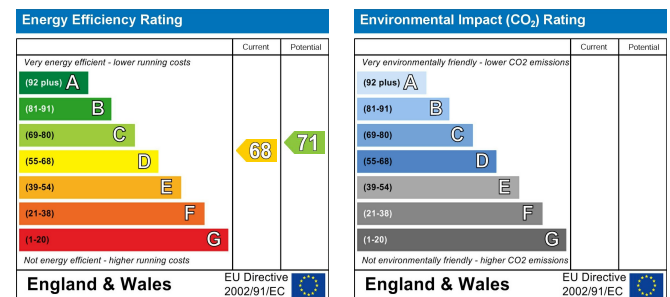

These particulars, whilst believed to be accurate are set out as a general outline only for guidance and do not constitute any part of an offer or contract. Intending purchasers should not rely on them as statements of representation of fact, but must satisfy themselves by inspection or otherwise as to their accuracy. No person in this firm's employment has the authority to make or give any representation or warranty in respect of the property.

Unit 1, 28 Blackmoor Rd, Verwood, BH31 6BB
Tel: 01202 177288 Email: info@castlemanestateagents.co.uk