



**25 Studholme Avenue, Penwortham, PR1 9PA**

**Offers over £227,500**

Situated on a quiet road in Penwortham, this beautifully presented 3-bedroom semi-detached home offers stylish and comfortable living, perfect for families or first-time buyers.

In excellent condition throughout, the property features a bright front lounge and an open-plan kitchen with dining space, ideal for modern living. Outside you'll find a detached garden room and a well-maintained garden. Upstairs boasts two generous double bedrooms and a spacious third bedroom, all served by a modern 3 piece bathroom.

With its peaceful location, flexible layout, and excellent presentation, this home is ready to move into. If you have any questions or would like to arrange a viewing, please get in touch.

# Floor Plan

Ground Floor

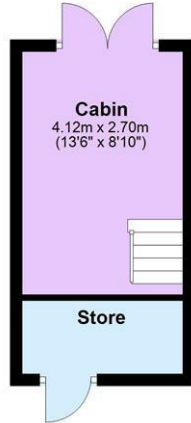

First Floor

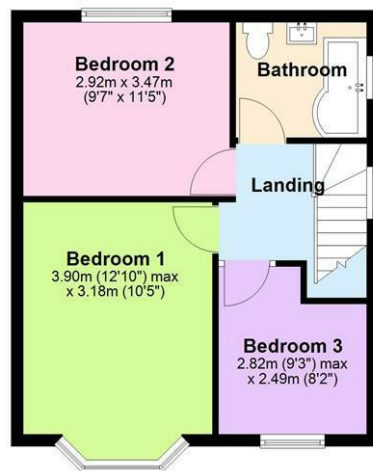
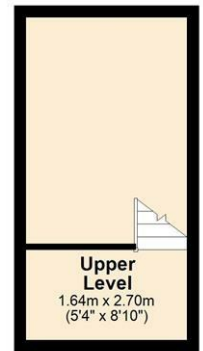

## Area Map

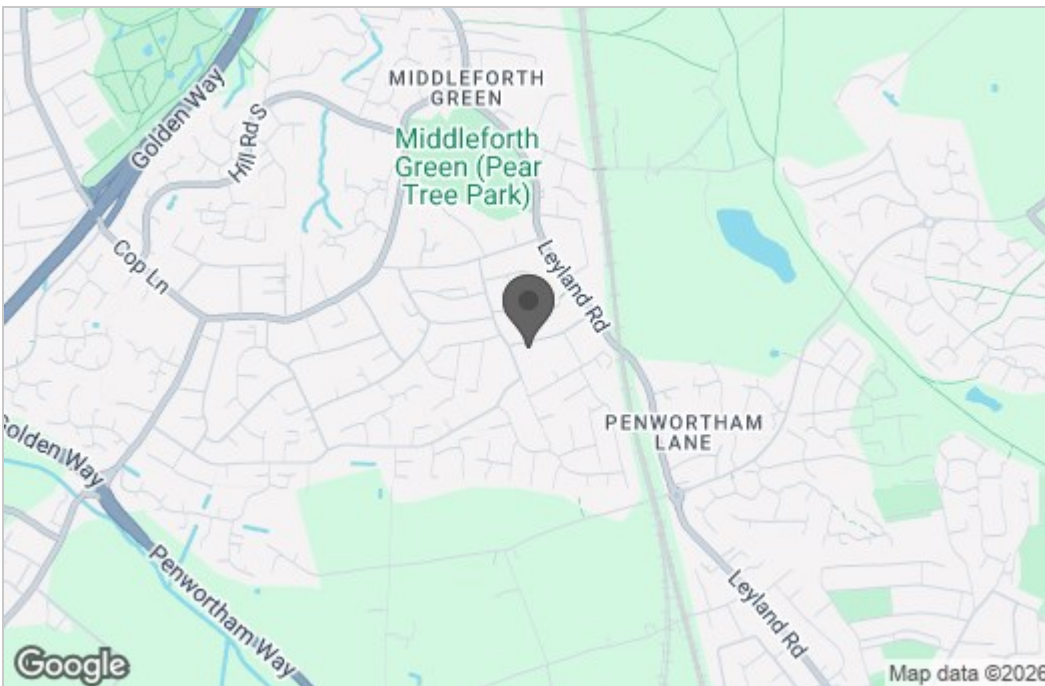

## Energy Efficiency Graph

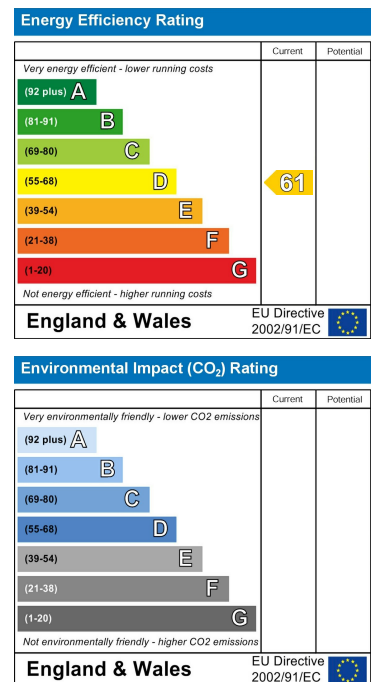

These particulars, whilst believed to be accurate are set out as a general outline only for guidance and do not constitute any part of an offer or contract. Intending purchasers should not rely on them as statements of representation of fact, but must satisfy themselves by inspection or otherwise as to their accuracy. No person in this firm's employment has the authority to make or give any representation or warranty in respect of the property.