

Property ref: 64803

Hunsaker, Alfred Street, Reading, RG1 7AU

£1,800 PCM

HASLAM'S
Lettings



An impressive contemporary style eighth floor corner plot apartment, situated in a prime town centre development. A well planned two bedroom apartment benefitting from an elevated position with a sweeping bay window to the living room; concierge facilities and within walking distance of Reading's mainline railway station and town centre. Reading Borough Council tax band D.

Available 03/09/2026

- Two bedrooms with built in wardrobes
- Master with en-suite; Further family bathroom; Allocated parking
- Video entry system; Gas central heating
- Impressive communal areas with lift and stairs to upper floor
- Close to Reading mainline station; Concierge facility; EPC rating B
- Furnished; Managed by HASLAM'S

*Fees For Assured Periodic Tenancies: when you rent a property from us you will be required to pay a sum equivalent to one weeks' rent for a holding deposit. Upon successful application, this amount will be off set against your first months' rent. You will also be required to pay a security deposit equivalent to 5 weeks' rent which will be held and protected in line with Deposit legislation. For more information about our fees please visit: www.haslams.net
Fees for all other tenancies (Non Housing Act Tenancies / Company Lets): when you rent a property from us we will charge you a one-off fee per property. This charge is the equivalent of 15 days of the monthly rental charge (+VAT) with a minimum fee of £450 (inc.VAT) up to a maximum of £650 (inc.VAT). Other fees may apply depending on your circumstances.

0118 960 1055

lettings@haslams.net www.haslams.net

Haslams Estate Agents Ltd, 159 Friar Street, Reading, Berkshire, RG1 1HE

Broadband/Mobile Info: Connections available. For an indication of specific speeds and supply of Broadband and Mobile, we advise applicants go to the Ofcom website Broadband and Mobile Coverage Checker.



Eighth Floor

Approx. 70.0 sq. metres (753.9 sq. feet)

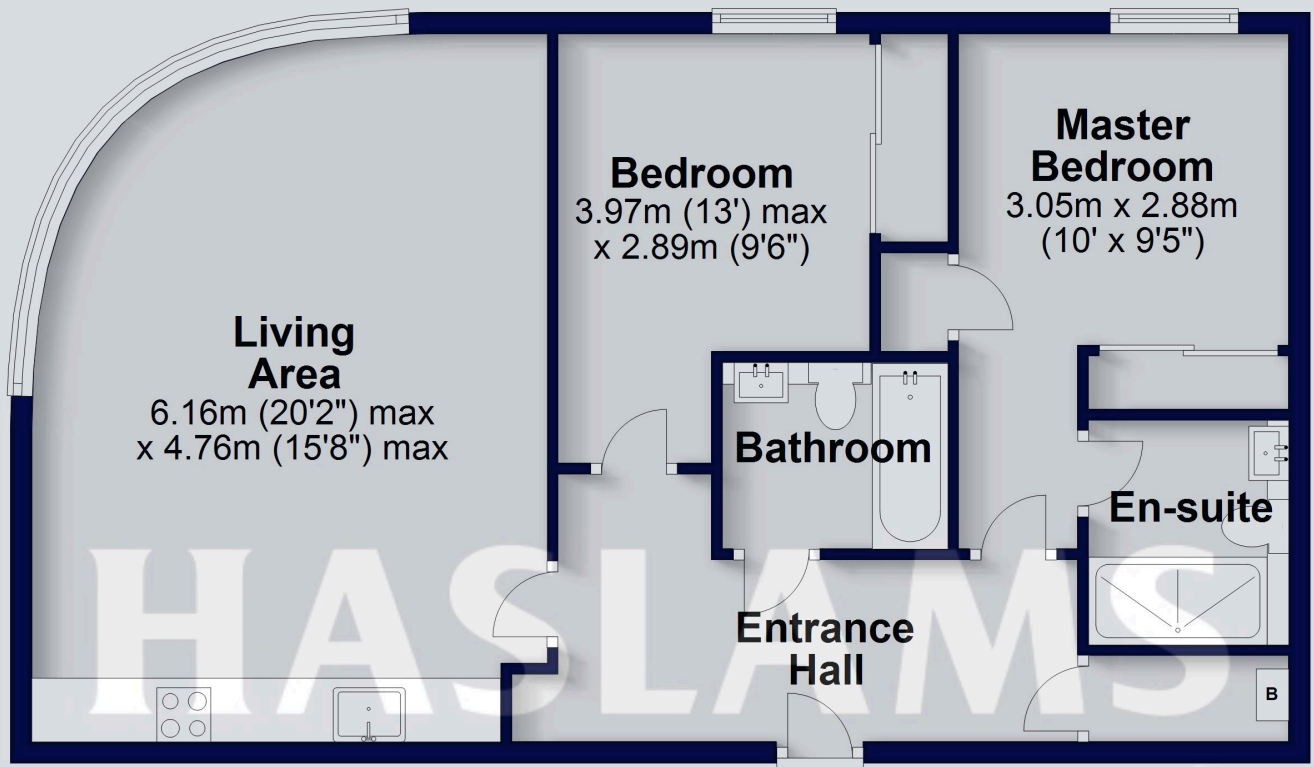

Total area: approx. 70.0 sq. metres (753.9 sq. feet)

This floorplan is for illustrative purposes only and is not to scale. The total area includes all the areas shown.
Plan produced using PlanUp.