



Coppetts Road, N10

£375,000

This exceptionally well-presented top floor flat enjoys abundant natural light throughout and features exclusive access to large loft space. The stylish open-plan South-West facing lounge and kitchen flows seamlessly onto a private balcony, perfect for relaxing or entertaining. Ideal for buyers seeking a high-quality and low-maintenance home.

Muswell Hill Playing Fields and Coldfall Woods are a short walk away, providing excellent outdoor space. The property also falls within the catchment of several highly regarded Ofsted Outstanding schools and excellent public transport links, with close proximity to East Finchley and Highgate stations

Features

- Two Bedrooms
- Top Floor
- Immaculate Condition
- Private Parking
- South - West Facing Balcony
- Open Plan Living

Coppetts Road, London, N10

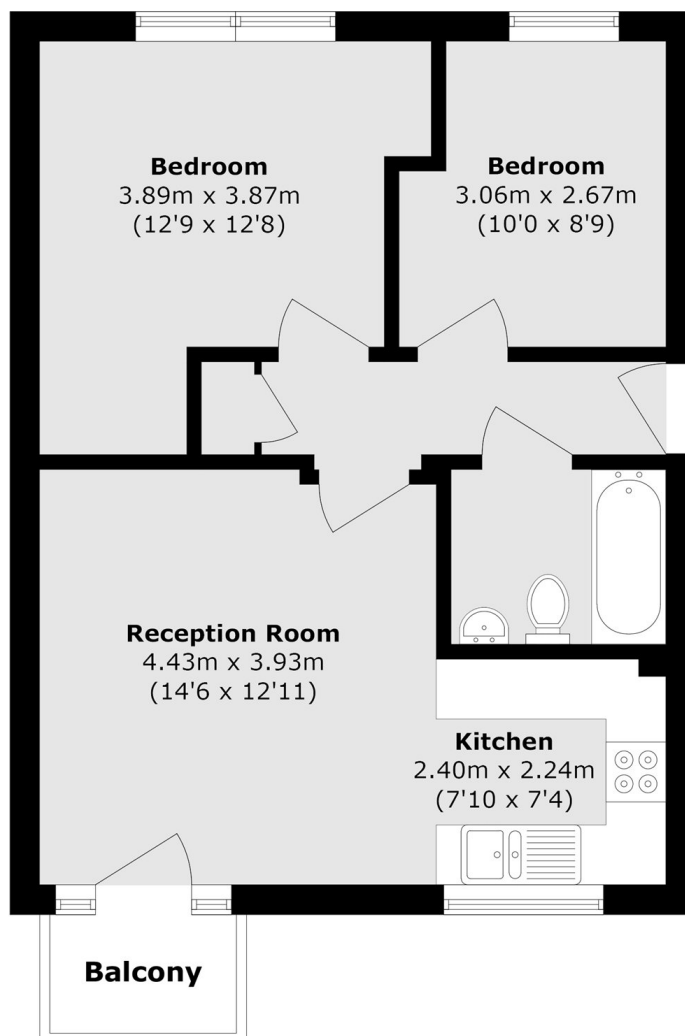

Total area (approx.): 52.9 sq. m (569.4 sq. ft)
Balcony area (approx.): 2.2 sq. m (23.6 sq. ft)