

## Elmers End Road, Anerley, SE20

Guide Price £285,000 - £300,000

2 1 1

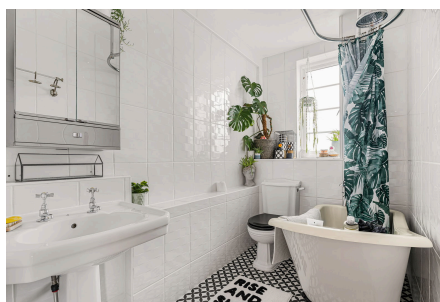

Please Quote Ref TH0310 For All Enquiries - GUIDE PRICE £285K-£300K – Beautifully presented two bedroom fifth floor flat (531 Sq.Ft) with residents parking, ideally situated in a sought after purpose built development close to Birkbeck station and within a short distance of local amenities. The property offers well appointed, bright and spacious accommodation, finished to a high standard with stylish interiors throughout - ideal for homeowner or investor alike in this fantastic residential location. Features include a generous reception room, separate well equipped fitted kitchen, family bathroom, gas central heating, double glazing, attractive wood flooring, and useful inbuilt storage. The property further benefits from a share of the freehold.



## Key Features

- Please Quote Ref TH0310 For All Enquiries
- Popular Residential Block
- Bright and Spacious Reception Room
- Modern Bathroom
- Close to Excellent Transport Links
- Well Presented Two Bedroom Fifth Floor Flat (531 Sq.Ft)
- Stylish Interiors and Quality Finish
- Separate Well Equipped Kitchen
- Share of Freehold
- Easy Access Shops, Schools and Amenities

**Approximate Gross Internal Area 531 sq ft - 49 sq m**

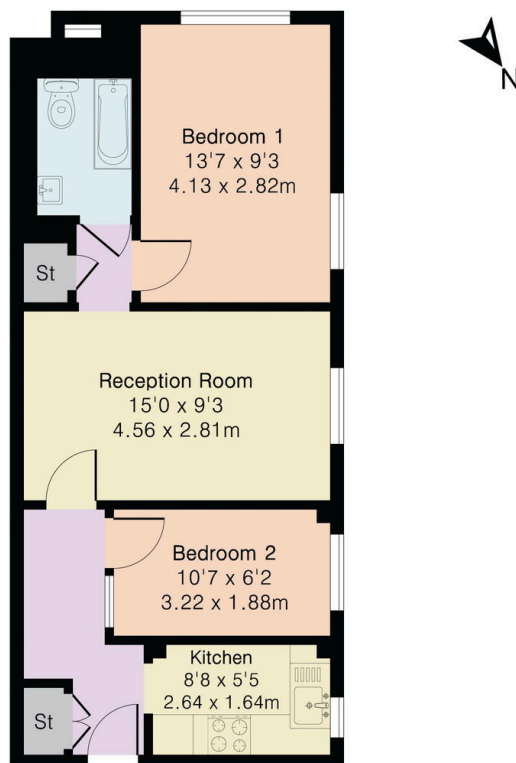

Fifth Floor

