

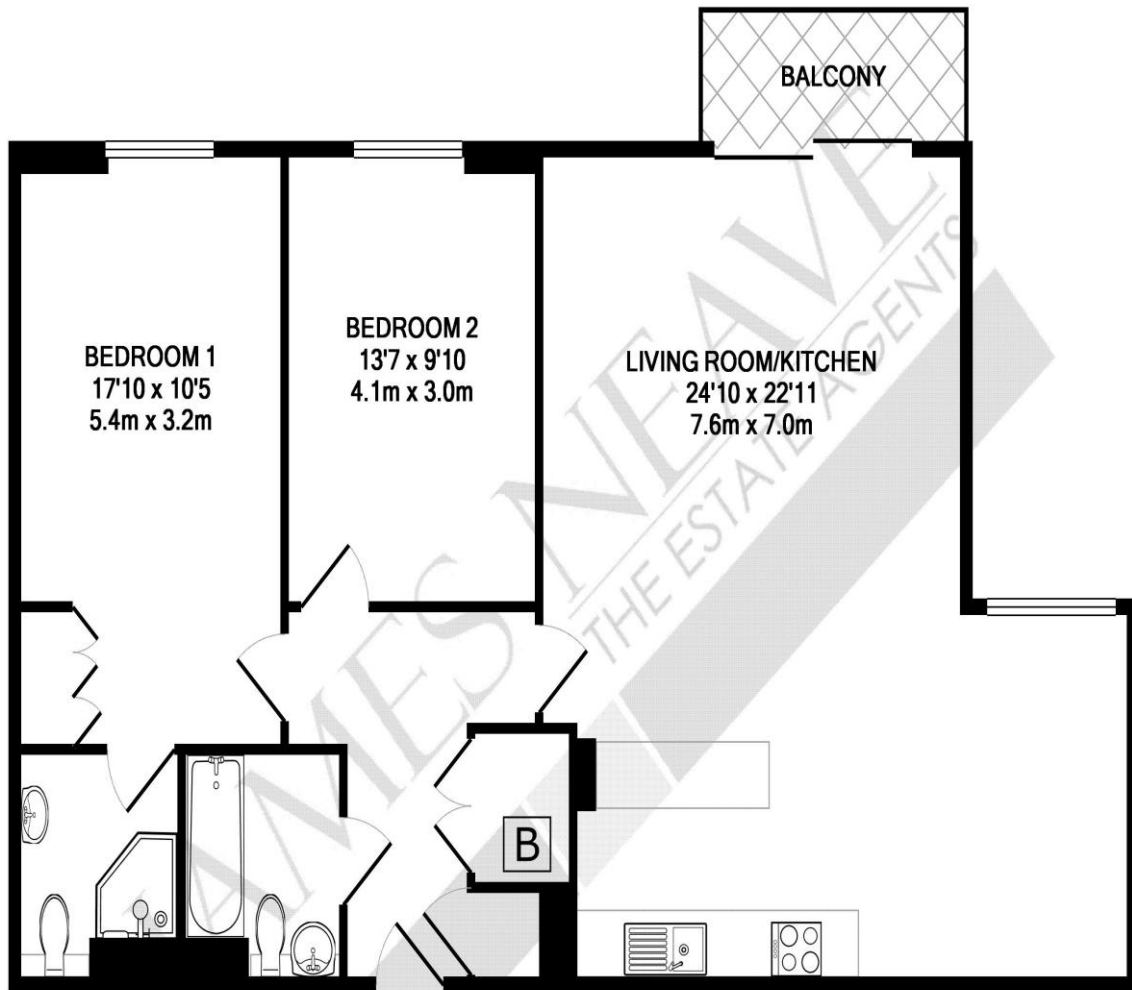

**242 The Heart Walton on Thames Surrey KT12 1GB**

**£1850pcm + initial deposit**





TOTAL APPROX. FLOOR AREA 991 SQ.FT. (92.1 SQ.M.)

Whilst every attempt has been made to ensure the accuracy of the floor plan contained here, measurements of doors, windows, rooms and any other items are approximate and no responsibility is taken for any error, omission, or mis-statement. This plan is for illustrative purposes only and should be used as such by any prospective purchaser. The services, systems and appliances shown have not been tested and no guarantee as to their operability or efficiency can be given  
 Made with Metropix ©2012



James Neave Estate agents are delighted to offer to let this two-bedroom apartment in the popular Heart development. This property offers larger than average accommodation including a 24'x22' lounge, sunny balcony, family bathroom and en-suite shower room, fully fitted kitchen area, storage, underground parking for one car, concierge service and 24-hour security. The property is conveniently located for easy access to High Street shops, restaurants, and public transport. Available to let unfurnished from 16th May 2026. EPC Rating C.



**AGENTS NOTES:** These details do not constitute any part of an offer or contract. In issuing them we do not have any authority to give any warranty or representation whatsoever in respect of this property. These details are provided without any responsibility on our part or the part of the vendors. No statements in these details are to be relied upon as representations of fact and purchasers should satisfy themselves by inspection or otherwise as to the accuracy of the statements contained therein.

**Equipment:** We have not tested the equipment or central heating system mentioned in these particulars and purchasers are advised to satisfy themselves as to their working order and condition.

**Measurements:** Great care is taken when measuring but measurements should not be relied upon for ordering carpets, equipment, etc.