

Castles



P Permit holders only SE
On event days
Noon - 9 pm

OFFERS IN EXCESS OF
£399,950
Raynham Avenue
Edmonton, N18 2BP

PROPERTY SUMMARY

A two bedroom Victorian Terraced property situated within a 1/4 mile of Fore Street with it's shops and transport links. The property comprises of Reception one and kitchen to ground floor with a further two bedrooms and bathroom. It also has features to include, 47ft rear garden, gas central heating and is offered for sale on a chain free basis.





Raynham Avenue, London, N18

Approximate Gross Internal Area = 832 sq ft / 77.2 sq m

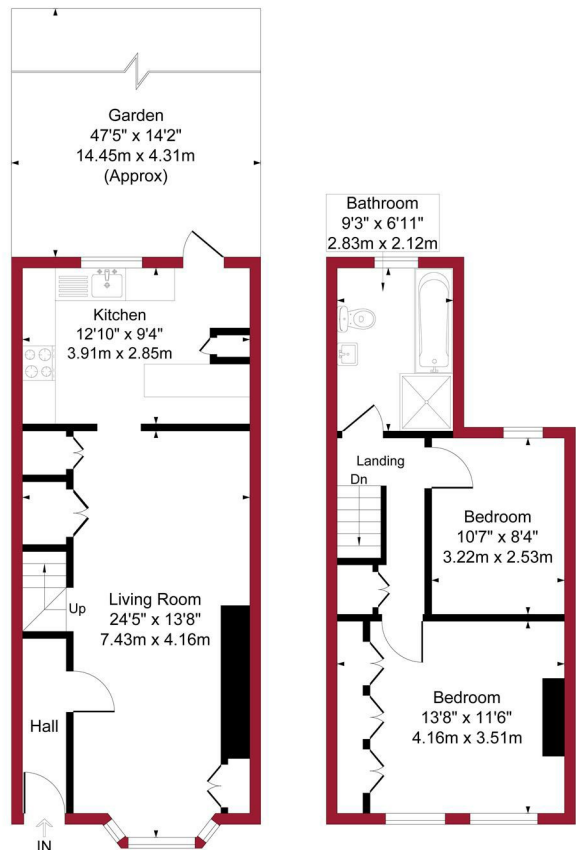

Ground Floor
Gross Internal
Floor Area 454 sq ft / 42.1 sq m

First Floor
Gross Internal
Floor Area 378 sq ft / 35.1 sq m

For a guide to the area
please scan this code for
more information

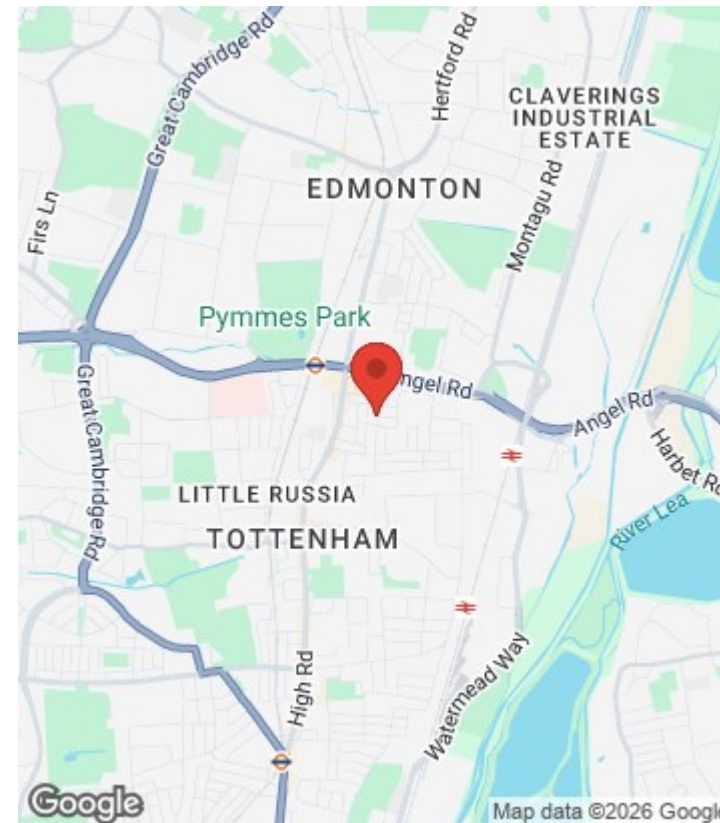
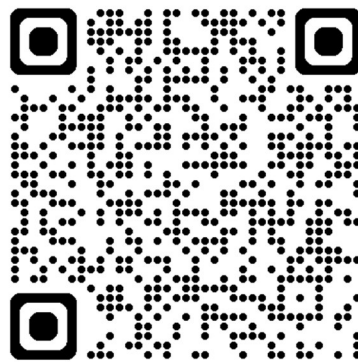

House
Freehold
Council:
Council Tax Band: C

Agents Note: Whilst every care has been taken to prepare these particulars, they are for guidance purposes only. All measurements are approximate and are for general guidance purposes only and whilst every care has been taken to ensure their accuracy, they should not be relied upon and potential buyers/tenants are advised to recheck the measurements



OFFICE ADDRESS

438 Hertford Road
Edmonton
London
N9 8AB

OFFICE DETAILS

020 8804 8123
edmonton@castles.london
<https://www.castles.london/>

| Energy Efficiency Rating | | Current | Potential |
|---|---|-------------------------|-----------|
| Very energy efficient - lower running costs | | | |
| 102 (ph1) | A | | |
| 81 (ph1) | B | | 87 |
| 69 (ph1) | C | | |
| 55 (ph1) | D | 63 | |
| 39 (ph1) | E | | |
| 21 (ph1) | F | | |
| 1 (ph1) | G | | |
| Not energy efficient - higher running costs | | | |
| England & Wales | | EU Directive 2002/91/EC | |