



34 Parkinson Drive

, Chelmsford, CM1 3GH

£185,000



Nestled in the desirable area of Parkinson Drive, Chelmsford, this charming two-bedroom first floor flat with an extended lease presents an excellent opportunity for those looking to make their mark on this property. Spanning a comfortable 540 square feet, this home, constructed in 2002, offers a solid foundation for modern living.

While the property is in need of some modernisation, it provides a blank canvas for potential buyers to infuse their personal style and preferences. The layout is practical, with ample space for both relaxation and entertaining. The two bedrooms are well-proportioned, making them ideal for a small family, a couple, or even as a rental investment.

Situated in a friendly neighbourhood, this house benefits from convenient access to local amenities, schools, and transport links, ensuring that everything you need is within easy reach. The potential for enhancement and personalisation makes this property a unique find in the Chelmsford area.

Whether you are a first-time buyer eager to create your dream home or an investor looking for a property with great potential.



ENTRANCE

Airing cupboard, security entry phone, doors to all rooms

LOUNGE

14'3 X 13'9 (4.34M X 4.19M) Storage heater, large bay window to front aspect

KITCHEN

8'4 X 8'2 MAX (2.54M X 2.49M) Comprising of wall base units., washing machine & fridge freezer. In need of updating.

BEDROOM 1

13' X 10'1 (3.96M X 3.07M) window to rear, storage heater

BEDROOM 2

10'4 X 7'1 (3.15M X 2.16M) window to rear, panel heater

BATHROOM

BATHROOM White suite with panelled bath with mixer tap and shower head, WC, pedestal wash hand basin, extractor fan, part tiled walls & extractor fan

EXTERNAL

Parking space. communal gardens, bin store & bike shed.

INFORMATION

Term of lease: 164 years remaining

Maintenance: £1,955.50 P.A this includes water rates

Ground rent: £150 P.A

Council Tax Band C

EPC C

Area Map



Floor Plans

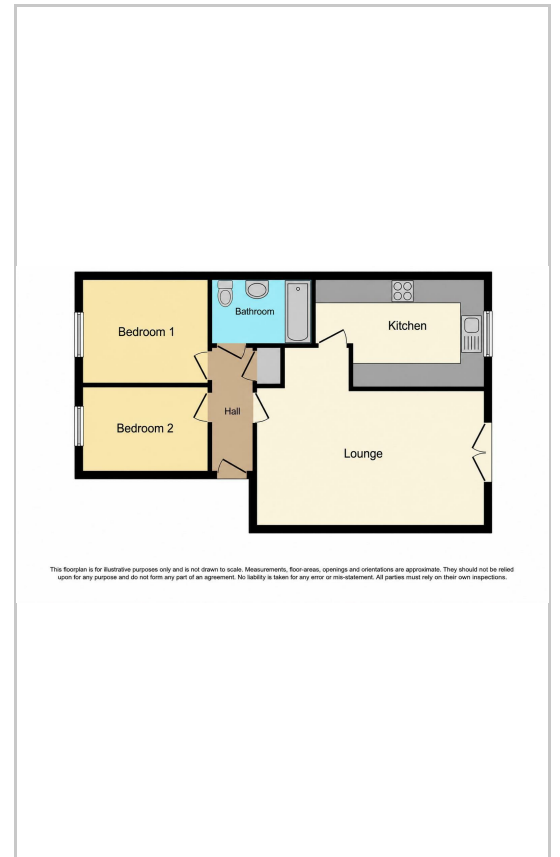

Energy Efficiency Graph

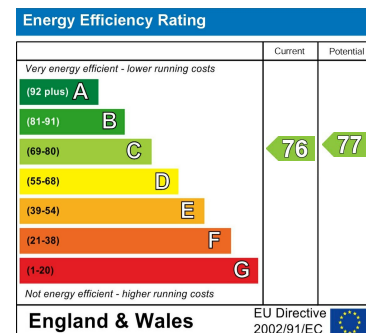

These particulars, whilst believed to be accurate are set out as a general outline only for guidance and do not constitute any part of an offer or contract. Intending purchasers should not rely on them as statements of representation of fact, but must satisfy themselves by inspection or otherwise as to their accuracy. No person in this firm's employment has the authority to make or give any representation or warranty in respect of the property.

65 New London Road, Chelmsford, CM2 0ND

Tel: 01245 266088 Email: property@elwelltaylor.co.uk <https://www.elwelltaylor.co.uk>