



Castle House, Bowerchalke, Salisbury



## A charming 4 bedroom attached period house with flexible accommodation, attractive garden with rural views and a double car-barn.

Castle  
House Bowerchalke,  
Salisbury, SP5 5DB

PCM  
£1,950 PCM



Set in the highly desirable and picturesque Chalke Valley, this bright and generously proportioned property allows for comfortable living with flexible and characterful accommodation, including good sized sitting rooms each with working fireplaces, a large 'Farmhouse' style kitchen/dining room complete with an AGA, a home office, 2 large double bedrooms, one with en suite shower room, and two further single bedrooms. The charming cottage garden backs on to open-fields and benefits from a double car barn providing off road parking for two vehicles.

### Features

- Four bedrooms
- Kitchen/breakfast room with Aga
- Double carbarn
- Dogs considered
- Three reception rooms
- Study
- Pretty garden with rural views
- Available immediately

### Tenancy & Restrictions

To be let on an Assured Periodic Tenancy, with a 12 month protected period, rolling monthly with requirement for a two month tenants' notice. No smokers.

### EPC Rating

E (44)

### Outgoings

Council Tax: Wiltshire £3394  
(2026/27) Band E

### Size

1851.00 sq ft

### Location

Bowerchalke is a popular and unspoilt village situated about 11 miles west of the cathedral city of Salisbury, having a vibrant community with an active cricket club, 13th century Church and monthly market in the village hall. Nearby Broad Chalke has a well regarded pub, shop/post office, primary school, doctors surgery and Church. Salisbury benefits from a wide range of amenities & has excellent rail links and provides direct trains to London Waterloo (90 mins), Bristol (80 mins) and Bath (60 mins).



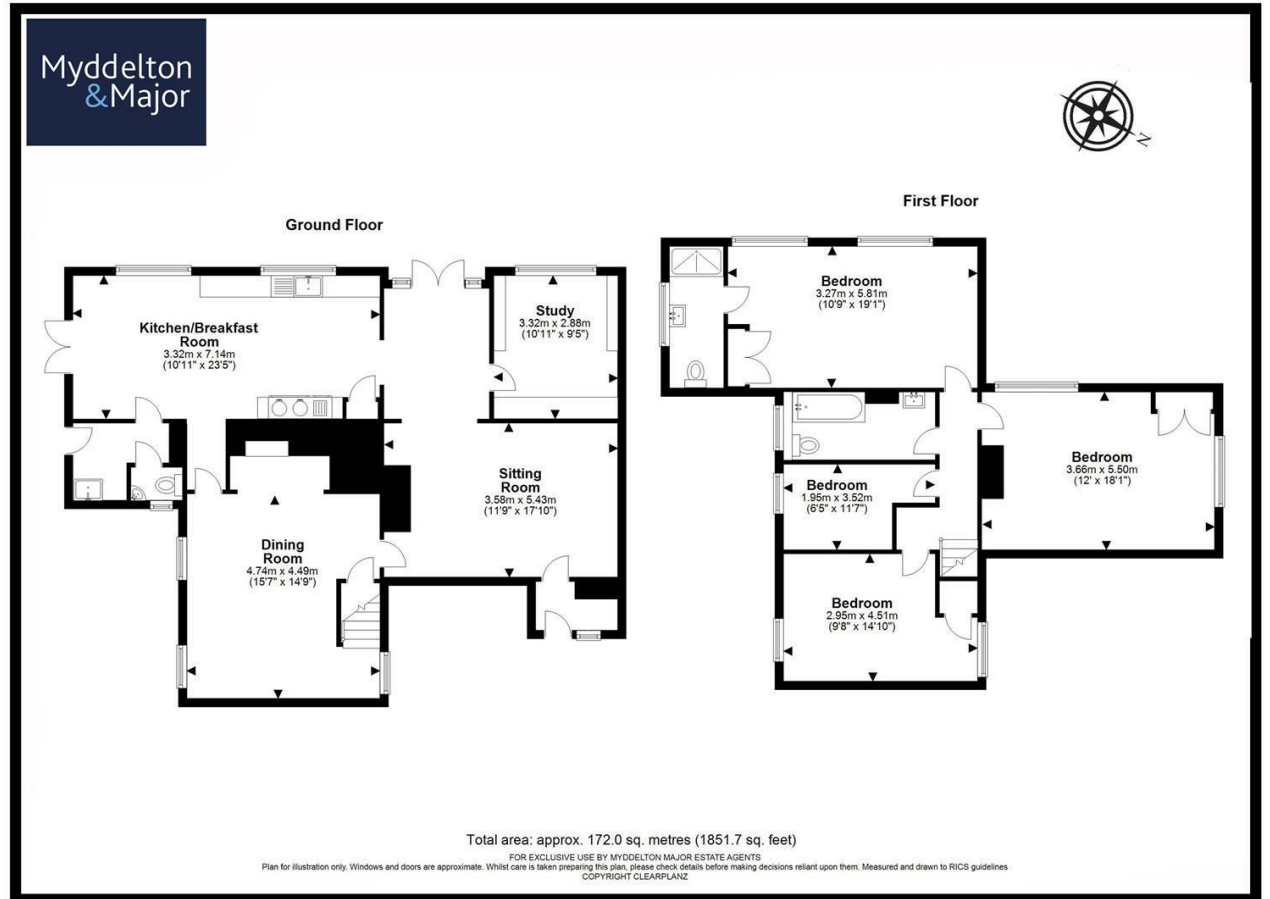
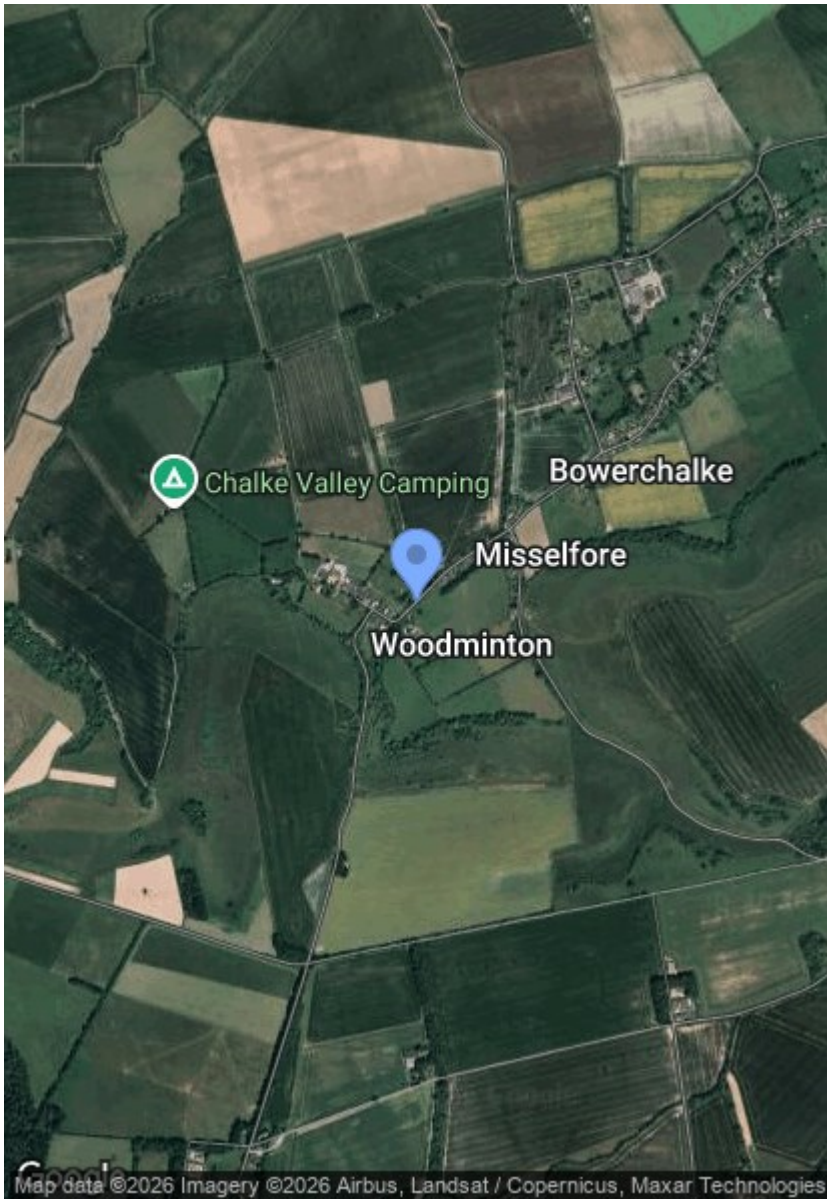

**Disclaimer Notice** Myddelton & Major and their clients give notice that:- i) they have no authority to make or give any representations or warranties in relation to the property, ii) these particulars do not form part of any offer or contract and must not be relied upon as statements or representations of fact. iii) any areas, measurements or distances are approximate. The text, photographs and plans are for guidance only and are not necessarily comprehensive. It should not be assumed that the property has all the necessary planning, Building Regulation or other consents, and any services, equipment or facilities have not been tested by the agent. iv) the purchaser must satisfy themselves by inspection or otherwise.