

HARRY CHARLES

Property Specialists



Percy Court, Watford, WD18 0QA

Price £410,000



**** 3 BEDROOM DUPLEX APARTMENT - SPLIT OVER 1ST AND 2ND FLOORS - EN-SUITE TO MASTER BEDROOM - GATED DEVELOPMENT - COUNCIL TAX BAND D - OPEN PLAN LIVING ROOM/KITCHEN - NO UPPER CHAIN **** We are delighted to offer for sale this split level duplex apartment in an exclusive gated development in Watford town centre. The accommodation includes an open plan reception to a fully fitted kitchen, a master bedroom with sky lights and en suite shower room, two further bedrooms and a fully-tiled family bathroom. Other benefits include gas central heating, double glazed sash windows and secure bicycle storage. Externally there is a gated courtyard at the rear. Please note that this property does not benefit from any parking. In order to arrange an early appointment to view, please contact us without further delay.

- Split Level Duplex Apartment
- En-Suite To Master Bedroom
- 2 Further Bedrooms
- Council Tax Band D
- Town Centre Location
- Three Bedrooms
- Open Plan Lounge/Kitchen
- Family Bathroom
- Shared Gated Courtyard At Rear
- No Upper Chain



Floor Plan

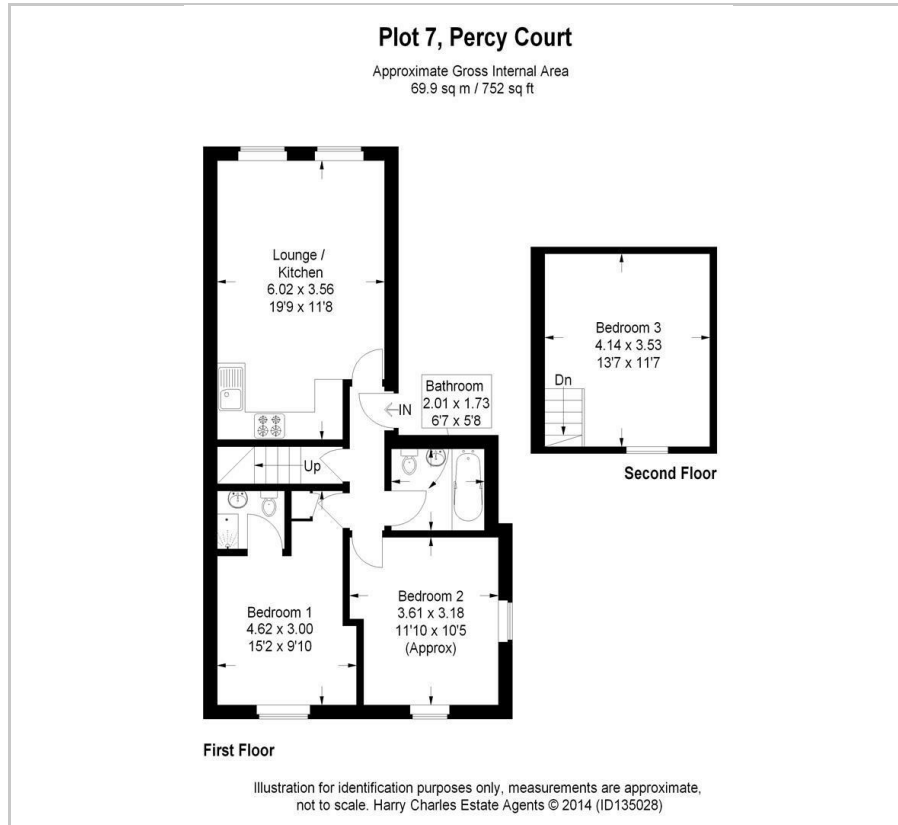

Area Map



Energy Efficiency Graph

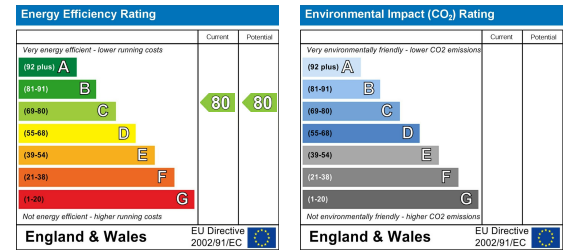

These particulars, whilst believed to be accurate are set out as a general outline only for guidance and do not constitute any part of an offer or contract. Intending purchasers should not rely on them as statements of representation of fact, but must satisfy themselves by inspection or otherwise as to their accuracy. No person in this firm's employment has the authority to make or give any representation or warranty in respect of the property.