

Jonathan Hunt

ESTATE AGENCY

20 High Street Ware SG12 9BX

Tel: 01920 411090

8 High Street Buntingford SG9 9AG

Tel: 01763 272727

info@jonathan-hunt.co.uk

www.jonathanhunt.co.uk



23 Temple Fields, Hertford, SG14 3LR

£225,000

JONATHAN HUNT are pleased to offer this TWO DOUBLE BEDROOM first floor apartment offered CHAIN FREE. The property requires moderate updating and offers a generous sized living room with balcony. Communal gardens and a 125 YEAR LEASE

Buntingford Branch - Company No. 10303541 VAT No. 10303541

Ware Branch - Company No. 4759215 VAT No. 700174975

23 Temple Fields, Hertford, SG14 3LR

HALLWAY



KITCHEN



LIVING ROOM 20'8" x 11'1" (6.3 x 3.4)



BEDROOM ONE 12'5" x 11'1" (3.8 x 3.4)



BALCONY



BEDROOM TWO 11'9" x 9'10" (3.6 x 3)



23 Temple Fields, Hertford, SG14 3LR

BATHROOM



SEPERATE W/C

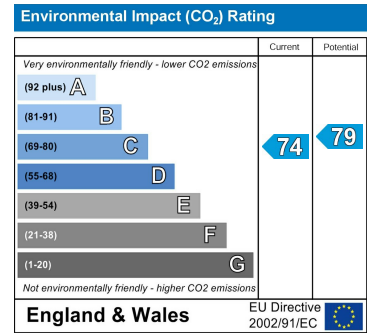
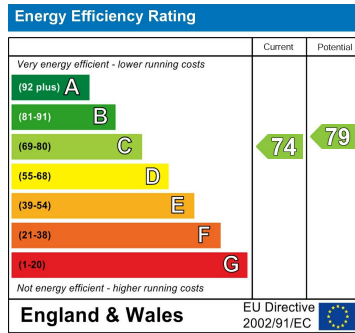
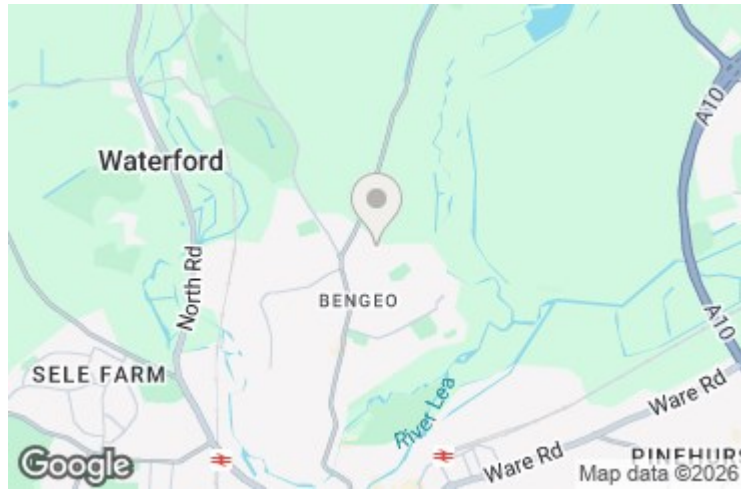

EXTERIOR



COMMUNAL GARDENS

Approx. 69.3 sq. metres (746.0 sq. feet)
(excluding Balcony)

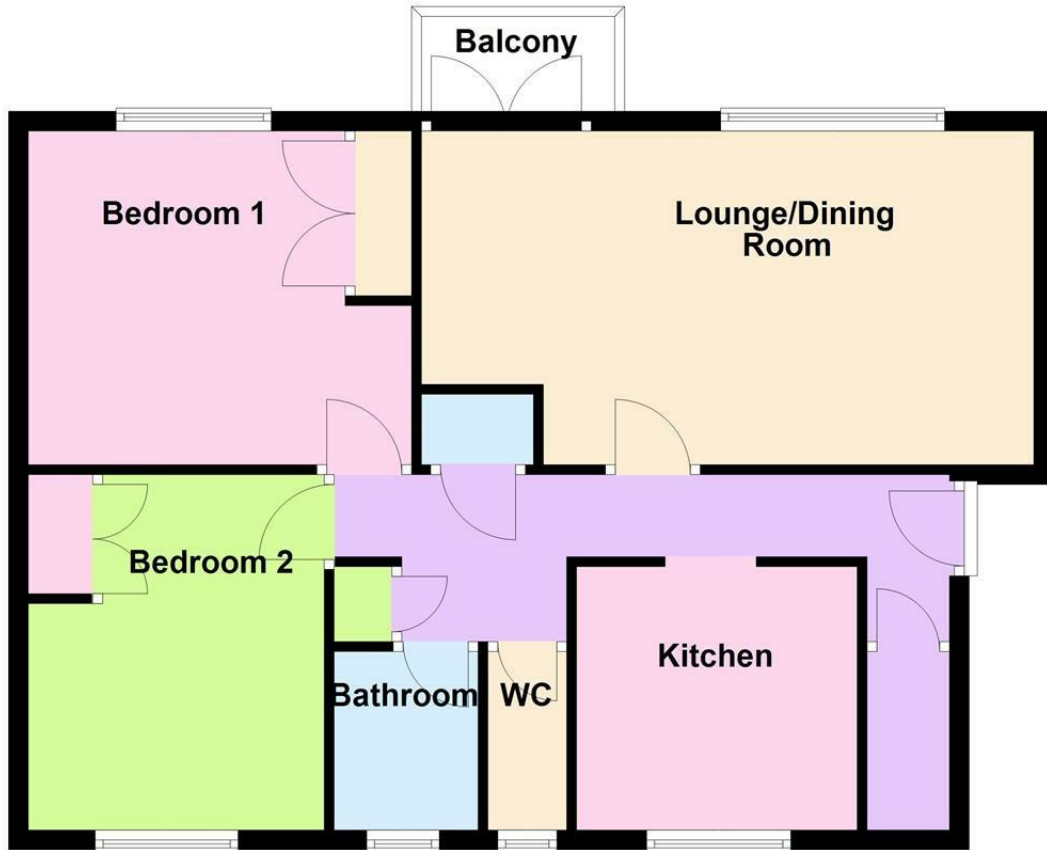

Total area: approx. 69.3 sq. metres (746.0 sq. feet)

Whilst every attempt has been made to ensure the accuracy of the floor plan contained here, measurements of doors, windows, rooms and any other item are approximate and no responsibility is taken for any error, omission, or misstatement. This plan is for illustrative purposes only and should only be used as such by any prospective purchaser.
Plan produced using PlanUp.