



Mortlake High Street  
London, SW14

CHESTERTONS





A beautifully presented two-bedroom apartment with Thames views, a long lease, and excellent transport links, ideally positioned on Mortlake High Street. This attractive home offers a wonderful blend of character and contemporary living, benefitting from newly installed double glazing, a modern kitchen and bathroom, wooden flooring, and a lease in excess of 100 years.

The stylish kitchen is fitted with shaker-style units topped with wooden work surfaces, complemented by metro-tiled splashbacks and a classic butler sink — creating a smart and welcoming space with a modern finish.

The bright and spacious reception room features wooden flooring and ample space for both seating and dining. Two large windows draw in excellent natural light while offering charming views towards the River Thames. The principal bedroom is generously sized with space for wardrobes, and the second bedroom is ideal as a guest room, nursery, or home office.

Residents enjoy access to a well-maintained communal courtyard perfect for relaxing outdoors and mingling with your neighbours — along with the added benefit of a large external storage cupboard, ideal for bicycles or additional storage.

Mortlake High Street is superbly located for access to the amenities of Barnes and East Sheen, including independent cafés, restaurants, pubs, and supermarkets on nearby White Hart Lane. Mortlake Station and Barnes Bridge Station are both within half a mile, providing excellent transport links into central London.

An excellent opportunity to acquire a charming and well-located home in a highly desirable riverside setting.

- Close to Barnes and East Sheen
- River Views
- Communal Courtyard Garden
- External Storage Cupboard
- Two Bedrooms
- Great Condition

Asking Price £430,000

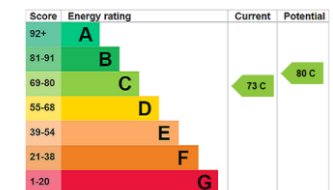

**Tenure:** Leasehold 102 years 11 months

**Service Charge:** £1252

**Ground Rent:** £10

**Local Authority:** London Borough Of Richmond Upon Thames

**Council Tax Band:** C

**Chestertons East Sheen Sales**

254A Upper Richmond Road West

East Sheen

London

SW14 8AG

sheen@chestertons.co.uk

020 8104 0580

## Ashleigh House, Mortlake High Street, SW14

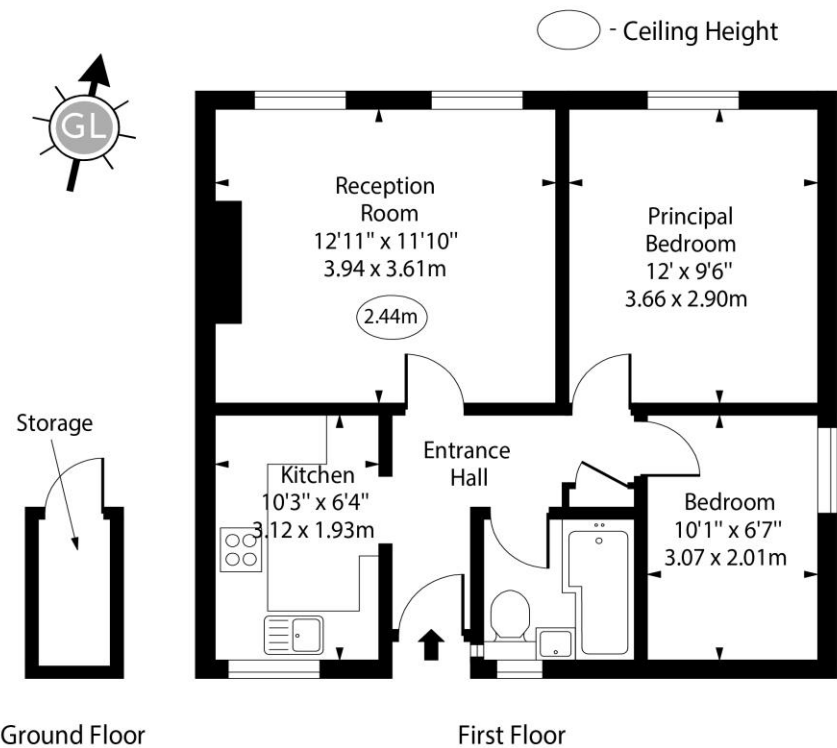

**Approx Gross Internal Area    513 Sq Ft - 47.66 Sq M**  
(Excluding Storage)

Every attempt has been made to ensure the accuracy of the floor plan shown.  
However, all measurements, fixtures, fittings, and data shown are approximate interpretations and  
for illustrative purposes only. Measured according to the RICS. Not To Scale.

[www.goldlens.co.uk](http://www.goldlens.co.uk)  
Ref. No. 030513E

Chesterton UK Services Limited trading as Chestertons for themselves and for the vendor of this property whose agents they are, give notice that (i) these particulars do not constitute any part of an offer or contract, (ii) all statements contained within these particulars are made without responsibility on the part of Chestertons or the vendor, (iii) whilst made in good faith, none of the statements contained within these particulars are to be relied upon as a statement or representation of fact, (iv) any intending purchasers must satisfy themselves by inspection or otherwise as to the correctness of each of the statements contained within these particulars, (v) the vendor does not make or give either Chestertons or any person in their employment any authority to make or give representation or warranty whatsoever in relation to this property. Wide angle lenses may be used. ©Copyright Chestertons | Chesterton UK Services Limited | Registered Office 40 Connaught Street, Hyde Park, London W2 2AB Registered Company Number 05334580.



This paper is  
100% recyclable