



Altolusso,
Bute Terrace, Cardiff,
CF10 2FH



PCM
£1,150 PCM

1 Bedrooms
Flat - Penthouse

ALTOLUSSO - CARDIFF CITY CENTRE - PENTHOUSE ONE BEDROOM APARTMENT

In a prime location just off St Davids 2 shopping centre and very near to the bars and restaurants around The Hayes and Mill Lane. A fabulous penthouse apartment on the 16th floor of this attractive and well established residential development commanding views to the NW of the city over the Principality Stadium and beyond. Within 400m of Cardiff Central train station. Gated, secure allocated parking for one car. Concierge service. New timber flooring. Electric heating. Furnished. Water rates included. EPC Rating C. Council tax band E. Available June 2026 for minimum twelve month initial term.

Features

- Penthouse Apartment - 16th Floor
- One Double Bedroom
- Open Plan Kitchen/Living Room with New Timber Flooring
- Furnished/Water Rates Included/Electric Heating
- Secure Gated Parking - Allocated
- 24hr Concierge /Lift Service
- Council Tax Band E/EPC Rating C
- Stunning Views to NW over City
- Available July 2026/Minimum 12 Month Term
- No Pets/No Smoking



Information

- Tenure:
- Council Tax Band: E
- Floor Area: 516.00 sq ft
- Current EPC Rating: C
- Potential EPC Rating: B



1 BEDROOMS



1 BATHROOMS



1 RECEPTION ROOMS



ENERGY RATING: C



Ground Floor
Approx. 515.6 sq. feet

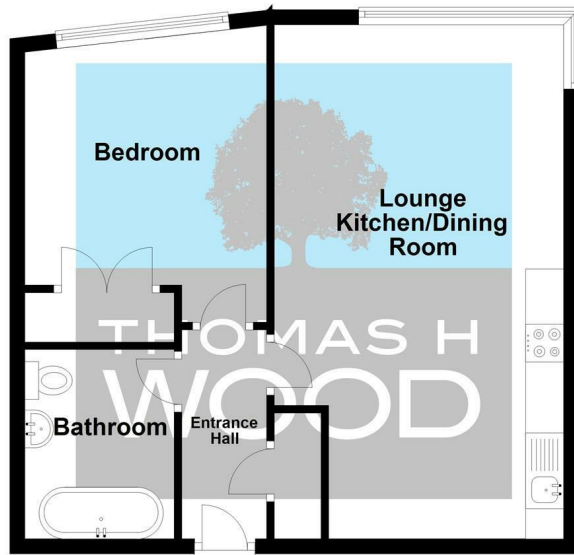

Total area: approx. 515.6 sq. feet



Agents Note: Whilst every care has been taken to prepare these sales particulars, they are for guidance purposes only. All measurements are approximate and for general guidance purposes only and whilst every care has been taken to ensure their accuracy, they should not be relied upon and potential buyers are advised to recheck the measurements

| Energy Efficiency Rating | | Current | Potential |
|---|--|-------------------------|-----------|
| Very energy efficient - lower running costs | | | |
| (92 plus) A | | | |
| (81-91) B | | | |
| (69-80) C | | 77 | 84 |
| (55-68) D | | | |
| (39-54) E | | | |
| (21-38) F | | | |
| (1-20) G | | | |
| Not energy efficient - higher running costs | | | |
| England & Wales | | EU Directive 2002/91/EC | |

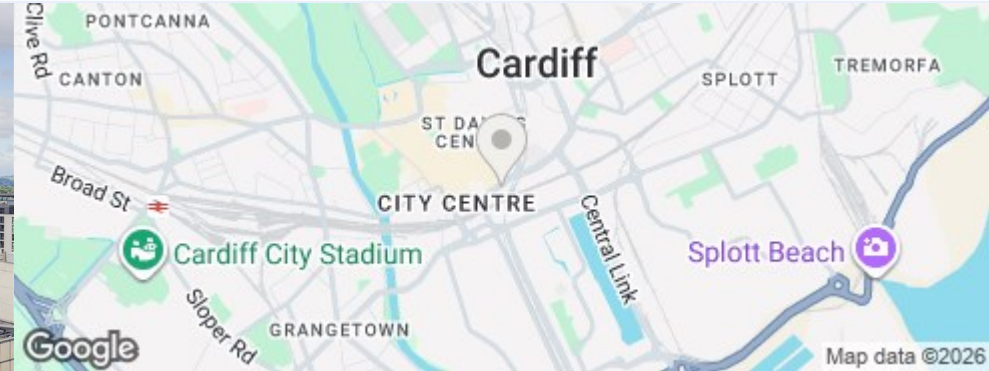

CONTACT

sales@thomashwood.com
02920 626 252
thomashwood.com

WHITCHURCH BRANCH

14 Park Road,
Whitchurch
CF14 7BQ

RADYR BRANCH

5 Station Road,
Radyr, Cardiff
CF15 8AA