

## RELIANCE WHARF, HERTFORD ROAD, N1

### 1 BED APARTMENT

£2,400 PER MONTH

\*SHORT LET UP TO 5 MONTHS / INCLUDING ALL BILLS\* A beautifully presented and generously proportioned one-bedroom apartment extending to approximately 656 sq ft, positioned on the first floor of the sought-after Reliance Wharf development, N1. Offered in very good condition throughout, this impressive home combines spacious internal living with exceptional outdoor space.

The apartment features a bright and well-balanced open-plan reception and kitchen, designed for both everyday living and entertaining. Large windows allow natural light to flood the space, while doors lead directly onto a substantial private balcony, providing an outstanding outdoor area ideal for dining, relaxing or hosting guests.

The large double bedroom offers excellent proportions and storage potential, complemented by a modern bathroom finished in a clean, contemporary style.

**Hemmingfords**

**Reliance Wharf, N1**

**Approximate Gross Internal Area = 60.99 sq m / 656.49 sq ft**

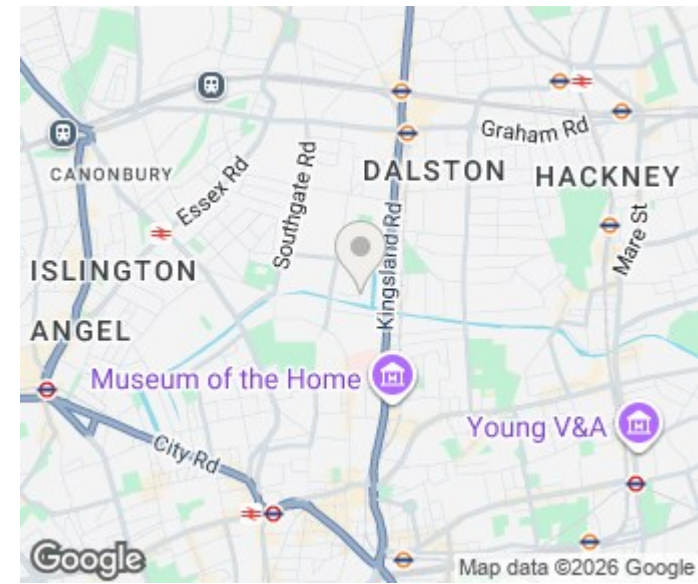
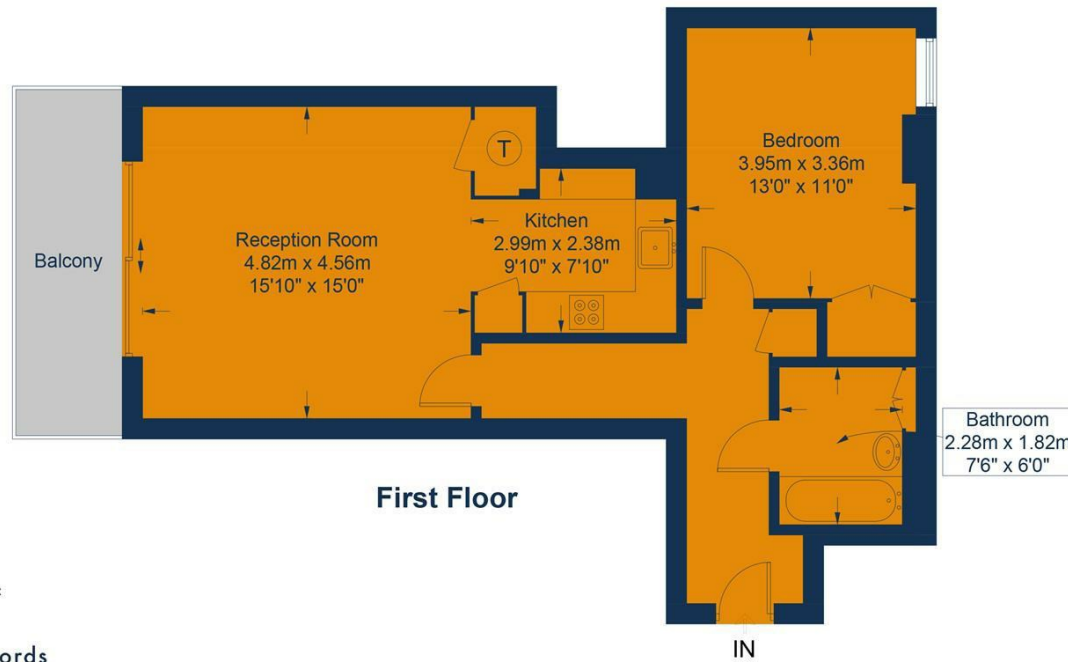

Brought to you by:

**Hemmingfords**

This plan is for layout guidance only and is not to scale unless stated. All dimensions, including windows, doors, fittings, and the total area, are approximate measurements. Produced by a



Energy Efficiency Rating		Current	Potential
Very energy efficient - lower running costs			
(92 plus) A			
(81-91) B			
(69-80) C			77
(55-68) D		59	
(39-54) E			
(21-38) F			
(1-20) G			
Not energy efficient - higher running costs			
<b>England &amp; Wales</b>		EU Directive 2002/91/EC	

Agents Note: Whilst every care has been taken to prepare these particulars, they are for guidance purposes only. All measurements are approximate and are for general guidance purposes only and whilst every care has been taken to ensure their accuracy, they should not be relied upon and potential buyers/tenants are advised to recheck the measurements

Hemmingfords Lettings  
34 Upper Street  
London  
N1 0PN

020 3890 7470  
info@hemmingfords.co.uk  
www.hemmingfords.co.uk

**Hemmingfords**