

PER MONTH

**£1,850 Per Month**

**Acton Lane**

Chiswick, W4 5DL

# Acton Lane

Approx. Gross Internal Area  
43 Sq M - 465 Sq Ft

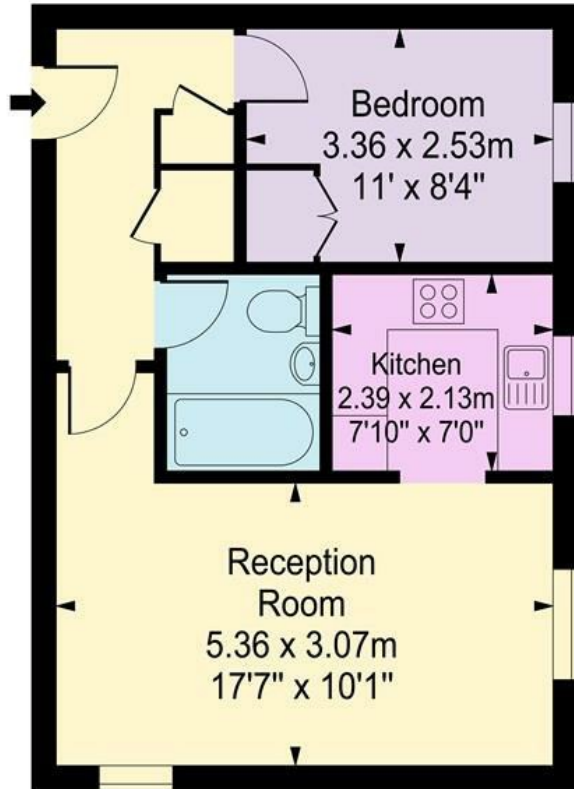

Ground Floor

Every attempt is made to assure accuracy, however measurements are approximate and for illustrative purposes only. Not to scale.  
Floor plan by [www.frameworkphotos.co.uk](http://www.frameworkphotos.co.uk)

- 1
- 1
- 1



Energy Efficiency Rating		
	Current	Potential
Very energy efficient - lower running costs		
(92 plus) <b>A</b>		
(81-91) <b>B</b>		
(69-80) <b>C</b>		
(55-68) <b>D</b>		
(39-54) <b>E</b>		
(21-38) <b>F</b>		
(1-20) <b>G</b>		
Not energy efficient - higher running costs		
<b>England &amp; Wales</b>	69	77
	EU Directive 2002/91/EC	

Agents Note: Whilst every care has been taken to prepare these particulars, they are for guidance purposes only. All measurements are approximate and are for general guidance purposes only and whilst every care has been taken to ensure their accuracy, they should not be relied upon and potential buyers/tenants are advised to recheck the measurements

## OFFICE ADDRESS

The Clock House  
66 South Parade  
Chiswick  
London

## OFFICE DETAILS

020 8995 1600  
[lettings@andrewnunnassociates.co.uk](mailto:lettings@andrewnunnassociates.co.uk)  
[andrewnunnassociates.co.uk](http://andrewnunnassociates.co.uk)