

22 Lime Grove, Old Trafford, Trafford, M16 0NN



**JP & Brimelow**  
ESTATE AGENTS

# Offers In The Region Of £385,000

 3  1  2  D

\*\*\*VIDEO TOUR AVAILABLE\*\*\* An attractive and well-kept, bay fronted THREE BEDROOM semi-detached property situated on a popular residential cul-de-sac here in Old Trafford off Seymour Grove. Conveniently located within easy walking distance of local amenities, with Seymour and Hullard Parks close by. Excellent transport links are available via Seymour Grove into the City Centre and Media City, as well as the Metrolink station at Trafford Bar. In brief, the well-planned accommodation consists of a porch benefitting from tiled flooring, an entrance hall benefitting from useful under stairs storage, a dining room with a bay window to the front, a lounge to the rear complete with living flame fire, high ceilings and original ceiling cornices, and a fitted kitchen with access into rear enclosed garden. To the first floor there is a landing leading to the three good sized bedrooms and a three-piece family bathroom. The property benefits from both front and rear enclosed gardens and is warmed by gas fired central heating. This property would be ideal for a professional couple or a family due to the location.





## EPC Chart

Energy Efficiency Rating		Current	Potential
<i>Very energy efficient - lower running costs</i>			
(92 plus) <b>A</b>			
(81-91) <b>B</b>			<b>86</b>
(69-80) <b>C</b>			
(55-68) <b>D</b>		<b>58</b>	
(39-54) <b>E</b>			
(21-38) <b>F</b>			
(1-20) <b>G</b>			
<i>Not energy efficient - higher running costs</i>			
<b>England &amp; Wales</b>		EU Directive 2002/91/EC 	



Tenure: **Freehold** Council Tax Band: **B**

### Ground Floor

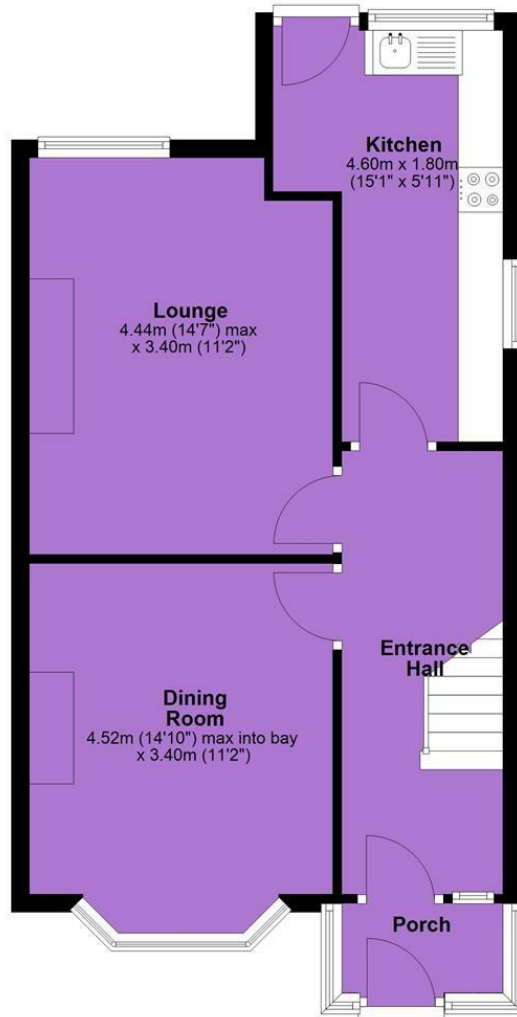

### First Floor

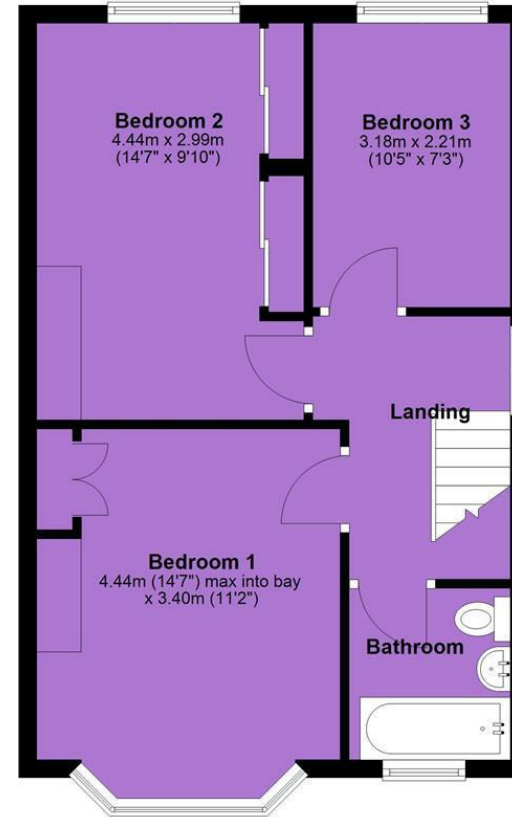

JP & Brimelow Estate Agents Ltd  
430 Barlow Moor Road, Manchester, M21 8AD  
Tel: 0161 8822233  
E: sales@jpbrimelow.co.uk www.jpandbrimelow.co.uk



**JP & Brimelow**  
ESTATE AGENTS

NOTICE: JP & Brimelow Estate Agents Ltd for themselves and for the vendors or lessors of this property whose agents they are give notice that:

- (i) the particulars are set out as a general outline only for the guidance of intending purchasers or lessees, and do not constitute, nor constitute part of, an offer or contract;
- (ii) all descriptions, dimensions, references to the condition and necessary permissions for use and occupation, and other details are given in good faith and are believed to be correct but any intending purchasers or tenants should not rely on them as statements or representations of fact but must satisfy themselves by inspection or otherwise as to the correctness of each of them;
- (iii) no person in the employment of JP & Brimelow Estate Agents Ltd has any authority to make or give any representation or warranty whatever in relation to this property.

jpandbrimelowstateagents

@jpandbrimelow