



## Calvin Street, E1

£3,100 Per calendar month

A very smart two double bedroom, two bathroom apartment just off Commercial Street in the heart of Spitalfields. The property has a bright and spacious reception room with a Juliet balcony and a private terrace off the master bedroom.

Calvin Street is close to the famous Spitalfields market where you have an array of shops and restaurants to suit all tastes.

### Features

- Two Double Bedrooms
- Two Bathrooms
- Juliet Balcony
- Private Terrace
- Second Floor
- Furnished

# Calvin Street, London, E1

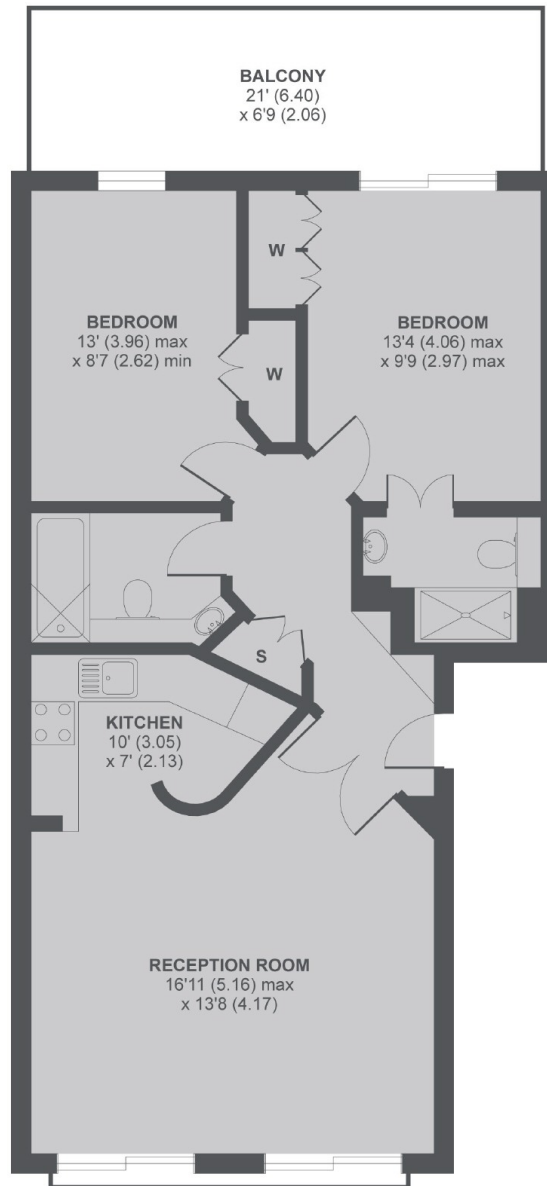

1st Floor

## Calvin Street E1

MAIN HOUSE APPROX FLOOR AREA 780 SQ.FT 72.4 SQ.M

Copyright nichecom.co.uk 2017 Produced for Dexters REF : 210251

Ground Floor

2nd Floor

# Dexters

City  
5 Sandys Row  
London  
E1 7HW

Lettings  
020 7392 9111

Energy Rating: C. We aim to make our particulars both accurate and reliable. However they are not guaranteed; nor do they form part of an offer or contract. If you require clarification on any points then please contact us, especially if you're traveling some distance to view. Please note that appliances and heating systems have not been tested and therefore no warranties can be given as to their good working order.

 **RICS** | Regulated  
Estate Agent  
and Letting Agent

dexters.co.uk