



 **2**  
Bedrooms

 **1**  
Bathroom

 **2**  
Receptions



- TWO BEDROOM SEMI-DETACHED HOME
- AVAILABLE WITH NO UPWARD CHAIN
- SPACIOUS LOUNGE
- FITTED KITCHEN WITH BUILT-IN OVEN
- SLIDING DOORS LEADING TO REAR GARDEN
- FAMILY BATHROOM
- DRIVEWAY PROVIDING OFF-ROAD PARKING
- ENCLOSED REAR GARDEN
- LAWN AND PAVED PATIO SEATING AREA
- IDEAL FOR FIRST-TIME BUYERS OR INVESTORS



**WARNING:** Viewing may result in spontaneous house-moving plans!

Tucked away on Hayhead Close in Kidsgrove, this charming two-bedroom home is ready to welcome its next owners with no upward chain to slow things down. Step inside to discover a cosy lounge, a fitted kitchen complete with a built-in oven, and sliding doors that open straight out to the rear garden – perfect for sunny mornings, summer BBQs, or pretending you're on a home makeover show.

Upstairs, you'll find two comfortable bedrooms alongside a family bathroom, while outside the property continues to impress. The front garden offers a handy driveway for off-road parking, and the enclosed rear garden features both a lawn and paved patio seating area, giving you space to relax, entertain, or simply enjoy a peaceful evening outdoors.

Whether you're a first-time buyer, downsizer, or investor, this delightful home ticks all the right boxes in a convenient Kidsgrove location.

**CONTACT SAMUEL MAKEPEACE BESPOKE ESTATE AGENTS TO ARRANGE YOUR VIEWING!**

**Disclaimer:**

All property particulars are provided in good faith and are believed to be accurate to the best of our knowledge at the time of publication. Samuel Makepeace (Newcastle & Stoke) Ltd t/a Samuel Makepeace Bespoke Estate Agents cannot accept any responsibility for any errors, omissions, or misstatements. Prospective purchasers are advised to verify the details independently and should not rely solely on the information provided when making decisions. These particulars remain the property of Samuel Makepeace Bespoke Estate Agents Stoke on Trent, Newcastle Under Lyme & Alsager.

**Ground Floor**

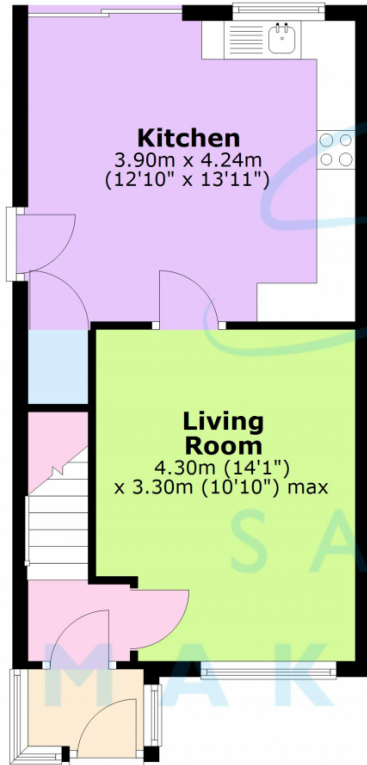

**First Floor**

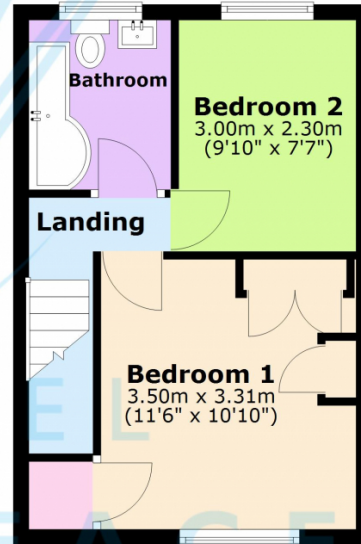

Total area: approx. 64.4 sq. metres (693.4 sq. feet)

Floorplans are provided as a guide only. All measurements are not to be relied upon. To confirm any measurements and layouts you must check yourself. Samuel Makepeace Bespoke Estate Agents do not accept any liability for the accuracy of this.  
Plan produced using PlanUp.



Scan me for more info

