

RIVERHOMES

Millharbour
Canary Wharf E14

£275,000
Leisure



Millharbour Canary Wharf E14

A truly striking, contemporary and one of a kind 60 ft. architecturally designed vessel. The flexible layout, set over two floors, can be configured to any individuals needs and is currently arranged for use by a media company. On the first floor there is an open plan reception with modern kitchen and an abundance of natural light. On the lower level there is room for 3 to 4 bedrooms and 3 bathrooms or an open plan office and separate meeting room. There are also facilities such as air conditioning, telephone, mains power and mains water as well as two standard toilets. In addition,

there is a versatile upper deck / roof garden which provides an unusual twist for corporate entertainment during the warmer months or quite simply a great place for al fresco dining. Millharbour is close to a wealth of local amenities. It's a short walk along the dock to South Quay DLR station and the hub of Canary Wharf for a wide choice of bars, restaurants, shops and further transport options.

KEY FEATURES

2 bedrooms

1 bathroom

2 floors

Large open-plan reception / office

Separate meeting room

Air conditioning

Mains power and water

Versatile upper deck or roof garden

Walking distance to shops, restaurants and public transport

Transport links from DLR

Current mooring agreement runs until the 14th October 2025. It can be transferred to commercial or residential subject to CRT vetting of new owner.





KEY INFORMATION

Local authority:	London Borough of Tower Hamlets
Internal area:	1,227 sq. ft. / 113.98 sq. m.
No. of bedrooms:	2 bedrooms
Mooring charges:	£23,600 inc VAT per year approx.

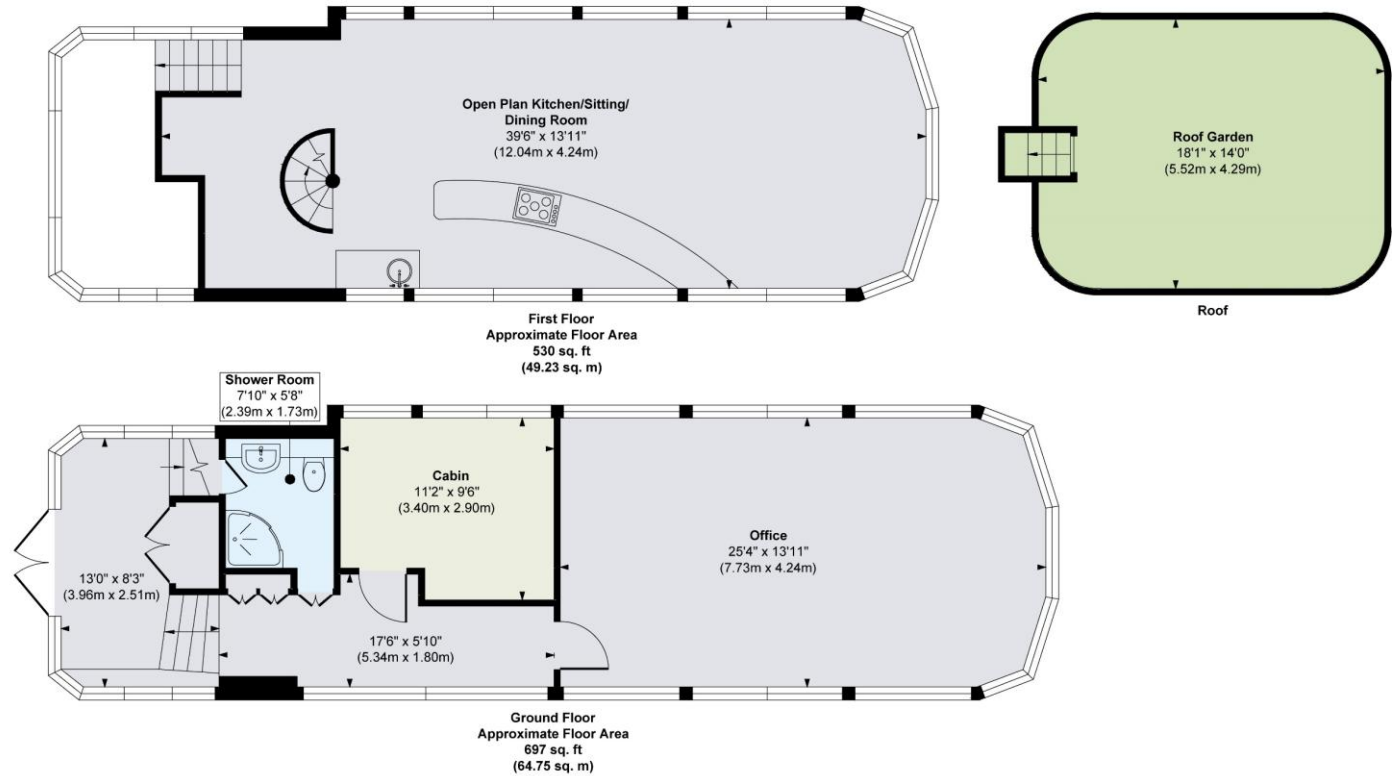

World Waterside Ltd trading as riverhomes for themselves and its clients give notice that 1: They are not authorised to make or give any representations or warranties in relation to the property either here or elsewhere, either on their own behalf or on behalf of their client or otherwise. 2: These particulars do not form part of any offer or contract and must not be relied upon as statements or representations of fact. Any areas, measurements or distances are approximate. The text, photographs and plans are for guidance only and are not necessarily comprehensive. 3: It should not be assumed that the property has all necessary planning, building regulation or other consents and any services, equipment or facilities have not been tested. 4: Lease details, service charges, ground rent (where applicable) and council tax are given as a guide only and should be checked and confirmed by your Solicitor prior to exchange of contracts. 5: They assume no responsibility and any intending purchasers or tenants must satisfy themselves by inspection or otherwise as to the correctness of each of the statements contained within these particulars. If you require clarification of any points please contact us.