



## Victoria Road, W3

£250,000

A modern one double bedroom apartment in this popular development moments from North Acton (Central line) station. The property is on the first floor and is offered with no onward chain.

Victoria Road is less than 500 metres from North Acton station and will also benefit from the new Old Oak Common station for HS2 and the Elizabeth Line.

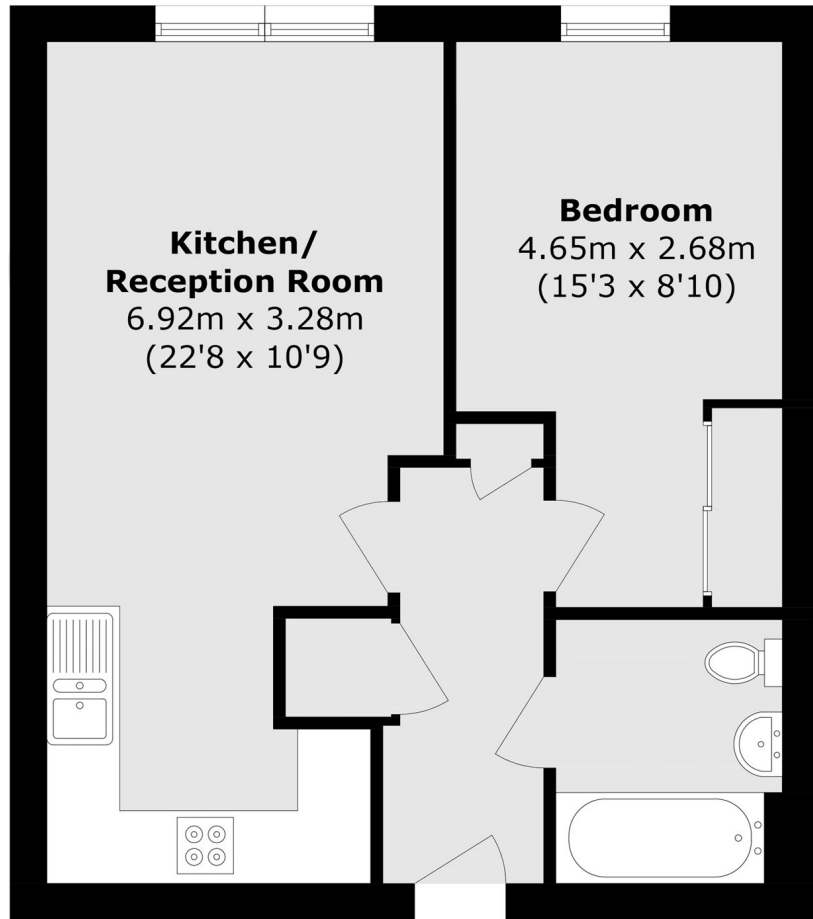

Total Area (approx.): 41.7 sq. m (448.8 sq. ft)

Robertson Smith & Kempson Acton Sales  
137 High Street, Acton,  
London, W3 6LY  
020 8896 3996  
[actonsales@robertsonsmithandkempson.co.uk](mailto:actonsales@robertsonsmithandkempson.co.uk)

Energy Rating: C. We aim to make our particulars both accurate and reliable. However they are not guaranteed; nor do they form part of an offer or contract. If you require clarification on any points then please contact us, especially if you're traveling some distance to view. Please note that appliances and heating systems have not been tested and therefore no warranties can be given as to their good working order.