



## Minster Road, NW2

### £550,000

A first floor three bedroom period conversion measuring in excess of 740 sq.ft. Offering a large reception, a separate kitchen, and a bathroom. The property comes with no onward chain.

Minster Road is ideally situated on the borders of Cricklewood, Kilburn & West Hampstead. With easy access to Kilburn Underground Station (Jubilee Line) and Cricklewood Thameslink Station.

### Features

- Period Conversion
- Three Bedrooms
- Separate Kitchen
- Additional WC
- Excellent Transport Links
- Chain Free

# Minster Road, London, NW2

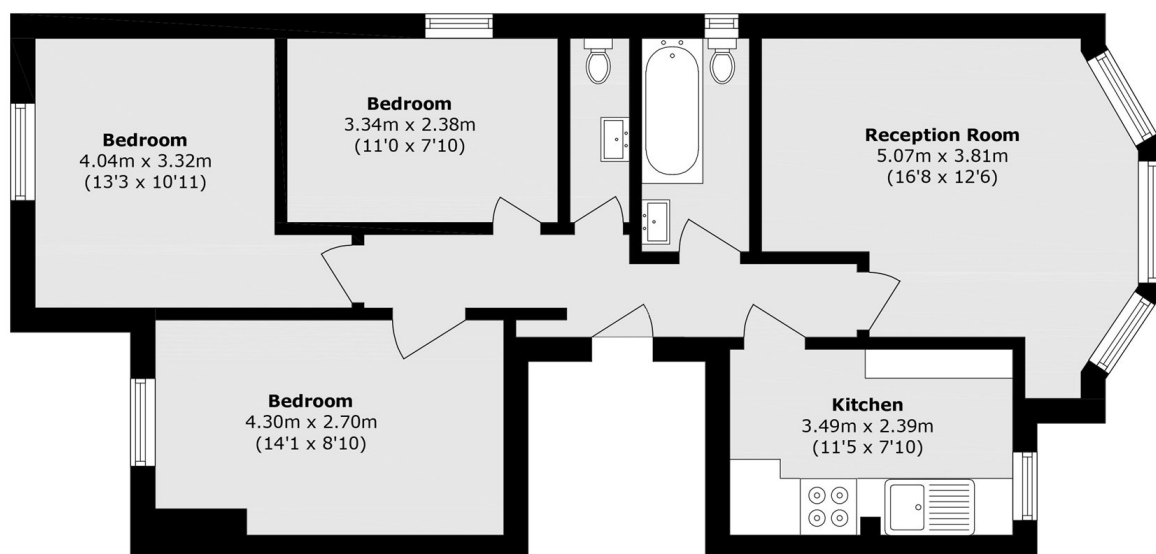

Total area (approx.): 69.5 sq. m (748.0 sq. ft)