

## LAVENDER HILL, SW11

Approx. gross internal area 455 Sq Ft. / 42.3 Sq M

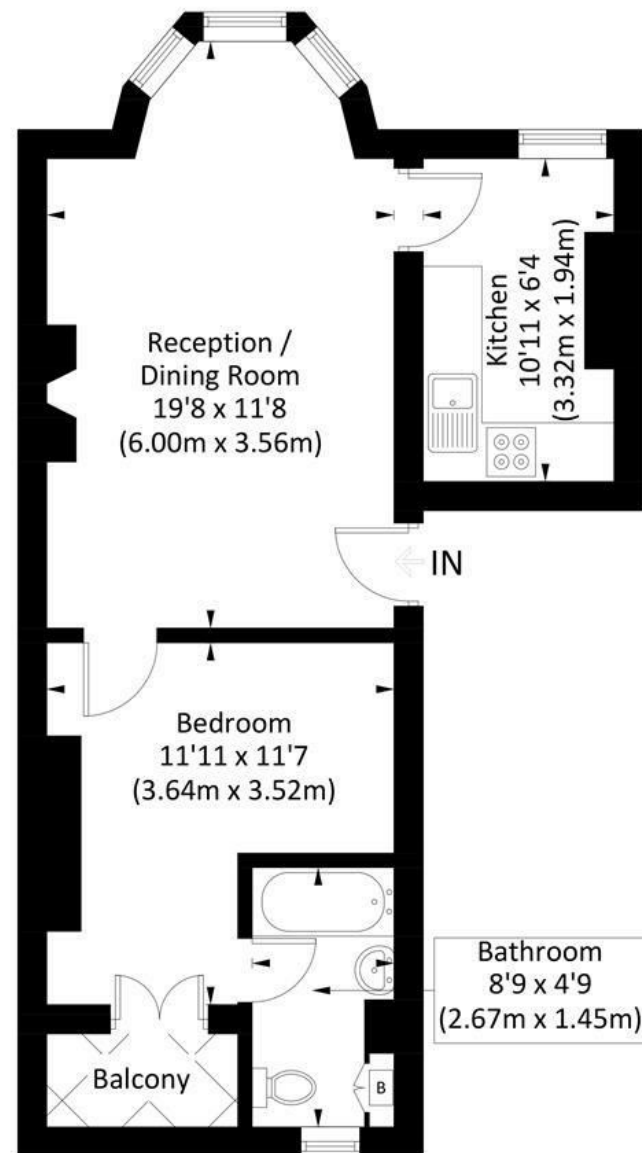

### First Floor (455 Sq Ft.)

Illustration for identification purposes only, measurements are approximate, not to scale. Fourlabs.co © 2026 (ID1315053)

**DISCLAIMER**•These particulars are intended to give a fair and substantially correct overall description for the guidance of intending purchasers and do not constitute an offer or part of a contract. Prospective purchasers and/or lessees ought to seek their own professional advice.

•All descriptions, dimensions, areas, references to condition and necessary permissions for use and occupation and other details are given in good faith and are believed to be correct, but any intending purchasers should not rely on them as statements or representations of fact, but must satisfy themselves by inspection or otherwise as to the correctness of each of them.  
•All measurements are approximate.



## Lavender Hill, London, SW11

A very smart and superbly located one bedroom apartment on the first floor of this period property in the heart of Clapham. Offered on an unfurnished basis, the accommodation comprises an entrance hallway, bright and spacious reception room, fitted kitchen, double bedroom with en suite bathroom and doors to a small private balcony. This lovely flat is ideally located for all the amenities and transport Clapham has to offer. Available now.



- FIRST FLOOR FLAT
- FITTED KITCHEN
- EN SUITE BATHROOM
- CENTRAL LOCATION
- COUNCIL TAX BAND C
- LARGE RECEPTION ROOM
- DOUBLE BEDROOM
- SMALL BALCONY
- EPC C

Per Month  
**£1,750 Per Month**

