



213 Whitchurch Road

Heath, Cardiff, CF14 3JR

£1,800 Per Month

REF: 19676176

3 BEDROOM FIRST FLOOR FLAT - £600 PER PERSON
PCM - AVAILABLE 1ST JULY 2026 - FULLY FURNISHED -
MORDERN KITCHEN AND BATHROOM - OPEN PLAN
LIVING - EQUAL SIZE BEDROOMS

- 3 bedroom first floor flat
- Modern kitchen and bathroom
- Large walk in shower
- £600 per person PCM
- £1,800 PCM total

Viewing

Please contact our Cathays Head Office on 02922331425 if you wish to arrange a viewing appointment for this property or require further information.



Floor Plan

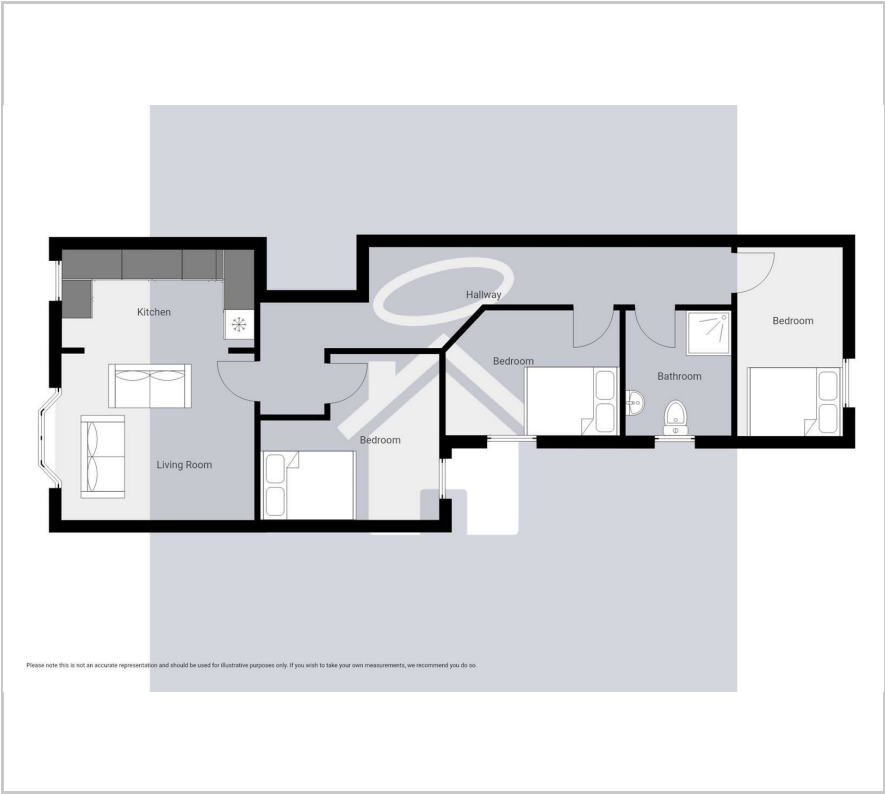

Area Map



Energy Efficiency Graph



These particulars, whilst believed to be accurate are set out as a general outline only for guidance and do not constitute any part of an offer or contract. Intending purchasers should not rely on them as statements of representation of fact, but must satisfy themselves by inspection or otherwise as to their accuracy. No person in this firm's employment has the authority to make or give any representation or warranty in respect of the property.