

# 2 Woodland Grove

Epping, Essex

Council Tax band: C

Tenure: Leasehold

- CHAIN FREE
- GROUND FLOOR APARTMENT
- LONG LEASE OF 157 YEARS
- MODERN FITTED KITCHEN
- CLOSE TO EPPING HIGH STREET
- IDEAL FIRST TIME BUY



**Entrance Hall**

**Lounge/ Diner**

16' 2" x 11' 7" (4.94m x 3.54m)

**Kitchen**

10' 2" x 5' 11" (3.10m x 1.80m)

**Bedroom One**

15' 5" x 9' 2" (4.69m x 2.79m)

**Bedroom Two**

8' 8" x 8' 4" (2.63m x 2.53m)

**Bathroom**

7' 4" x 5' 2" (2.23m x 1.58m)





# Ground Floor

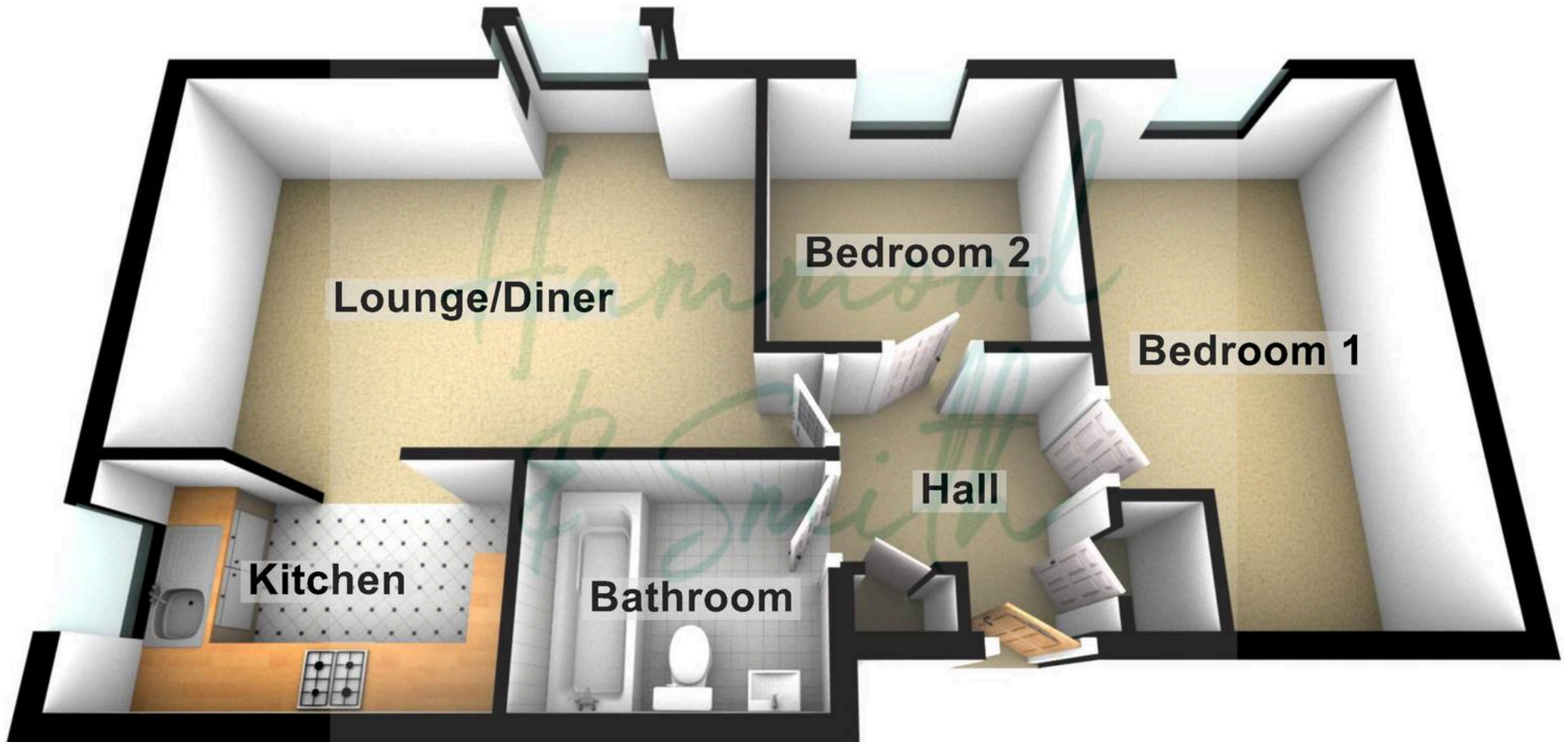

Floorplans are provided for guidance only. They are not to scale & must not form any part of a legal contract or be reproduced  
Plan produced using PlanUp.