



2 1 1

Old London Road, Hastings, TN35 5BA  
£1,200 Per Calendar Month



# Oliver & Bailey

01424 834000 | 01424 533 555

Info@oliverbaileylettings.co.uk  
www.oliverbaileylettings.co.uk

**Private entrance**

**Living room**

13'7" x 14'11" (4.15m x 4.57m)

**Kitchen**

8'9" x 12'4" (2.68m x 3.76m)

**Bedroom one**

11'8" x 13'10" (3.56m x 4.23m)

**Bedroom two**

14'10" x 9'1" (4.53m x 2.79m)

**Bathroom**

8'10" x 6'0" (2.70m x 1.85m)



**Furnished Options: Unfurnished**

**Council Tax Band: A**

**Available Date: 6th July 2026**

**Oliver  
& Bailey**

---

**RECENTLY REFURBISHED TWO BEDROOM APARTMENT... Call Robyn or Georgia at Oliver & Bailey to arrange your viewing of this beautifully presented two-bedroom top floor apartment with its own private entrance.**

Recently refurbished throughout, the apartment offers bright and spacious accommodation and is situated in the popular Ore area, within walking distance of local amenities, well-regarded schools, regular bus routes into Hastings Town Centre, and Hastings Country Park.

The property comprises a generous living room, a separate modern kitchen with an integrated oven and hob, two well-proportioned bedrooms, and a contemporary bathroom with a shower over the bath.

Further benefits include gas central heating and double glazing.

# FLOORPLAN

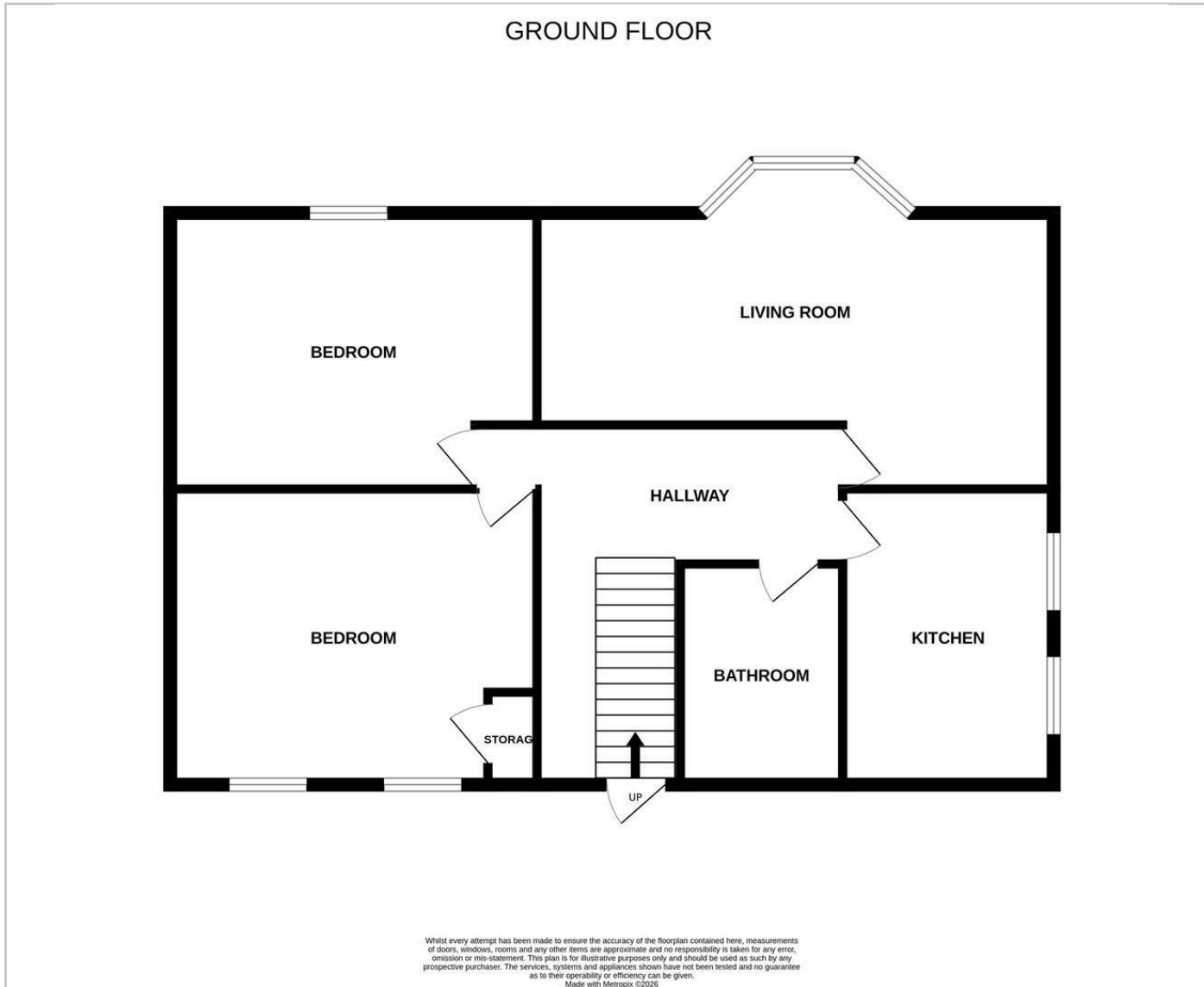

# AREA MAP

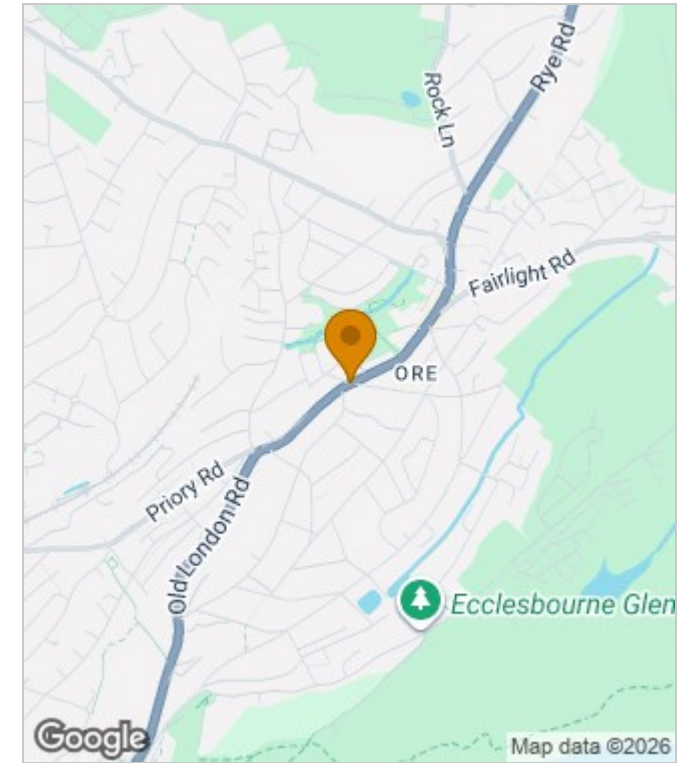

Energy Efficiency Rating		Current	Potential
Very energy efficient - lower running costs			
(92 plus) <b>A</b>			
(81-91) <b>B</b>			
(69-80) <b>C</b>			
(55-68) <b>D</b>			
(39-54) <b>E</b>			
(21-38) <b>F</b>			
(1-20) <b>G</b>			
Not energy efficient - higher running costs			
<b>England &amp; Wales</b>	EU Directive 2002/91/EC		

Environmental Impact (CO <sub>2</sub> ) Rating		Current	Potential
Very environmentally friendly - lower CO <sub>2</sub> emissions			
(92 plus) <b>A</b>			
(81-91) <b>B</b>			
(69-80) <b>C</b>			
(55-68) <b>D</b>			
(39-54) <b>E</b>			
(21-38) <b>F</b>			
(1-20) <b>G</b>			
Not environmentally friendly - higher CO <sub>2</sub> emissions			
<b>England &amp; Wales</b>	EU Directive 2002/91/EC		

These particulars, whilst believed to be accurate are set out as a general outline only for guidance and do not constitute any part of an offer or contract. Intending purchasers should not rely on them as statements of representation of fact, but must satisfy themselves by inspection or otherwise as to their accuracy. No person in this firm's employment has the authority to make or give any representation or warranty in respect of the property.