



10 The Park, Ruthin, LL15 1PL – £335,000

Tenure: Freehold | EPC: C | Council Tax: E

This property is ideal for families seeking a welcoming home, a spacious detached home with four well-proportioned bedrooms, the house boasts two inviting reception rooms, providing ample space for relaxation and entertaining guests, the property has two bathrooms conveniently located, a kitchen with utility off, large conservatory and for those with vehicles, the property offers parking for up to five cars, a rare find that adds to the convenience of this lovely home.

In summary, this detached house, presents an exceptional opportunity for anyone looking to settle in a spacious and well-appointed residence. With its ample living space, modern amenities, and convenient parking, this property is sure worth viewing.

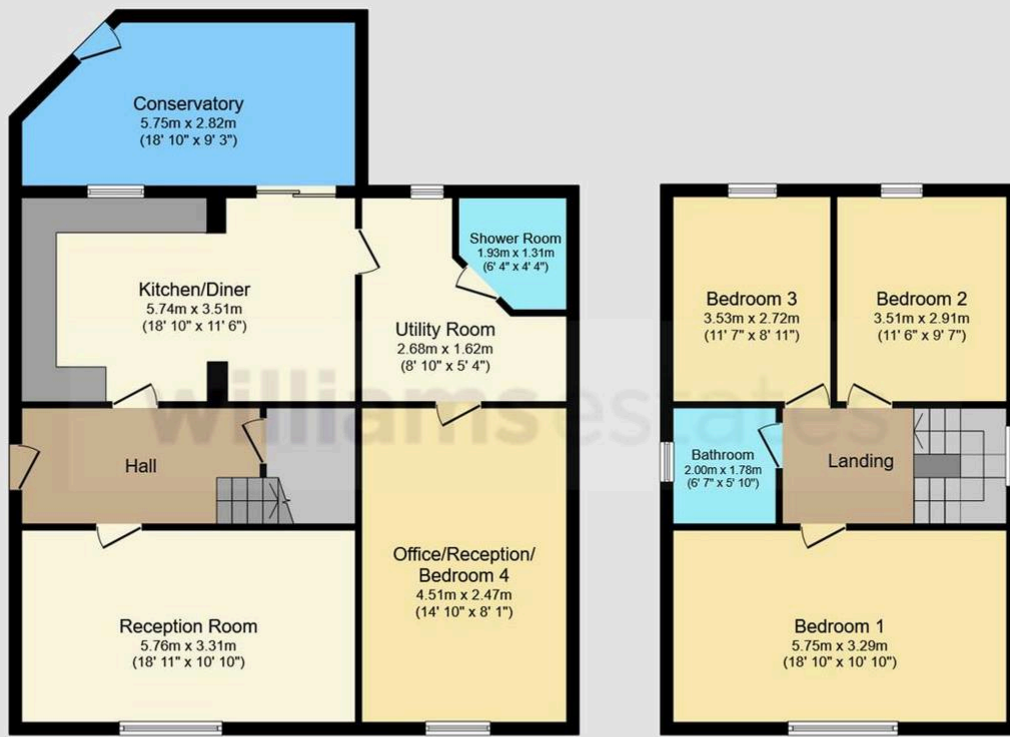

Ground Floor
 Floor area 100.6 sq.m. (1,083 sq.ft.)

First Floor
 Floor area 52.0 sq.m. (560 sq.ft.)

Total floor area: 152.6 sq.m. (1,642 sq.ft.)

This floor plan is for illustrative purposes only. It is not drawn to scale. Any measurements, floor areas (including any total floor area), openings and orientations are approximate. No details are guaranteed, they cannot be relied upon for any purpose and do not form any part of any agreement. No liability is taken for any error, omission or misstatement. A party must rely upon its own inspection(s). Powered by www.Propertybox.io

williams
 estates



YOUR FREE
PROPERTY REPORT



WE OFFER FREE ADVICE
MORTGAGES - SURVEYS - SOLICITORS