



23A Eastney Road, Portsmouth, PO4 9JA

£1,000 Per Calendar Month Council Tax Band A Deposit £1,152



1



1



D

Tully's

Floor Plan

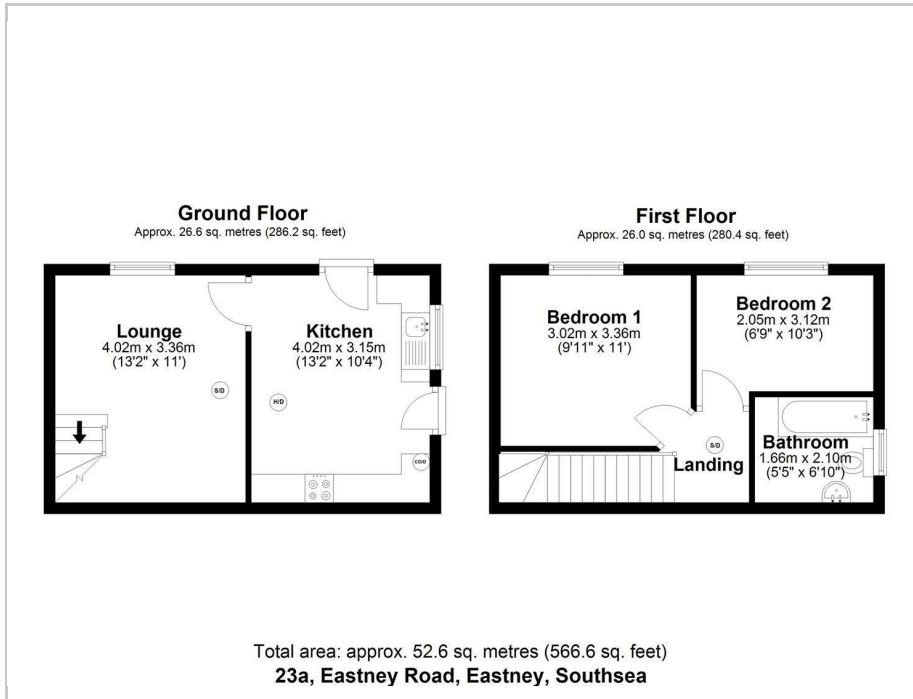

Area Map



Accommodation

- Holding deposit - £230.00
- Deposit - 1153.00
- 2 double bedrooms
- Upstairs Bathroom
- Unfurnished
- Available 1st May 2026
- Call today to arrange a viewing



Viewing

Please contact our Southsea Office on 023 9273 2241 if you wish to arrange a viewing appointment for this property or require further information.

Energy Efficiency Graph

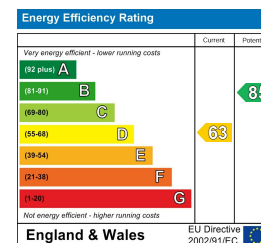

157-159 Albert Road, Southsea, Portsmouth, Hampshire, PO4 0JW
023 9273 2241 Email: tully@tullyand.co lettings@tullyand.co

Tully's