



Holloway Road

London, N19

Offers in excess £400,000

A bright and well-presented two bedroom apartment complete with a large rear roof terrace. This property boasts two bedrooms and a good-sized open-plan reception/kitchen area that leads directly out to the roof terrace. Well located for excellent amenities and transport links. Being sold chain-free.

CHESTERTONS



Holloway Road

London, N19

- Two bedrooms
- Excellent transport links
- Large rear roof terrace
- Chain free
- Two bedrooms



Holloway Road is a very good location for amenities. Transport links are excellent - boasting Archway Tube, Holloway Road overground and numerous bus routes. The area boasts a vast array of shops, pubs, cafes and Restaurants. Whittington Park is close by, as is the delightful Waterlow Park.

Tenure: Leasehold with 103 years remaining

Service Charge: £1,550 per annum

Ground Rent: £250 per annum

Local Authority: Islington

Council Tax Band: C

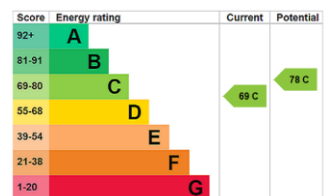

Chestertons Camden & Kentish Town Sales

99-101 Parkway

Camden

London

NW1 7PP

camden@chestertons.co.uk

020 7267 2053

chestertons.co.uk

Holloway Road

○ - Ceiling Height

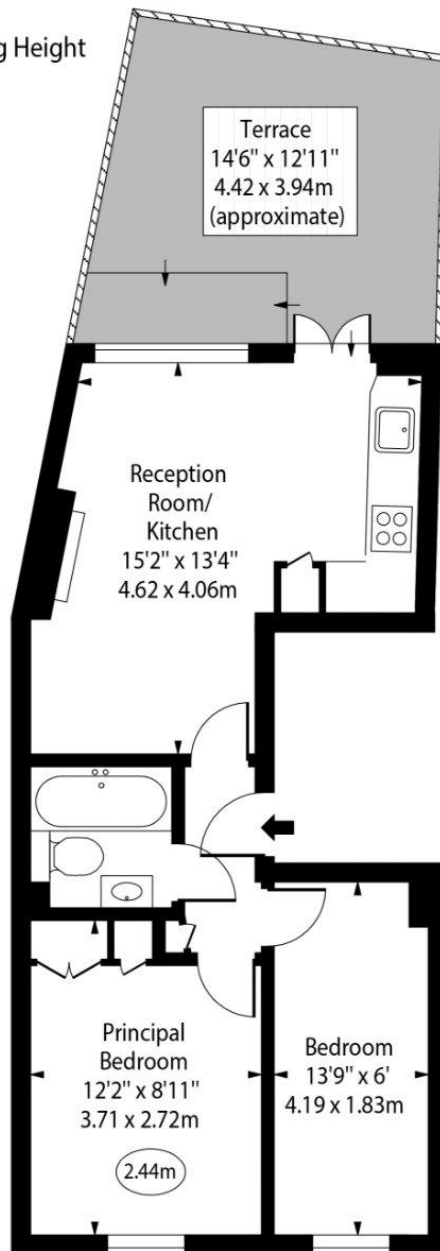

First Floor

Gross Internal Area - 443 Sq Ft - 41.15 Sq M

Approx Gross Internal Area 443 Sq Ft - 41.15 Sq M

Every attempt has been made to ensure the accuracy of the floor plan shown. However, all measurements, fixtures, fittings, and data shown are approximate interpretations and for illustrative purposes only. Measured according to the RICS. Not To Scale.

www.goldlens.co.uk

Ref. No. 031492E

