



ASPIRE

— TO MOVE —



High Street, Timsbury, BA2

Video and physical viewings available. Two bedroom flat available on Timsbury High Street which is offered unfurnished and available June 2026.

The flat is located in Timsbury, a friendly and attractive village in North East Somerset, it is a civil parish and lies around 8 miles south-west of Bath and 12 miles from Bristol.

The village maintains a pre-school and primary school and a village hall named, The Conygre hall. The hall is used for a number of events including village meetings, antique fairs and flower shows. Other amenities include a GP practice, Pharmacy Health food shop, and convenience stores. It also features a play park, tennis/netball courts, and is home to the Bowls club.

£1,375 PCM

High Street, Timsbury, BA2

- Available June 2026
- Video viewing available
- Enclosed courtyard
- Two bedroom flat
- Holding deposit - one weeks worth of rent - £317.00
- Communal garden
- Allocated parking space
- Council tax: A

Video and physical viewings available. Newly developed two bedroom flat available on Timsbury High Street which is offered unfurnished and available June 2026.

The flat is located in Timsbury, a friendly and attractive village in North East Somerset, it is a civil parish and lies around 8 miles south-west of Bath and 12 miles from Bristol.

The village maintains a pre-school and primary school and a village hall named, The Conygre hall. The hall is used for a number of events including village meetings, antique fairs and flower shows. Other amenities include a GP practice, Pharmacy Health food shop, and convenience stores. It also features a play park, tennis/netball courts, and is home to the Bowls club.

The flat is located on the ground floor. The flat consists of an open plan kitchen, living, dining room with base and wall units, cooker, gas hob, integrated fridge/freezer, slimline dishwasher and washing machine. There are two bedrooms, both of which are doubles, one that leads out onto an enclosed courtyard and the other which benefits its own ensuite shower room.

The flat is available for occupation from the beginning of June 2026 and features one allocated parking space and a video intercom system.. The flat is offered unfurnished and would best suit a single professional or couple.

Council tax band: A - £1,625.04





Floor Plan

GROUND FLOOR
615 sq.ft. (57.1 sq.m.) approx.

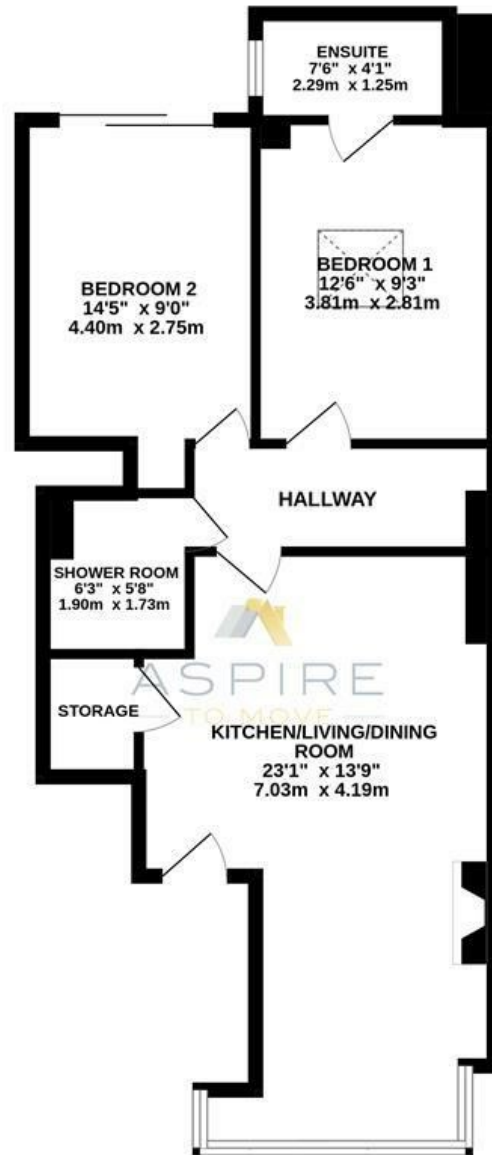

HIGH STREET, TIMSBURY, BA2

TOTAL FLOOR AREA: 615 sq.ft. (57.1 sq.m.) approx.

Whilst every attempt has been made to ensure the accuracy of the floorplan contained here, measurements of doors, windows, rooms and any other items are approximate and no responsibility is taken for any error, omission or mis-statement. This plan is for illustrative purposes only and should be used as such by any prospective purchaser. The services, systems and appliances shown have not been tested and no guarantee as to their operability or efficiency can be given.
Made with Metropix ©2023

These particulars, whilst believed to be accurate are set out as a general outline only for guidance and do not constitute any part of an offer or contract. Intending purchasers should not rely on them as statements of representation of fact, but must satisfy themselves by inspection or otherwise as to their accuracy. No person in this firm's employment has the authority to make or give any representation or warranty in respect of the property.

