

for sale

guide price **£170,000 to £180,000**

Leasehold



Strangers Lane Canterbury CT1 3XJ

Situated in popular residential location on the edge of Canterbury is this two bedroom apartment within a well maintained, purpose built block. The property provides two bedrooms, two shower rooms, kitchen and spacious lounge, ample storage space inside and out and sold with no chain.

Residential Sales & Lettings | Mortgage Services |
Conveyancing | Surveyors | Land & New Homes

- Energy Rating: C
- ***Guide Price £170,000 to £180,000***
- A spacious two bedroom apartment within purpose built block
- A popular residential location on the edge of Canterbury City



Property Details

Entrance Hall

Lounge 16' x 13' 7" (4.88m x 4.14m)

Kitchen 12' 7" x 9' 1" (3.84m x 2.77m)

Bedroom One 13' 7" x 10' 5" (4.14m x 3.17m)

Bedroom Two 11' 8" x 7' 8" (3.56m x 2.34m)

Shower Room One 5' 6" x 4' 9" (1.68m x 1.45m)

Shower Room Two 5' 6" x 2' 6" (1.68m x 0.76m)

Communal Gardens

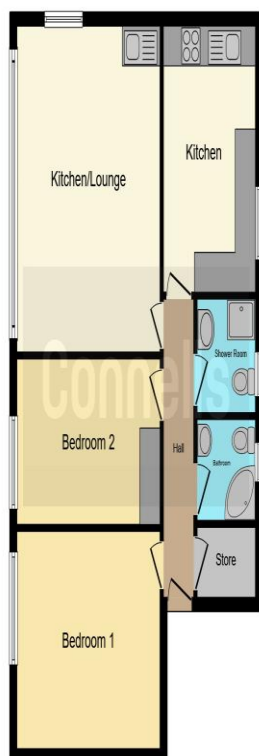

To view this property please contact Connells on

T 01227 764 720
E canterbury@connells.co.uk

29-30 Watling Street
CANTERBURY CT1 2UD

Property Ref: CBY406713 - 0006

Tenure:Leasehold EPC Rating: C

Council Tax Band: B Service Charge: 780.00

Ground Rent: Ask Agent

This is a Leasehold property with details as follows; Term of Lease 125 years from 22 Feb 1984. Should you require further information please contact the branch. Please Note additional fees could be incurred for items such as Leasehold packs.

This floor plan is for illustrative purposes only. It is not drawn to scale. Any measurements, floor areas (including any total floor area), openings and orientation are approximate. No details are guaranteed, they cannot be relied upon for any purpose and they do not form part of any agreement. No liability is taken for any error, omission or misstatement. A party must rely upon its own inspection(s). Powered by www.focalagent.com

1. MONEY LAUNDERING REGULATIONS Intending purchasers will be asked to produce identification documentation at a later stage and we would ask for your co-operation in order that there will be no delay in agreeing the sale. 2. These particulars do not constitute part or all of an offer or contract. 3. The measurements indicated are supplied for guidance only and as such must be considered incorrect. Potential buyers are advised to recheck measurements before committing to any expense. 4. We have not tested any apparatus, equipment, fixtures, fittings or services and it is in the buyers interest to check the working condition of any appliances.

Connells Residential is registered in England and Wales under company number 1489613, Registered Office is Cumbria House, 16-20 Hockliffe Street, Leighton Buzzard, Bedfordshire, LU7 1GN. VAT Registration Number is 500 2481 05.

see all our properties at www.connells.co.uk | www.rightmove.co.uk | www.zoopla.co.uk