



Granby Road, London SE9

London

£230,000

Granby Road

London

Ground-floor one-bed flat in Eltham with spacious rooms, large private garden, scope for modernisation, chain-free sale, and good transport links. Ideal for buyers seeking a project.

Council Tax band: C

Tenure: Leasehold

EPC Energy Efficiency Rating: D

EPC Environmental Impact Rating: C

- One-bedroom ground floor flat
- Private rear garden
- Chain-free sale
- Ideal renovation project
- Excellent transport links nearby
- Gas Central Heating







Approximate Gross Internal Area
44.90 sq m / 483.29 sq ft

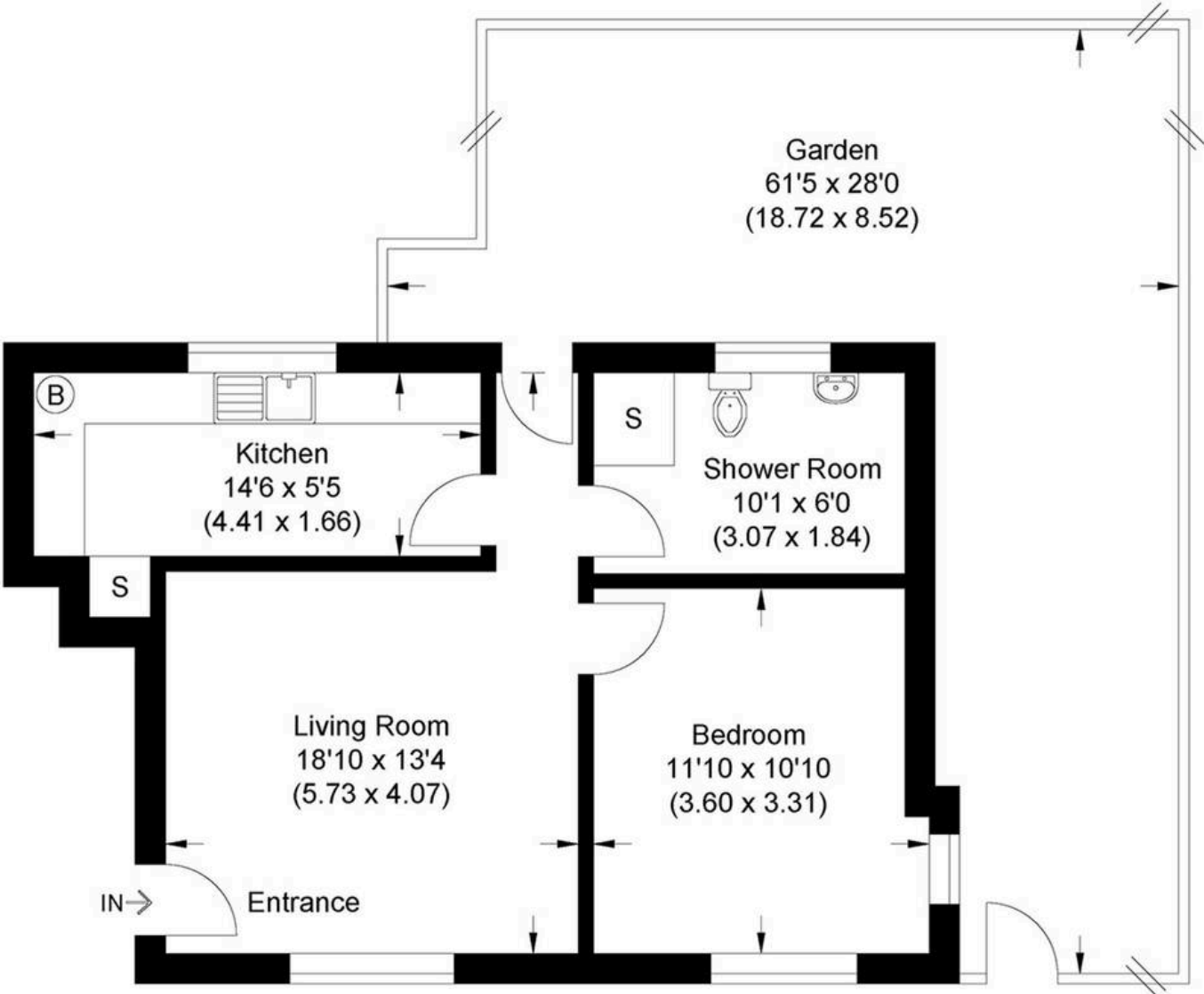

Illustration for identification purposes only, measurements are approximate, not to scale.



MA-Residential

1st Floor Romer House, 132 Lewisham High Street, London - SE13 6EE

020 8264 4464

hello@ma-residential.com

ma-residential.com