

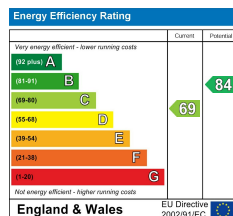

Kenilworth Road, Edgware, HA8 8XD
£699,950 Freehold Council Tax Band

REAL ESTATES
Est.1981

Estate Agents · Residential Sales · Investments · Lettings



Total Floor Area 59.11m ²	Total Floor Area 46.99m ²
---	---

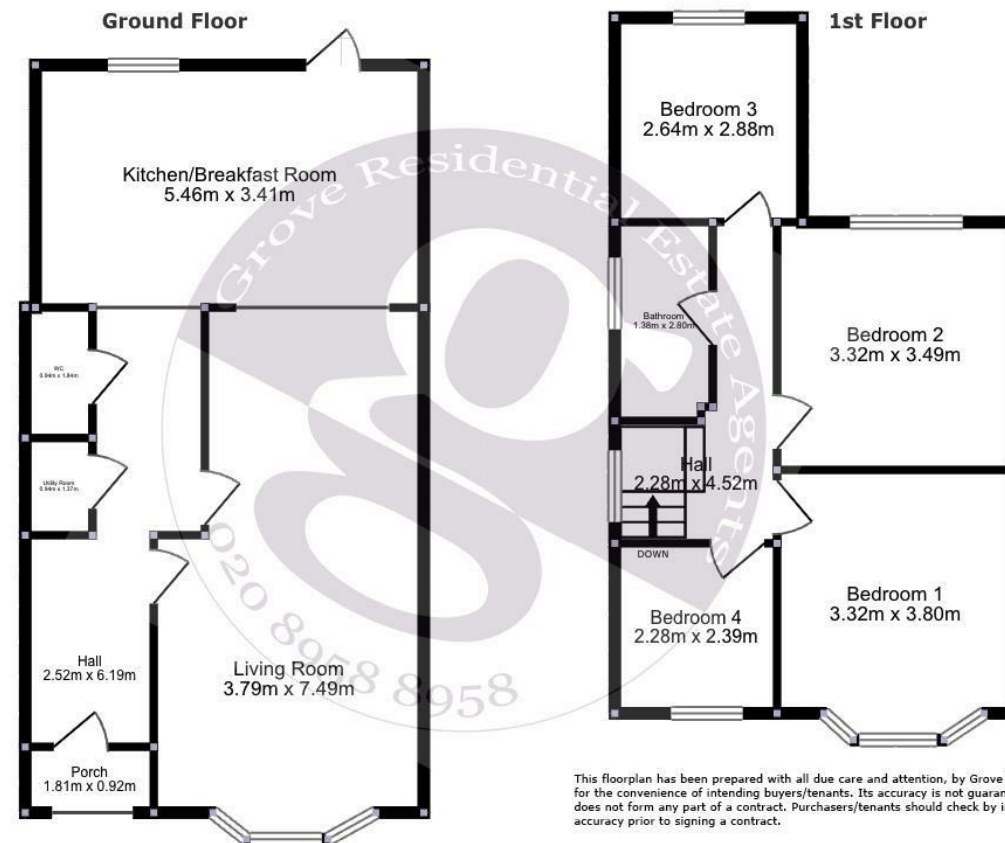

This floorplan has been prepared with all due care and attention, by Grove Residential for the convenience of intending buyers/tenants. Its accuracy is not guaranteed and it does not form any part of a contract. Purchasers/tenants should check by inspection its accuracy prior to signing a contract.