



Highfield Rise

Chester Le Street DH3 3UY

£210,000





This footer paragraph is an example only and should not be relied upon as complying with current legislation. These particulars, whilst believed to be accurate are set out as a general outline only for guidance and do not constitute any part of an offer or contract. Intending purchasers should not rely on them as statements of representation of fact, but must satisfy themselves by inspection or otherwise as to their accuracy. No person in this firm's employment has the authority to make or give any representation or warranty in respect of the property.

Highfield Rise

Chester Le Street DH3 3UY



Nestled in the sought-after residential area of Highfield Rise, Chester-le-Street, this impressive townhouse offers a perfect blend of comfort and modern living. With four spacious bedrooms and three well-appointed bathrooms, this family-sized home is ideal for those seeking ample space and convenience.

As you enter the property, you are greeted by a welcoming entrance hall that leads to a thoughtfully designed ground floor. Here, you will find a convenient WC and a stylish fitted white breakfast kitchen, complete with built-in hob, oven, and extractor. The generous lounge, bathed in natural light from the French doors, opens seamlessly to the rear garden, creating an inviting space for relaxation and entertaining.

The first floor boasts three well-proportioned bedrooms, including two doubles and a single, providing plenty of room for family or guests. Ascend to the top floor, where the main bedroom awaits, featuring en suite facilities and a dressing room, offering a private retreat for the homeowners.

This property has been well maintained, featuring

UPVC double glazed windows/Velux windows and gas central heating via radiators, ensuring comfort throughout the seasons. The three-storey layout provides an abundance of living accommodation, making it a perfect choice for families.

Early viewing is highly recommended to fully appreciate the charm and practicality of this delightful home. To arrange a viewing, please do not hesitate to contact us at 0191 3729898. This is an opportunity not to be missed!

Freehold
EPC rating C

ENTRANCE HALL

GROUND FLOOR WC

BREAKFAST KITCHEN

LOUNGE

15'4" x 12'2" (4.67m x 3.71m)

FIRST FLOOR

BEDROOM 2

15'6" x 12'11" (4.72m x 3.94m)

BEDROOM 3

10'3" x 8'9" (3.12m x 2.67m)

BEDROOM 4

7'4" x 6'8" (2.24m x 2.03m)

SECOND FLOOR

MAIN BEDROOM

13'11" x 12'2" (4.24m x 3.71m)

EN SUITE

DRESSING ROOM

OUTSIDE

GROUND FLOOR

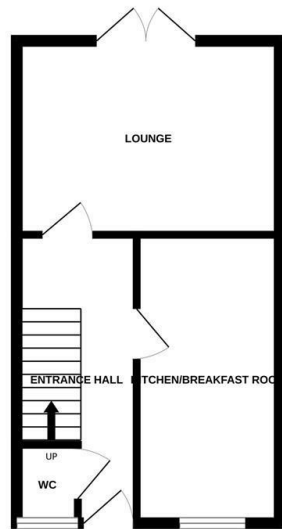

1ST FLOOR

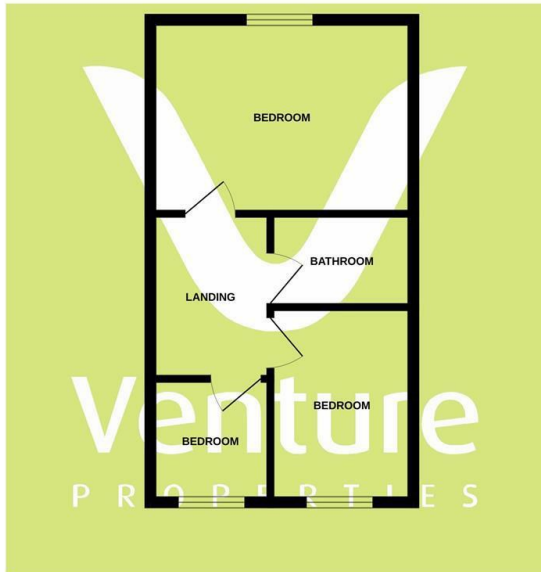

2ND FLOOR

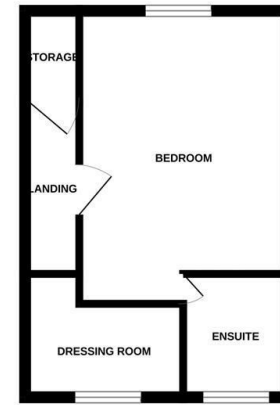

Whilst every attempt has been made to ensure the accuracy of the floorplan contained here, measurements of doors, windows, rooms and any other items are approximate and no responsibility is taken for any error, omission or mis-statement. This plan is for illustrative purposes only and should be used as such by any prospective purchaser. The services, systems and appliances shown have not been tested and no guarantee as to their operability or efficiency can be given.
Made with Metropix ©2026

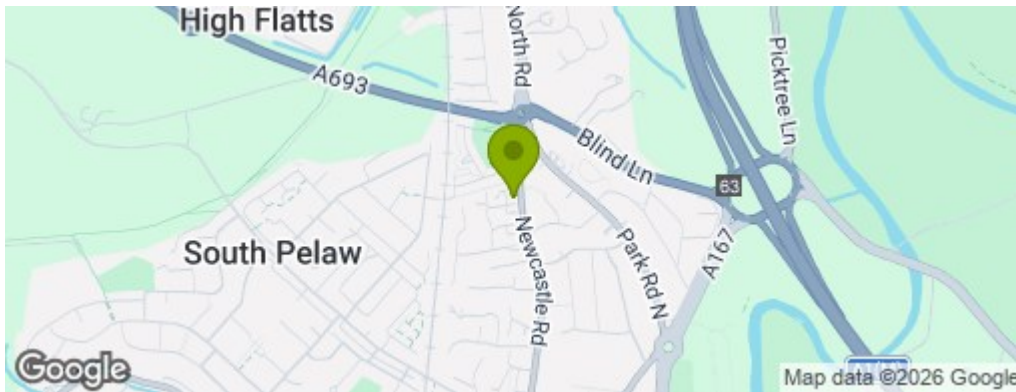

Property Information

0191 372 9898

Suite 6, 15 North Bums, Chester-le-Street, County Durham, DH3 3TF
sales.cls@venturepropertiesuk.com