



Peter  
Buswell  
Independent Family Estate Agents



High Street, Flimwell, Wadhurst, TN5 7PB

Guide Price £325,000

3 1 1





*Guide Price £325,000 to £350,000*

Positioned behind a generous driveway, this well-presented home offers bright, welcoming accommodation. A practical porch opens into a spacious entrance hall that leads directly into the open-plan living and dining area, an inviting dual-aspect space ideal for both relaxation and entertaining, with access to the garden. The adjoining kitchen is thoughtfully arranged and connects to a versatile sun/utility room, which enjoys an outlook over the garden and provides excellent additional space for everyday household needs.

Upstairs, the landing leads to three well-proportioned bedrooms, all filled with natural light, along with a family bathroom.

The rear garden is a wonderful extension of the living space, featuring a patio seating area that steps down to a garden laid to lawn, complete with side access to the shared driveway leading to the garage.



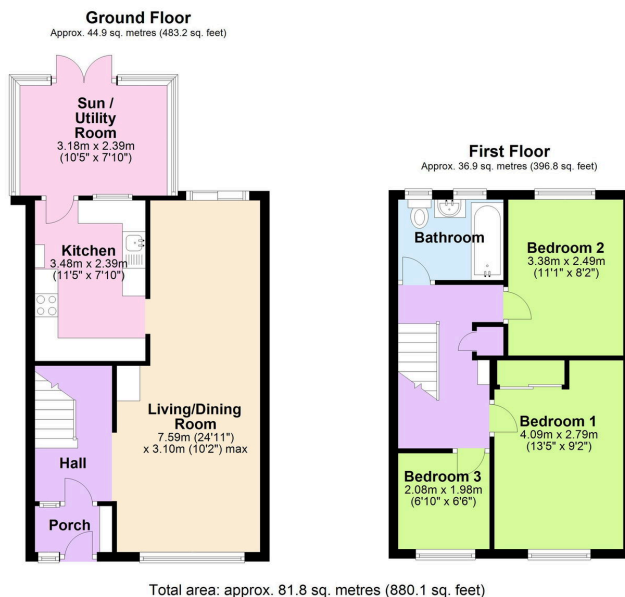

- GUIDE PRICE £325,000 TO £350,000
- WELL PRESENTED ACCOMMODATION
- SUN/UTILITY ROOM
- SINGLE EN-BLOC GARAGE
- EPC RATING C
- THREE BEDROOM END OF TERRACE HOUSE
- MODERN FITTED KITCHEN
- MODERN WHITE BATHROOM SUITE
- PARKING FOR SEVERAL VEHICLES TO FRONT
- COUNCIL BAND C

