

19 Greenford Avenue, Hanwell, London, W7 1LD
020 8567 3219



Leasehold / Apartment

Chevy Road

£399,950

A spacious 3bedroom ground floor apartment with a most impressive living space and much character, in this exclusive gated development on the Hanwell borders with secure parking and well kept communal gardens, within easy walking distance of the Elizabeth Line. Attractively offered CHAIN FREE.

- Spacious and characterful ground floor apartment
- Light and airy reception room
- Well equipped fitted kitchen zone
- 3 bedrooms
- En-suite shower-room
- Modern bathroom
- Original architectural features
- Landscaped communal gardens
- Gated off street parking
- Newly extended lease



Leasehold / Apartment

Chevy Road, UB2 4UW

£399,950

A well presented and exceptionally spacious apartment, enhanced by high ceilings and an abundance of light via original arched windows, conveniently located on the ground floor of this Victorian Grade II listed building. The bright and airy accommodation includes a deep hallway, a vast reception room with stripped timber floorboards, character archway pillars and tall original arched windows, open plan to a well equipped, cream gloss fitted kitchen with black granite worksurfaces and breakfast bar. There are three bedrooms, the master with high sash windows and a smart en-suite shower-room. There is also a modern family sized bathroom. Neutrally decorated throughout complimenting wood flooring and fitted carpets, additional benefits include gas central heating (with 'Megaflo' pressurised hot water cylinder), a video entry phone, use of landscaped communal gardens and gated off road parking. Offered chain free with the security of a newly extended lease on completion.

Osterley Gardens is a popular and well established, gated development of luxury apartments set in well maintained and landscaped gardens. Situated just off the Uxbridge Road on the Hanwell borders close to local amenities and various speedy bus services. Within easy reach of Hanwell Mainline Station (for the excellent Elizabeth Line) and also Boston Manor Piccadilly Line station giving easy access to Central London and Heathrow Airport. The area is also served by a local shop and post office, literally just across the road from the development.



19 Greenford Avenue, Hanwell, London, W7 1LD
020 8567 3219

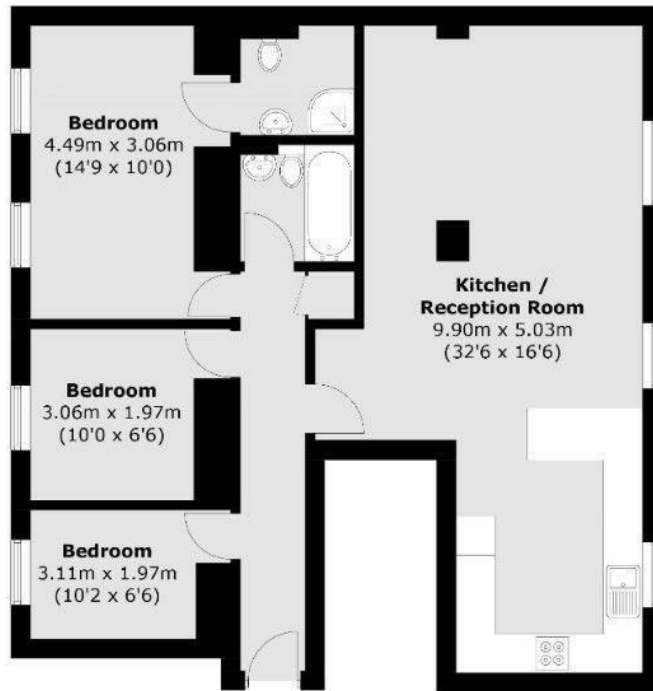

Total area (approx.): 82.1 sq. m (883.7 sq. ft)

Council Tax Band

C

Energy Performance Graph

| Energy Efficiency Rating | | Current | Potential |
|----------------------------------------------------|-------------------------|---------|-----------|
| <i>Very energy efficient - lower running costs</i> | | | |
| (92 plus) A | | | |
| (81-91) B | | | |
| (69-80) C | | | |
| (55-68) D | | | |
| (39-54) E | | | |
| (21-38) F | | | |
| (1-20) G | | | |
| <i>Not energy efficient - higher running costs</i> | | | |
| England & Wales | EU Directive 2002/91/EC | | |

Call us on

020 8567 3219

hanwellsales@sintonandrews.co.uk

www.sintonandrews.co.uk

Agents Note: Whilst every care has been taken to prepare these particulars, they are for guidance purposes only. All measurements are approximate and are for general guidance purposes only and whilst every care has been taken to ensure their accuracy, they should not be relied upon and potential buyers are advised to recheck the measurements.