



Cannonbridge Grand Avenue

East Pakefield, Lowestoft, NR33 7AR

Asking Price £425,000



## Cannonbridge Grand Avenue

East Pakefield, Lowestoft, NR33 7AR

**\*\*\* STUNNING AND UNIQUE DOUBLE WIDTH DETACHED BUNGALOW WITH CENTRAL GARAGE \*\*\*** Aldreds are delighted to offer this large 3 bedroomed detached bungalow situated in this very desirable East Pakefield location being within a very short walk of Pakefield Beach. This superb bungalow has been individually built and designed and offers amazing living space which includes a wide T-shaped entrance hall, open plan kitchen/diner with log burner and wide opening leading in to the spacious lounge. There are 3 good sized double bedrooms and an amazing family bathroom with free standing bath and an over sized shower cubicle. plus a second toilet leading off bedroom three. There is also the benefit of a central integral garage with electric roller door. To the outside of the property there is a range of wrap around gardens which are laid to lawn with raised decked seating area. This bungalow really is in turn key condition with tasteful decorations, quality fitted Karndean floor coverings and quality fixtures and fittings throughout. A viewing is strongly recommended to appreciate the amazing living space and the close proximity to all local amenities and Pakefield Beach. Early viewing advised.

### Entrance Hall

Karndean flooring, radiator, 2 x storage cupboards, Composite entrance door.

### Lounge

19'8 x 8'10 (5.99m x 2.69m)

Karndean Flooring, radiator, power points, Upvc double glazed window, sliding doors leading to rear garden, loft access with loft space and ladder, opening to Kitchen/Diner.

### Kitchen/Diner

24'11 x 11'2 (7.59m x 3.40m)

Karndean Flooring, radiator, quality fitted kitchen units, integrated appliances which include dishwasher, fridge, four burner gas hob, oven and grill, extractor fan, ceramic butler style sink, power points, 2 x Upvc double glazed windows, Upvc sliding door leading to the front garden. Large open plan dining and sitting area with beautifully installed log burner.





**Bedroom 1**  
15'5 x 13'9 (4.70m x 4.19m)

Karndean flooring, radiator, Upvc double glazed windows, power points, opening leading to a dressing room.

**Bedroom 2**  
11'2 x 7'10 (3.40m x 2.39m)

Karndean flooring, power points, radiator, Upvc double glazed window.

**Bedroom 3**  
10'10 x 8'10 (3.30m x 2.69m)

Karndean flooring, power points, Upvc double glazed window, radiator.

**Second Toilet**

A second toilet is located ensuite to bedroom 3 - With low level WC and hand basin

**Bathroom**

Ceramic tiled flooring, underfloor heating, Upvc double glazed window, Part tiled walls, low level W.C, vanity sink unit, free standing roll top bath, shower with glass enclosure.

**Outside**

There is a double width garden. To the left hand side there is a brick weave driveway with further shingle driveway providing ample off road parking for a variety of cars or leisure vehicles, This leads to a central brick built integral garage with electric roller door, power points and lighting, all enclosed by timber stable style gates. To the right hand side frontage there is fully enclosed, laid to lawn with raised decked seating area with ample space for bistro style dining, then to the rear and side of the property there is a further range of lawned gardens with a full range of specimen flower and shrub borders. This is all enclosed by high shrubs and fencing.

**Tenure And Services**

Council Tax Band - D  
Freehold  
Mains Electric Gas Water And Drainage



## Floor Plan

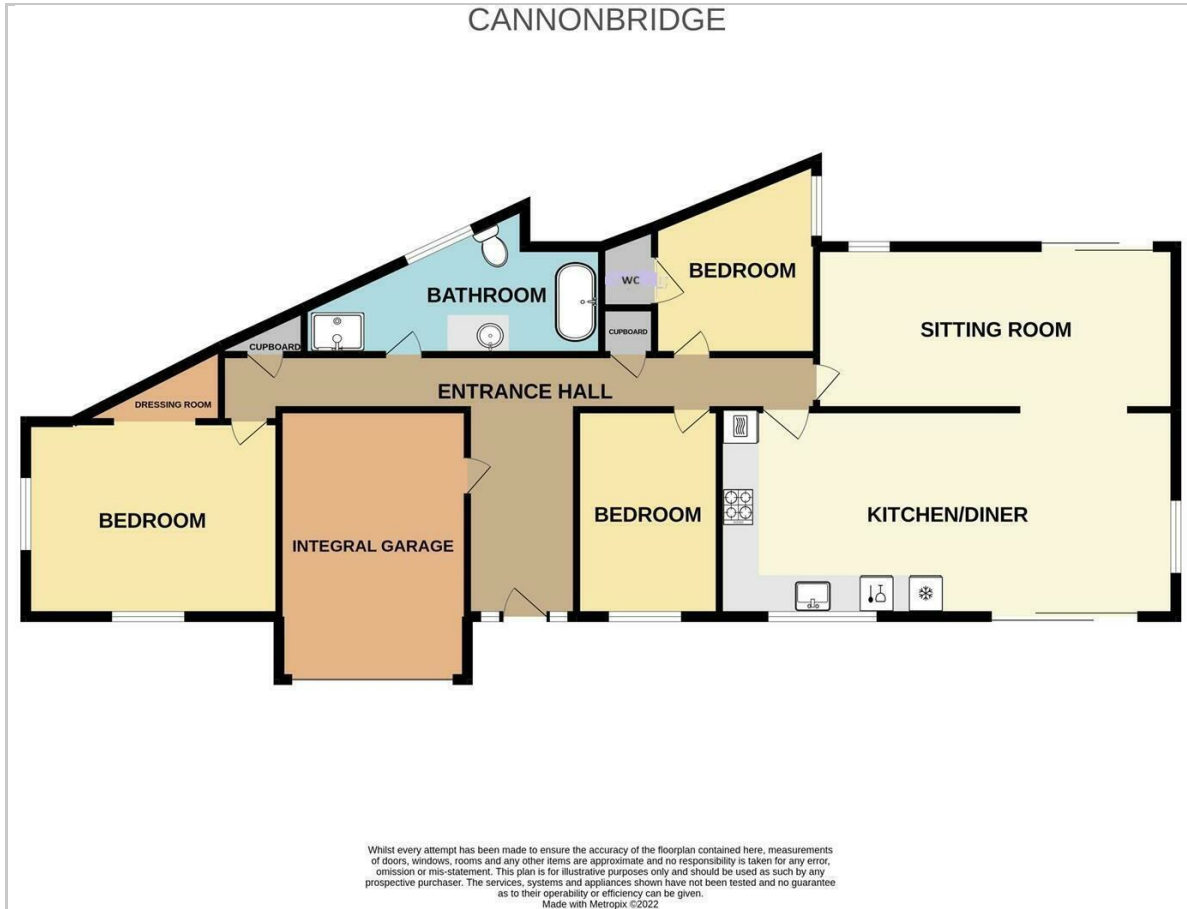

## Area Map



## Energy Efficiency Graph

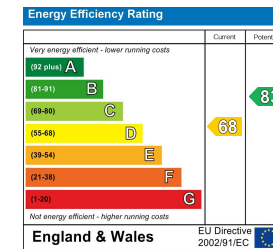

## Viewing

Please contact our Aldreds Lowestoft Office on 01502 565432 if you wish to arrange a viewing appointment for this property or require further information.

### Disclaimer

These particulars are issued on an understanding that all negotiations shall be conducted through Messrs. Aldreds. Please note: Messrs. Aldreds for themselves and for the vendors or lessors of this property whose agents they are given notice that: 1. Particulars are set out as a general outline only for guidance of intending purchasers or lessees, and do not constitute nor constitute part of, an offer or contract. 2. All descriptions, dimensions, references to condition and necessary permissions for use and occupation, and other details are given without responsibility and any intending purchasers or tenants should not rely on them as statements or representations of fact but must satisfy themselves by inspection or otherwise as to the correctness of each of them. 3. No person in the employment of Messrs. Aldreds has any authority to make or give any representation or warranty whatever in relation to this property. 4. If you are proposing to visit the property and are travelling some distance please check with Aldreds on the issue of availability prior to travelling. 5. Aldreds Property Consultants and associated services may offer additional services to the prospective purchaser for which they will be entitled to receive a commission.

Aldreds are pleased to be working with Mortgage Advice Bureau. They're an award-winning mortgage broker with over 1,400 advisers across the UK, and have access to over 12,000 mortgage products from over 90 lenders. Aldreds Estate Agents Ltd receive a commission of £200 on each completed case. Your home may be repossessed if you do not keep up repayments on your mortgage. There may be a fee for mortgage advice. The actual amount you pay will depend upon your circumstances. The fee is up to 1%, but a typical fee is 0.3% of the amount borrowed. Mortgage Advice Bureau is a trading name of Mortgage Seeker Limited which is an appointed representative of Mortgage Advice Bureau Limited and Mortgage Advice Bureau (Derby) Limited which are authorised and regulated by the Financial Conduct Authority. Mortgage Seeker Limited Registered Office: Lovewell Blake, Sixty Six North Quay, Great Yarmouth, Norfolk, NR30 1HE. Registered in England Number: 03721415. 6. Potential purchasers should check with their providers that the broadband and mobile phone coverage they would require is available.

143 London Road North, Lowestoft, Suffolk, NR32 1NE  
Tel: 01502 565432 Email: [lowestoft@aldreds.co.uk](mailto:lowestoft@aldreds.co.uk) <https://www.aldreds.co.uk/>

Registered in England Reg. No. 08945751 Registered Office: 66 North Quay, Great Yarmouth, Norfolk NR30 1HE Directors: Mark Duffield B.S.c. FRICS. Dan Crawley MNAEA Paul Lambert MNAEA