

GROUND FLOOR
416 sq.ft. (38.7 sq.m.) approx.

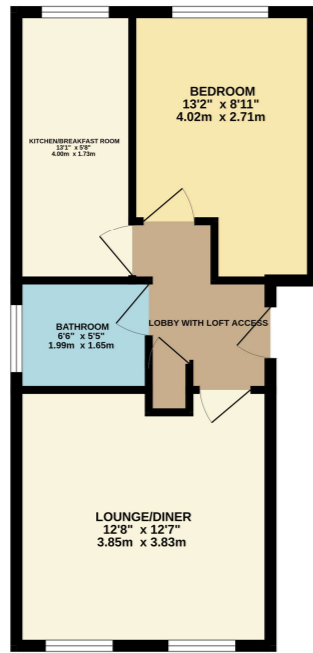

TOTAL FLOOR AREA: 416 sq.ft. (38.7 sq.m.) approx.
While every attempt has been made to ensure the accuracy of the floorplan, measurements of doors, windows, rooms and any other items are approximate and no responsibility is taken for any error, omission or misstatement. This plan is for guidance purposes only and should be used as such for any prospective purchase. The services, systems and appliances shown have not been tested and no guarantee as to their operability or efficiency can be given.
Made with Metronom 0025

THINKING OF SELLING OR TRYING TO SELL?

- Family Firm Established since 1980
- Extensive Buyer Register
- All Homes Visibly Marketed from Team Agencies in Essex & LONDON
- Accompanied Viewings
- Excellent photography & Floorplans
- Highly Experienced Agency, 1000's successfully SOLD



Energy Efficiency Rating		Current	Potential
Very energy efficient - lower running costs			
(92+)	A		
(81-91)	B		
(69-80)	C		75
(55-68)	D	60	
(39-54)	E		
(21-38)	F		
(1-20)	G		
Not energy efficient - higher running costs			
England, Scotland & Wales		EU Directive 2002/91/EC	



St. Margarets Avenue, Stanford-Le-Hope, Essex, SS17 0EW | Offers Over: £170,000

- 900 + year lease remaining
- Loft access + Upvc double glazing
- No ground rent/service charge
- Close to Train Station + shops
- Parking and communal garden
- No Onward Chain



19 Kings Parade, King Street, Stanford-le-Hope, Essex, SS17 0HP
01375 676655 sales@johncottis.co.uk www.johncottis.co.uk

Registered Proprietors Temp-Green LTD., Trading as John Cottis & Co. Registered in England No. 1534107
Registered Office: 21 Lodge Lane, Grays, Essex, RM17 5RY

The Consumer Protection from Unfair Trading Regulations 2008 (CPRs). These details are for guidance only and complete accuracy cannot be guaranteed. If there is any point, which is of particular importance, verification should be obtained. They do not constitute a contract or part of a contract. All measurements are approximate. No guarantee can be given with regard to planning permissions or fitness for purpose. No apparatus, equipment, fixture or fitting has been tested. Items shown in photographs are NOT necessarily included. Interested Parties are advised to check availability and make an appointment to view before travelling to see a property.

900 + year lease, parking, communal garden and close by Train Station at this 1 bedroom first floor flat with loft access, upvc double glazing, separate kitchen/breakfast and No Onward Chain!

Communal Entrance:
With stairs to the first floor communal landing with access to our clients home and just one other property.

Entrance Lobby:
Access to loft space. Built-in cupboard housing hot water cylinder. Doors to accommodation.

Lounge/Diner: 12'8" x 12'7" (3.86m x 3.84m)
Two Upvc double glazed window to front. Well presented lounge and dining with fitted carpet and ceiling with inset lighting.

Kitchen/Breakfast Room: 13'1" x 5'8" (4m x 1.73m)
Upvc double glazed window to rear. A separate from lounge kitchen/breakfast room with fitted kitchen, part tiled walls and selection of appliances to remain.

Bedroom: 13'2" max x 8'11" (4.01m max x 2.72m)
Upvc double glazed window to rear. Fitted carpet. Mirrored door wardrobe included in this well sized bedroom.

Bathroom: 6'6" x 5'5" (1.98m x 1.65m)
Upvc double glazed window to side. Wood themed flooring. White bath suite comprising: bath with shower mixer tap and splash screen, low flush wc and wash hand basin. Part tiled walls.

Loft Space:
Accessed from entrance lobby.

Parking:
We understand from our client 2 parking spaces are provided (solicitors to verify).

Communal Garden:
We understand from our client there is a communal garden (solicitors to verify).

Lease Information:
We understand from our client the lease has over 900 years remaining and there is no ground rent or monthly service charge (solicitors to verify).

