



Love Lane | Rugeley | WS15 2HL

£130,000

 **Webbs**
estate agents

Summary

** POPULAR RESIDENTIAL PARK HOME SITE ** WELL PRESENTED THROUGHOUT ** OPEN PLAN KITCHEN LIVING AREA ** ONE BEDROOM ** BATHROOM ** ALLOCATED PARKING SPACE ** CLOSE TO AMENITIES ** OVER 50'S DEVELOPMENT ** CANALSIDE SETTING ** VIEWING ADVISED **

WEBBS ESTATE AGENTS are pleased to market this well presented, one bedroom park home, located on a popular residential site on Love Lane. Located close to amenities, useful transport links, canalside walks and much more! The property is situated on a over 50's development. The internal accommodation briefly comprises; open plan kitchen living area, one bedroom and a bathroom. The property also benefits from one allocated parking space.

Key Features

- POPULAR RESIDENTIAL PARK HOME SITE
- OPEN PLAN KITCHEN LIVING AREA
- BATHROOM
- CLOSE TO AMENITIES
- CANALSIDE SETTING
- WELL PRESENTED THROUGHOUT
- ONE BEDROOM
- ALLOCATED PARKING SPACE
- OVER 50'S DEVELOPMENT
- VIEWING ADVISED

Rooms and Dimensions

Kitchen/ Living Area

19'0 x 11'7 (5.79m x 3.53m)

Bedroom

11'5 x 9'7 (3.48m x 2.92m)

Bathroom

7'3 x 7'6 (2.21m x 2.29m)

Agents Note





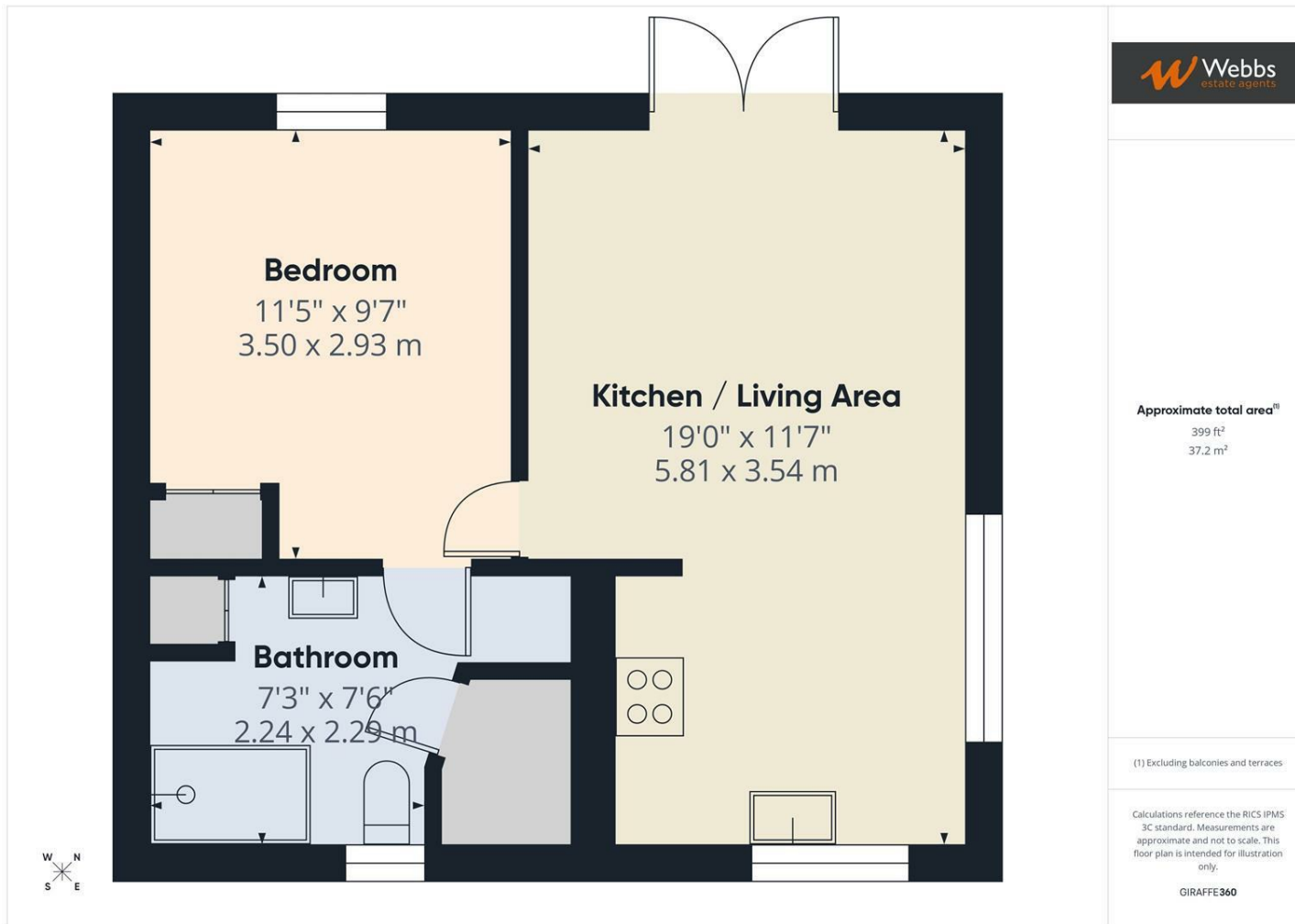

Webbs Estate Agents - endeavour to maintain accurate depictions of properties in Virtual Tours, Floor Plans and descriptions, however, these are intended only as a guide and purchasers must satisfy themselves by personal inspection.