



Bromfield Court

Jamaica Road, SE16

£3,200 per month
(£738.46 per week)

Situated on Jamaica Road, just a short walk from London Underground, this well-proportioned split-level apartment offers generous living space and the benefit of a private rear garden.

CHESTERTONS



Bromfield Court

Jamaica Road, SE16

- THREE BEDROOMS
- MODERN BATHROOM
- FURNISHED
- PRIVATE GARDEN



Situated on Jamaica Road, just a short walk from London Underground, this well-proportioned split-level apartment offers generous living space and the benefit of a private rear garden.

The accommodation is arranged across two levels and comprises a spacious reception room with ample space for dining, opening directly onto the garden via French doors. A separate kitchen provides a breakfast area together with a range of fitted units and integrated appliances, including a dishwasher. Additional storage is available on the ground floor.

The upper level features well-sized double bedrooms, a contemporary family bathroom, and further built-in storage.

The property is particularly well located for transport links, with Bermondsey Station approximately two minutes away on foot, offering convenient connections to London Bridge, Canary Wharf, the City, and the West End. Numerous bus services also operate nearby.

A wide selection of local amenities can be found within easy reach, including supermarkets, cafés, restaurants, and riverside venues around Butler's Wharf, Bermondsey Street, and Maltby Street Market.

Minimum Term: 12 months
Deposit Required: £3,692.31
Local Authority: London Borough of Southwark
Council Tax Band: C
EPC Rating: C
Furnished

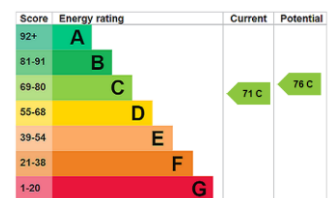

Chestertons Tower Bridge Lettings

220 Tower Bridge Road
 Tower Bridge
 London
 SE1 2UP
 towerbridgelettingsusers@chestertons.co.uk
 02073576911
 chestertons.co.uk

Additional tenant charges apply (fees apply to non-AST tenancies only)
 Tenancy Agreement Fee: £300
 References per Tenant/Guarantor: £60
 Inventory check (approx. £100 – £250 inc. VAT)
[chestertons.co.uk/property-to-rent/applicable-fees](https://www.chestertons.co.uk/property-to-rent/applicable-fees)

Bromfield Court SE16

Approx. Gross Internal Area 888 Sq Ft - 82.50 Sq M
Approx. Gross Deck Area 123 Sq Ft - 11.43 Sq M

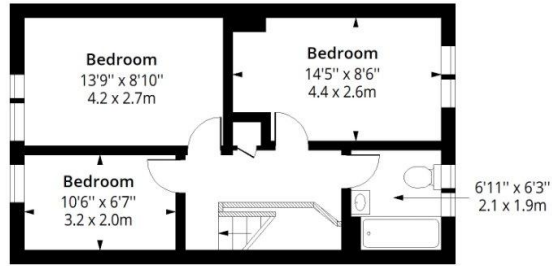

First Floor

Floor Area 464 Sq Ft - 43.11 Sq M

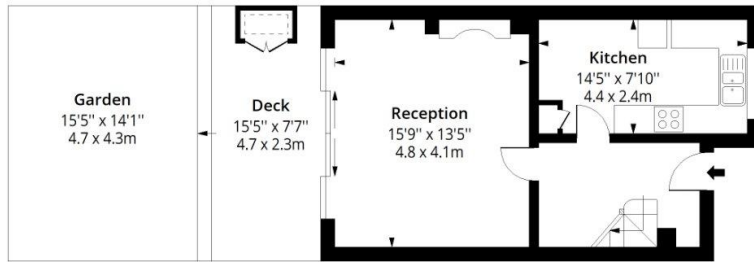

Ground Floor

Floor Area 424 Sq Ft - 39.39 Sq M



Measured according to RICS IPMS2. Floor plan is for illustrative purposes only and is not to scale. Every attempt has been made to ensure the accuracy of the floor plan shown, however all measurements, fixtures, fittings and data shown are an approximate interpretation for illustrative purposes only. 1 sq m = 10.76 sq feet.

lpaplus.com

Date: 4/6/2026

Chesterton UK Services Limited trading as Chestertons for themselves and for the vendor of this property whose agents they are, give notice that (i) these particulars do not constitute any part of an offer or contract, (ii) all statements contained within these particulars are made without responsibility on the part of Chestertons or the vendor, (iii) whilst made in good faith, none of the statements contained within these particulars are to be relied upon as a statement or representation of fact, (iv) any intending purchasers must satisfy themselves by inspection or otherwise as to the correctness of each of the statements contained within these particulars, (v) the vendor does not make or give either Chestertons or any person in their employment any authority to make or give representation or warranty whatsoever in relation to this property. Wide angle lenses may be used. ©Copyright Chestertons | Chesterton Global Ltd | Registered Office 5th Floor, The Lantern, 75 Hampstead Road, London, NW1 2PL Registered Company Number 05334580.



This paper is
100% recyclable