

Beech Avenue, Grimsby, DN33 2AZ

£850 Per Month

Council Tax Band:



Ground Floor

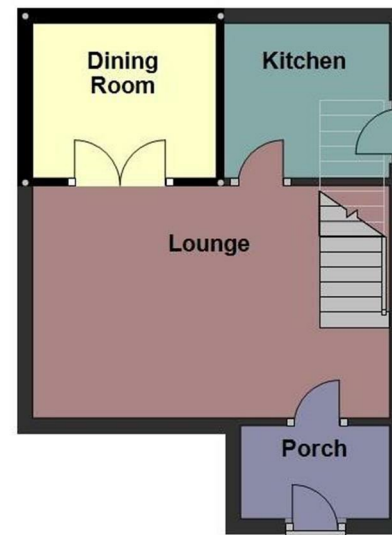

First Floor



*please be advised that the provided floor plans are not drawn to scale and should be used for guidance purposes only.

Available from 25th July 2026 is this well-presented three-bedroom semi-detached family home, situated in a popular residential area of Grimsby.

The property offers spacious and practical accommodation throughout. Upon entering, you are welcomed by an entrance porch leading into a generous lounge, creating a comfortable living space for relaxing or entertaining. The home also benefits from a separate dining room, perfect for family meals or those who enjoy entertaining, alongside a fitted kitchen with access to the rear garden.

Upstairs, the property comprises three well-proportioned bedrooms, a family bathroom, and the added convenience of a separate WC, making busy mornings that little bit easier.

Outside, the property benefits from a small enclosed front garden with an entrance porch, providing an attractive approach to the home, as well as a private enclosed rear garden, ideal for enjoying the warmer months. On-street parking is available nearby.

Further benefits include:



Mayfair Estate Agents Powered by Open House



Energy Efficiency Rating		
	Current	Potential
Very energy efficient - lower running costs		
(92 plus) A		
(81-91) B		85
(69-80) C	71	
(55-68) D		
(39-54) E		
(21-38) F		
(1-20) G		
Not energy efficient - higher running costs		
England & Wales	EU Directive 2002/91/EC	