



JASON SIMMONS POWERED BY **exp**™ **UK**

@ jason.simmons@exp.uk.com

jasonsimmons.exp.uk.com

☎ 01477 500 303

Blackcroft Close, Shavington

£350,000

🛏️ 4 🚿 2 🚗 2

- Large & Modern four bedroom detached home
- Separate study / play room
- Master bedroom with En-suite shower room
- Modern family bathroom
- Enclosed & well maintained rear garden (ideal for Summer)
- Large lounge with feature fireplace and bay window
- Modern fitted dining kitchen with doors to rear garden
- Two further double bedrooms & a single bedroom
- Driveway parking for two/three vehicles & Garage
- Quote Ref: JS0070



Quote Ref: JS0070. A large modern four-bedroom detached home, situated in the desirable area of Shavington, offering spacious and flexible living. The ground floor has an inviting entrance hallway, leading to a generous lounge featuring a fireplace and bay window. The heart of the home is the modern fitted dining kitchen, which boasts ample space for entertaining and includes convenient doors opening to the rear garden, perfect for summer gatherings. Additionally, a separate study/play room provides versatile space for home working or recreation, and a downstairs toilet. Upstairs the master bedroom has its own En-suite shower room. Two further well-proportioned double bedrooms and a single bedroom provide flexible accommodation, all served by the family bathroom. Externally, the property benefits from driveway parking and a single garage. The enclosed and beautifully maintained rear garden is an ideal outdoor space, offering a perfect setting for relaxation.



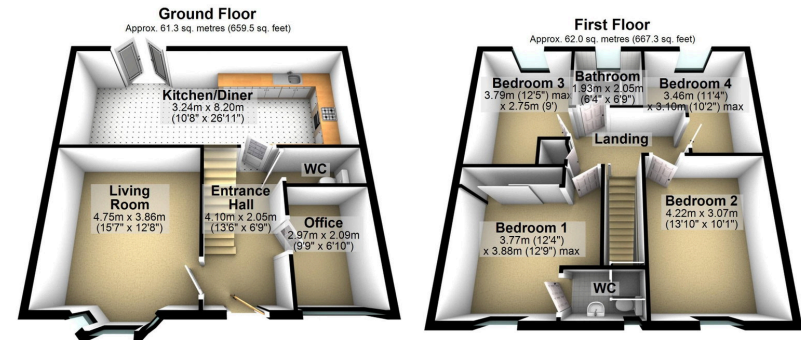

Total area: approx. 123.3 sq. metres (1326.8 sq. feet)

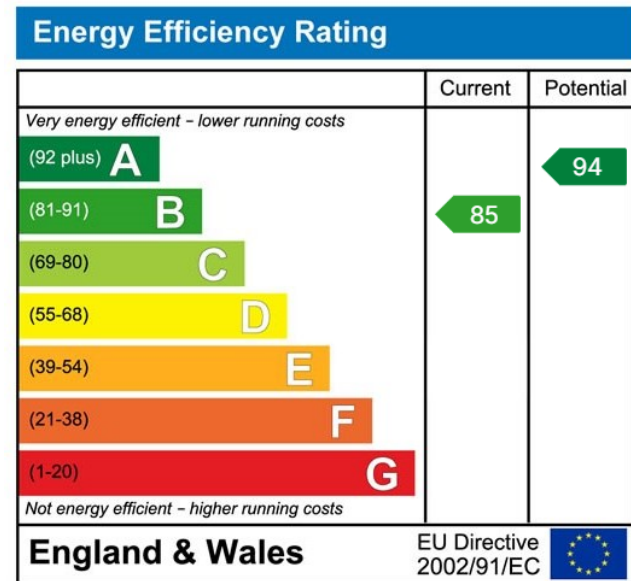

eXp World UK Ltd is a registered company at Level 37, 25 Canada Square, London, E14 5LQ.
 Registered company number is 12016573. VAT Registration Number is 327 4120 29