



# Clifton Court

## Northwick Terrace, NW8

£3,500 per month  
(£807.69 per week)

A spacious two bedroom apartment set on the first floor of a well maintained portered block, within close proximity to the amenities of Little Venice and St John's Wood.



# Clifton Court

## Northwick Terrace, NW8

- First Floor Apartment
- Two Bedrooms, Two Bathrooms
- Modern, Wood Floors, Communal Garden
- Close to Little Venice



A spacious two bedroom apartment set on the first floor of a well maintained portered block, within close proximity to the amenities of Little Venice and St John's Wood.

The property comprises two double bedrooms, two bathrooms, large reception room and fitted kitchen.

It further benefits from being fully furnished and residents have access to a communal garden.

**Minimum Term:** 12 months  
**Deposit Required:** £4,038.46  
**Local Authority:** City Of Westminster  
**Council Tax Band:** F  
**EPC Rating:** D  
**Furnished**

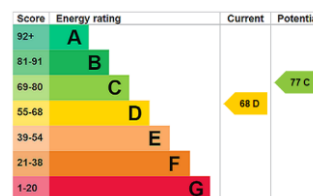

### *Chestertons St John's Wood Lettings*

105 St. John's Wood Terrace  
 London  
 NW8 6PL  
 stjohnslettingsusers@chestertons.co.uk  
 02030408622  
 chestertons.co.uk

Additional tenant charges apply (fees apply to non-AST tenancies only)  
 Tenancy Agreement Fee: £300  
 References per Tenant/Guarantor: £60  
 Inventory check (approx. £100 – £250 inc. VAT)  
 chestertons.co.uk/property-to-rent/applicable-fees



# Clifton Court, NW8 8HX

Approx Gross Internal Area = 90.4 sq m / 973 sq ft

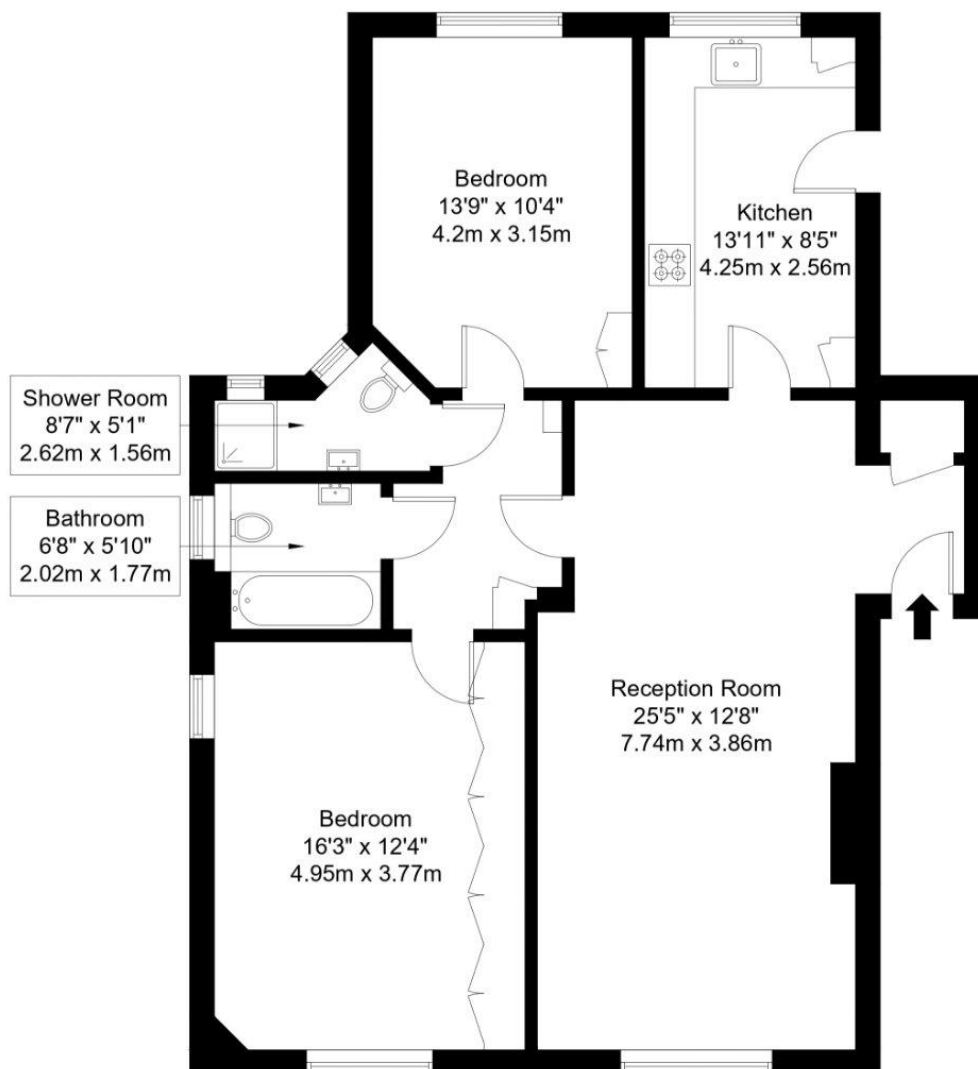
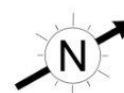

First Floor

Ref :

Copyright

**B L E U  
P L A N**

The Floor plan is not to scale and measurements and areas shown are approximate and therefore should be used for illustrative purposes only. The plan has been prepared in accordance with the RICS code of Measuring Practice and whilst we have confidence in the information produced it must not be relied on. Maximum lengths and widths are represented on the floor plan. If there is any aspect of particular importance, you should carry out or commission your own inspection of the property.  
Copyright @ BleuPlan

