



139, Woodside Lane, Bexley DA5 1EY
Asking Price £275,000



Chain free. Well presented and generously proportioned, this two double bedroom ground-floor maisonette offers an inviting blend of space, comfort, and convenience. Enjoying its own private south-facing garden, the property makes an excellent first-time purchase or buy-to-let investment. The accommodation includes an entrance hall, a modern shower room, two well-sized double bedrooms, a bright reception room and a fitted kitchen. Additional features include double glazing, and gas central heating. The location is ideal for everyday living, with popular local amenities close by, including Blendon Parade, Danson Park, and a choice of transport links. Early viewing is strongly recommended.

Local Authority: London Borough of Bexley
Council Tax Band: C



01322 553322

60-62 High Street, Bexley, Kent DA5 1AH

bexley@parkestates.co.uk
www.parkestates.co.uk

Energy Efficiency Rating		Current	Potential
Very energy efficient - lower running costs			
(92 plus) A			
(81-91) B			
(69-80) C			
(55-68) D		69	78
(39-54) E			
(21-38) F			
(1-20) G			
Not energy efficient - higher running costs			
England & Wales		EU Directive 2002/91/EC	

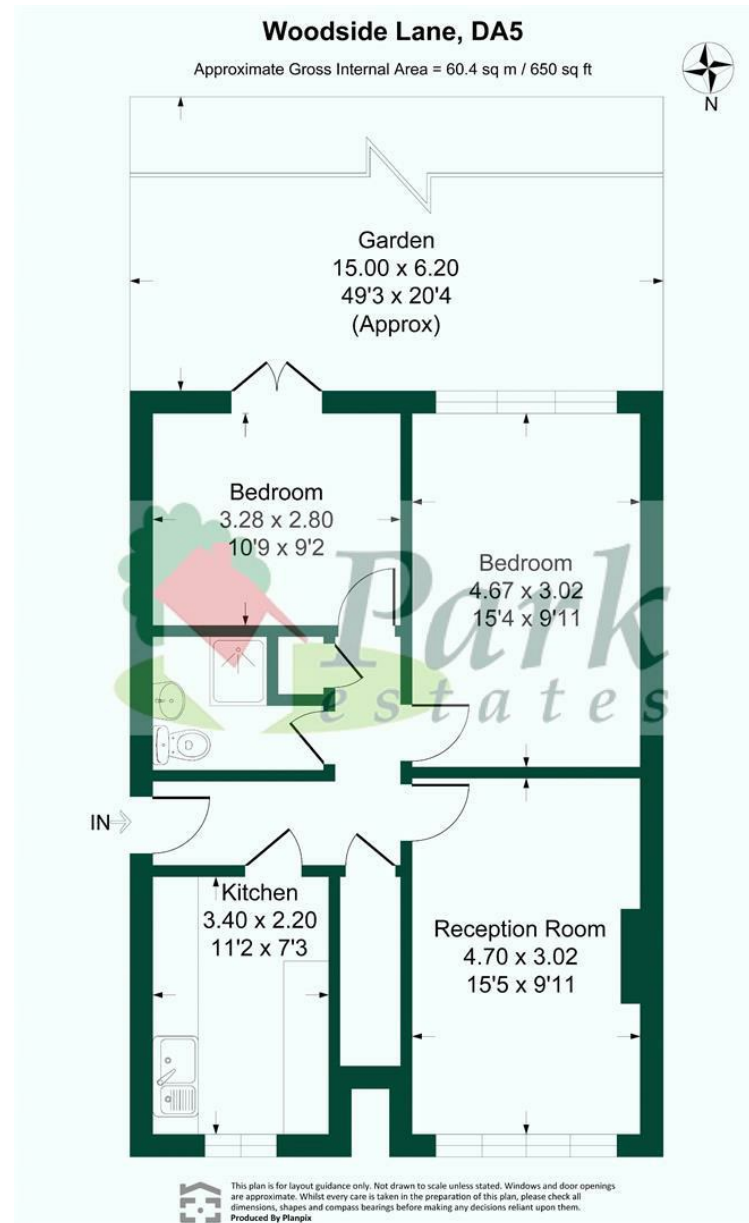

Every care has been taken with the preparation of details, but accuracy is in no way guaranteed. These particulars do not constitute a contract and are issued and accepted on the express understanding that all negotiations will be conducted through Park Estates. The seller does not make or give, nor do we or our employees have any authority to give a representation or warranty in relation to the property. Please contact this office before viewing the property. If there is any point which is of particular importance to you, we will be pleased to check the information for you and confirm that the property remains available. This is particularly important if you are contemplating travelling some distance to view the property. We would strongly recommend that all the information that we provide about the property is verified by yourself on inspection and also by your conveyancer, especially where statements have been made by us to the effect that the information provided by us has not been verified.