

Stokesway, Stoke Road,
Gosport, Hampshire, PO12 1PE

£99,995



First Floor Flat

Spacious Lounge

Bathroom With White Suite

Conveniently Located For Shops & Bus
Services

One Bedroom

Kitchen

PVCu Double Glazing

No Forward Chain

023 9258 5588

6 Stokesway, Stoke Road, Gosport, Hants, PO12 1PE

Email: office@dimon-estate-agents.co.uk

To view all our properties visit:

www.GosportProperty.com

First Floor Flat

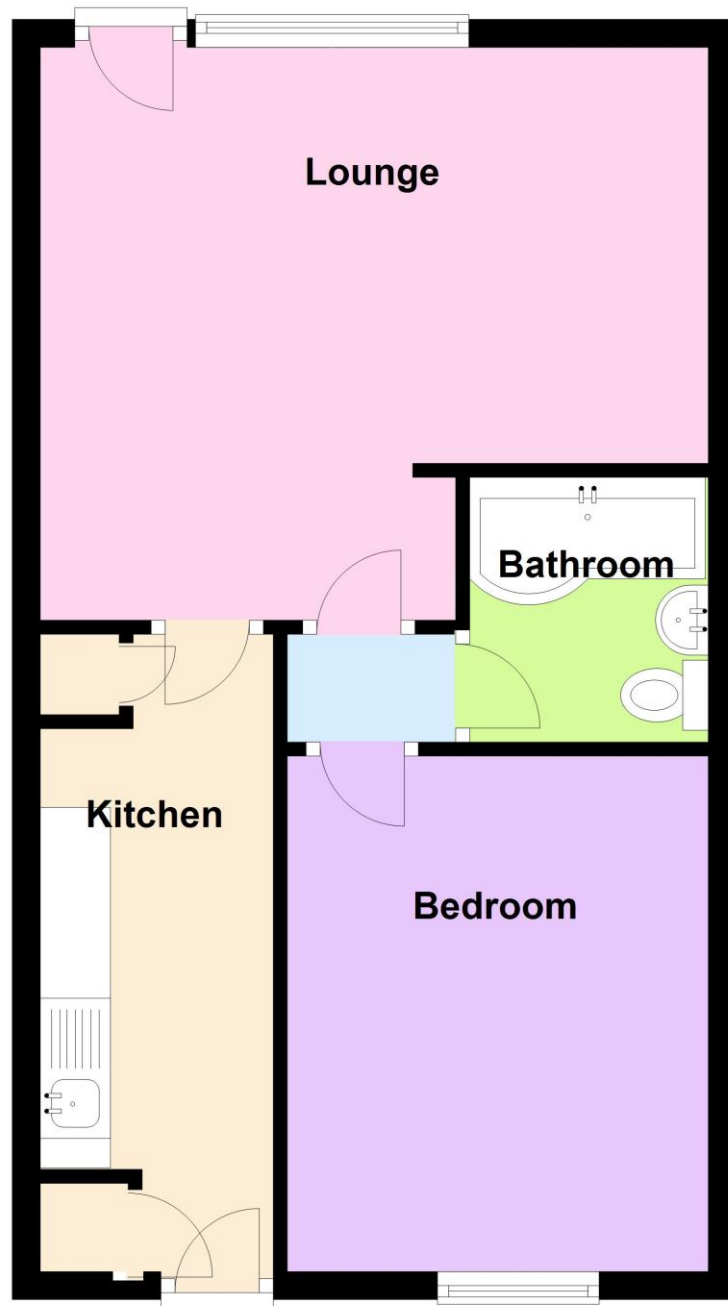

SELLING YOUR OWN PROPERTY IN GOSPORT?
WE ARE A FAMILY RUN BUSINESS SELLING HOMES IN GOSPORT FOR 55 YEARS
AND WOULD WELCOME THE OPPORTUNITY TO BE CHOSEN AS YOUR ESTATE AGENT

Lounge

15'7" (4.75m) x 13'6" (4.11m) narrowing to 9'9" (2.97m), PVCu double glazed front door and window, electric panel heater, coved ceiling.

Kitchen

14'10" (4.52m) x 5'5" (1.65m) Single drainer stainless steel sink unit, white fronted wall and base units with worksurface over, electric cooker point, plumbing for washing machine, larder cupboard, tiled splashbacks, PVCu double glazed door to rear walkway, airing cupboard.

Inner Lobby

Bathroom

White suite of panelled bat with mix tap and shower attachment, pedestal hand basin, low level WC. tiled splashbacks, extractor fan.

Bedroom

12'0" (3.66m) x 9'9" (2.97m) PVCu double glazed window, electric heater.

Services

We understand that this property is connected to mains gas, electric, water and sewage.

Tenure

Leasehold. Balance of a 125 year lease from 15th February 2019. Current ground rent £250 per year and maintenance charges as and when required, split with other flats.

These details are provided to the best of our ability from the information provided to us by the owner, but a buyer should check the figures once the official leasehold enquiries from the management company/freeholder are received by their legal advisor as they can be subject to change. This should be done before exchanging contracts to purchase the property.

Council Tax

Band A.

Property Information

For information on broadband speed and mobile phone coverage for this property visit: <https://checker.ofcom.org.uk>
For flood risk information visit: <https://www.gov.uk/check-long-term-flood-risk>

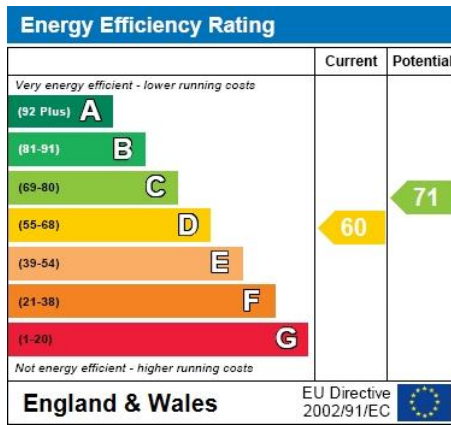

Full Energy Performance Certificate
available upon request

Appointment		
Date:	Time:	Person Meeting:
Viewing Notes		

These particulars, whilst believed to be accurate, are set out as a general outline for guidance and do not constitute any part of an offer or contract. Please note we have not tested any apparatus, fixtures, fittings, or services. Interested parties must undertake their own investigation into the working order of these items. All measurements are approximate. Floor Plans are obtained from a third party and may contain inaccuracies. Photographs are for guidance only and may change over the course of marketing. Information provided on lease terms, maintenance and ground rent have been provided by the vendor and you should ask your legal representative to confirm this information before exchanging contracts.