



## Honor Oak Park, SE23

£450,000

A beautifully presented two bedroom, ground floor end of terrace flat featuring a spacious kitchen/diner and private south facing garden with side access. Benefiting from a share of freehold, the property is perfectly positioned in a desirable location with easy access to nearby stations, local shops, cafés, and green spaces, making it an ideal home for both convenience and lifestyle.

Ideally located in the heart of Honor Oak Park, the property is moments from Honor Oak Park Station, offering Overground and mainline services to London Bridge, Canada Water, and beyond. It is also close to Crofton Park Station, providing convenient Thameslink services to Blackfriars, Farringdon, and London St Pancras. Residents enjoy easy access to green spaces including One Tree Hill, Peckham Rye Park, and Blythe Hill Fields. The nearby high street offers a great mix of independent cafés, restaurants, and shops, creating a vibrant village feel.

### Features

- Ground Floor
- Two Bedrooms
- Large Kitchen/Diner
- South Facing Garden
- Share Of Freehold
- Close To Stations

# Honor Oak Park, London, SE23

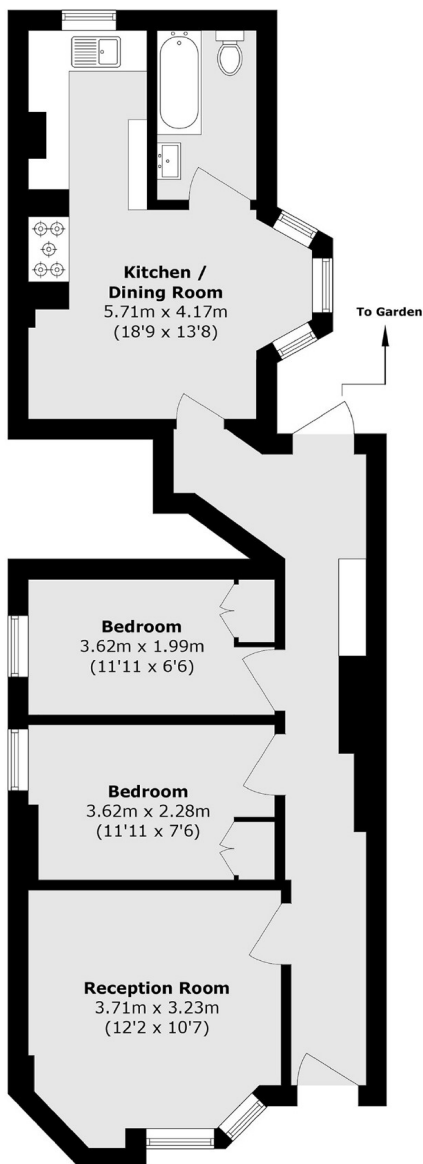

Total area (approx.): 63.4 sq. m (682.4 sq. ft)