

Rosedale Bush End

Takeley, Bishop's Stortford

A superbly spacious four bedroom family home nestled in the much-loved village of Takeley. Stacked with features to love including three en-suites, a primary bedroom of dreams with walk-in wardrobe and feature roll top tub, plus a cinema room and spacious garden room with ensuite shower - there's so much on offer here. Welcome to Rosedale.

Council Tax band: TBD

Tenure: Freehold

- Four bedroom family home
- Driveway
- Three Ensuites
- Open Plan Kitchen / Family Room
- Garden Room / Gym with Shower Room
- Cinema Room
- Utility Room
- Walk-in Wardrobe



Entrance Hallway

Shower Room

Kitchen / Lounge / Diner

27' 7" x 18' 5" (8.42m x 5.62m)

Utility Room

9' 6" x 10' 0" (2.89m x 3.05m)

Cinema Room

13' 10" x 10' 0" (4.22m x 3.05m)

Sitting Room

13' 1" x 11' 6" (4.00m x 3.51m)

Bedroom

9' 8" x 15' 7" (2.95m x 4.75m)

Ensuite Bathroom

Primary Bedroom

13' 5" x 28' 9" (4.10m x 8.77m)

Walk in wardrobe

Ensuite Shower Room

Bedroom

13' 8" x 12' 2" (4.17m x 3.72m)

Ensuite Shower Room

Bedroom

6' 6" x 14' 6" (1.97m x 4.41m)

Garden Room/ Gym with Shower Room

17' 3" x 10' 8" (5.25m x 3.26m)

Measurement excluding shower room

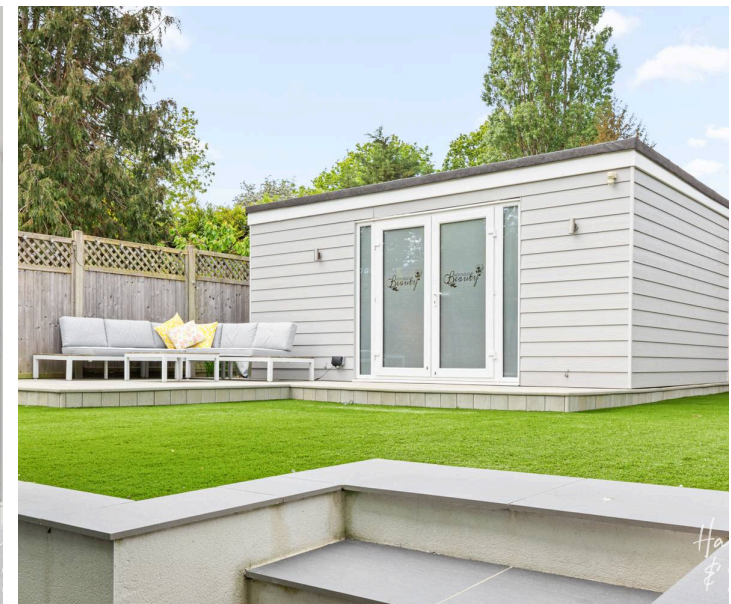





Ground Floor



First Floor

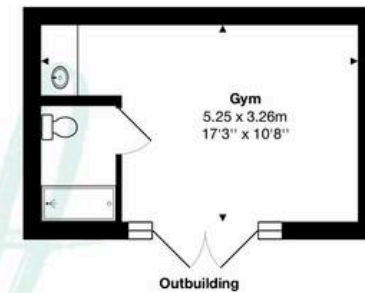

Total Area: approx. 224.0 m² ... 2411 ft²

THE FLOORPLAN IS FOR ILLUSTRATIVE PURPOSES ONLY AND IS NOT TO SCALE.
Measurements and features are approximate and may differ from the actual property. Verify all details independently; no liability is accepted for errors or omissions.

Property marketing provided by www.fotomarketing.co.uk